



Beheersplan voor het erfgoed van
de beschermde huizen van de tuinvijken

LE LOGIS - FLOREAL

te Watermaal-Bosvoorde
uitgave: 1 september 2014



T00	T01	T02	T03	T04	T05	T06
P01	P02	P03	P04	P10	P20	

P01 - CATALOGUS
VAN HET KLEIN PATRIMONIUM



Beheersplan voor het erfgoed van
de beschermde huizen van de tuinvijken

LE LOGIS - FLOREAL

P01 - CATALOGUS VAN HET KLEIN PATRIMONIUM

uitgave: 1 september 2014

Gewestelijke Overheidsdienst Brussel
Brussels Stedelijke Ontwikkeling
Directie Monumenten en Landschappen

Opgemaakt voor GOB door
ARSIS, architectenvennootschap bvba

Verantwoordelijke uitgever
Arlette Verkruyssen, Directeur-generaal
van Brussel Stedelijke Ontwikkeling,
Brussels Hoofdstedelijk Gewest,
CCN- Vooruitgangsstraat 80, 1035 Brussel

Wettelijk Depot D/2014/6860/025

INHOUDSTAFEL

1	HANDLEIDING BIJ DE CATALOGUS	2
1.1	Algemeen	2
1.2	Verwijzing naar de details in het boek met constructiedetails (ref.P02) en naar de lastenboekteksten (ref.T02).	2
1.3	Verenigbaarheden tussen constructiedetails en voorkeuren.	2
1.4	De globale maten van de elementen en de verhouding $\sqrt{2}/2$.	3
1.5	Benoeming van de modellen in de catalogus	3
1.6	Beperkingen eigen aan deze editie van de catalogus.	4
1.7	De kleurenvermeldingen.	5
2	DE RAMEN - "GROENE" HUIZEN (LE LOGIS)	
3	DE RAMEN - "GELE" HUIZEN (FLOREAL)	
4	DE RAMEN - "WITTE" HUIZEN (LE LOGIS)	
5	DE DAKKAPellen - "GROENE" HUIZEN (LE LOGIS)	
6	DE DAKKAPellen - "GELE" HUIZEN (FLOREAL)	
7	DE DAKKAPellen - "WITTE" HUIZEN (LE LOGIS)	
8	DE KLAPLUIKEN	
9	DE VOORDEUREN	
10	DE TUINPOORTJES	
11	DE LUIFELS	
12	DE GARAGEPOORTEN	
13	DE SCHOUWEN	
14	AFSLUITING PORTALEN TYPE 1 - "GROENE HUIZEN" (LE LOGIS)	
15	AFSLUITING PORTALEN TYPE 1 - "GELE HUIZEN" (FLOREAL)	

1 HANDLEIDING BIJ DE CATALOGUS

1.1 Algemeen

Dit boek geeft een overzicht van de volgende thema's van het "klein patrimonium":

- § ramen,
- § dakkapellen,
- § voordeuren,
- § tuinpoortjes,
- § luiken,
- § luifels
- § garagepoorten
- § schouwen
- § portaalafsluitingen

Voor elk thema worden de oorspronkelijke modellen weergegeven met vermelding van de oorspronkelijke kleurverdeling, en daarbij wordt er een onderscheid gemaakt tussen de zogenaamde groene (Le Logis), gele (Floréal) en witte (Le Logis) huizen. Modellen die vandaag bestaan, en in deze catalogus niet voorkomen zijn in principe niet oorspronkelijk. Eén belangrijke uitzondering is de schouwkop E, die niet oorspronkelijk is en toch in de catalogus staat afgebeeld. Deze komt vandaag zeer veel voor in Floréal, maar is eigenlijk een verbouwing van een oorspronkelijke schouwkop B.

Het belang van deze catalogus is enerzijds de verschillende modellen weer te geven en te benoemen, en anderzijds de uitvoeringsdetails in de A3-map te kunnen situeren.

1.2 Verwijzing naar de details in het boek met constructiedetails (ref.P02) en naar de lastenboekteksten (ref.T02).

In de catalogus geschiedt de verwijzing naar de detailtekeningen in de A3-map aan de hand van de codes in de tabel, vermeld naast elk model in deze catalogus. De tabel maakt de verbinding tussen twee soorten codes:

- § **H11, V3a, ... : lokalisatiecode.** Deze code lokaliseert het detail of de snede op het model in de catalogus. In deze codering staat **H** voor een horizontale snede, en **V** voor een verticale snede. Deze lokalisatiecode geldt alleen voor de lokale tekening in de catalogus.
- § **D.23.01, D.21.01, ... : detailreferentie.** Naast elke lokalisatiecode staat een detailreferentie. Deze code duidt op het referentienummer van de detailtekening in de A3-map. De karakters in deze referentiecode zijn niet willekeurig; de drie eerste tekens van deze referentie geven aan onder welk nummer in het lastenboek, beschrijvingen bestaan. Bv.: D.23 verwijst naar post D.2.3 in het lastenboek, eventueel aan te vullen met algemene voorschriften van post D, D0 of D1.

1.3 Verenigbaarheden tussen constructiedetails en voorkeuren.

De verenigbaarheden tussen constructiedetails worden aangegeven door middel van **detailextensies (#.##.##/n)**. Deze extensie /n komt voor in de benamingen van de detailtekeningen in het detailboek (ref. P02). Extensies worden gebruikt als er verschillende technische varianten voorkomen voor eenzelfde model van ramen, dakkapellen,

Bijvoorbeeld: ramen met een extensie /1 hebben een afgeronde druiprand, en ramen met een extensie /2 een rechte druiprand. Beiden hebben opengaande vleugels van 35 mm dik.

Een extensie /3 duidt op ramen met rechte druipranden waarbij de opengaande vleugels 40 mm dik zijn.

De betekenis van de extensie is al opgenomen in de details, en het is voor de gebruiker van deze documenten niet nodig om de precieze betekenissen van de extensies te kennen. Belangrijk is dat men bij het combineren van de details steeds dezelfde extensie aanhoudt. Bijvoorbeeld: een verticale doorsnede met /1-extensie moet gecombineerd worden met een horizontale doorsnede met een /1-extensie. Als detailreferenties geen extensie hebben, dan zijn ze universeel, en mogen ze met alle extensies worden gecombineerd.

Meestal worden de extensies niet vermeld in de catalogus (ref.P01), omdat eenzelfde model, in verschillende technische varianten bestaat heeft. Bijvoorbeeld: een raam van het type B, werd gemaakt gedurende de volledige bouw van de tuinwijk, en is onderhevig geweest aan technische varianten (afhankelijk van de leverancier) en evoluties (het dikker maken van de opengaande vleugels).

Ingeval elementen worden vervangen, schrijft het lastenboek het gebruik van een bepaalde extensie voor, ongeacht de bestaande situatie. Deze voorkeur wordt telkens verklaard in de betrokken lastenboekartikels.

1.4 De globale maten van de elementen en de verhouding $\sqrt{2}/2$.

Bij de modellen in de catalogus staan soms globale maten aangegeven, en soms niet. Voor de huizen met ramen met kruishouten, zijn de globale maten van elementen zoals ramen, luiken, dakkapellen, ..., terug te brengen naar het gevolg van het samenstellen van details, rond vaste afmetingen van de glasoppervakken. De afmeting van de dagopening tussen de kruishouten is steeds 24,5 cm. x 35 cm, en beantwoordt aan de verhouding ($\sqrt{2}/2$). De globale maten die in de catalogus staan aangegeven zijn in elk geval benaderingen met een tolerantie van 1 cm. Deze tolerantie is het gevolg van varianten die bestaan in de detaillering.

1.5 Benoeming van de modellen in de catalogus

In de catalogus staat bij elk model een code in het vet onder de vorm van bv. <A2b>. Deze **modelcode** slaat op de vorm, niet op de kleur, en geldt binnen eenzelfde thema (deuren ramen, luiken, ...). Er bestaan dus deuren onder code A, zowel als ramen of dakkapellen, enz. Wanneer men spreekt over een <deur A1> dan is daarmee het onderwerp éénduidig bepaald, met uitzondering van de kleur.

De samenstellende delen van de codes hebben een betekenis, die zoveel mogelijk voortbouwt op de codering en typering die arch. J.J.Eggericx oorspronkelijk heeft gebruikt. Hij heeft op de oorspronkelijke plannen het klein patrimonium benoemd aan de hand van letter- en cijfercodes. Het verband met de codes in deze catalogus is de volgende:

- 1) Voor de ramen is J.J. Eggericx het verst gegaan in de codering:
 - a) Alle lettercodes die J.J.Eggericx heeft gebruikt werden overgenomen. De vorm van de oorspronkelijke code is een hoofdletter met soms daaraan toegevoegd een cijfer: A of A1. Sommige modellen werden door J.J. Eggericx niet benoemd met een code; voor deze werden nieuwe lettercodes toegevoegd. Er is echter nooit dubbelgebruik met de oorspronkelijke codes.
 - b) Aan de basiscodes, die de vorm hebben zoals hierboven beschreven, werden kleine letters toegevoegd, zodat bv. de volgende vorm ontstaat: Aa, A1a, Deze bijgevoegde codes duiden op een differentiatie van het model A, A1, De verschillen situeren zich meestal in de wijze van opengaan van de ramen.
 - c) Er komt ook nog een **<bis>**-code voor. Deze code betekent dat een dakkapel met sidings is bekleed, en geen vakwerk heeft. Bij de aanvang van de bouw van de

tuinwijk, werden alle dakkapellen met vakwerk uitgevoerd. Maar later werden dezelfde modellen in een sidings-variante uitgevoerd.

d) De architecten Moenaert en François hebben voor een deel gebruik gemaakt van de "standaard"-modellen die arch. Eggericx voor Le Logis en Floréal had ontwikkeld. Er komen bij hen echter zeer veel uitzonderingen voor, zoals andere combinaties, afwijkingen op de module van de glasvakjes ($\sqrt{2}/2$), andere profielen omwille van bijzondere aansluitingen en verbindingen, enz... . Daarom werd ervoor gezorgd dat de elementen die uitsluitend voorkomen bij Moenaert en François, erkenbaar zijn aan de modelcode. Een **Mo**-code is een Moenaert-model. Een **Fr**-code is een François-model.

e) De toevoeging **(+40)** aan de modelcode in het deel over de ramen van de "witte" huizen duidt op een technische variant die in de witte huizen na 1940 werd toegepast. Het zichtbare verschil met de variant van vòòr 1940 (zonder deze toevoeging) is gering, maar de technische kwaliteit is beter.

2) Voor de deuren, dakkapellen, luiken is de vermelding op de oorspronkelijke plannen van de ontwerpers zeer beperkt. De modellen van deuren en luiken die zijn getekend op de oorspronkelijke plannen zijn blijkbaar slechts symbolisch en weinig gedifferentieerd. De werkelijkheid is veel rijker dan de oorspronkelijke codering. Voor de dakkapellen is de oorspronkelijke codering rijker dan voor de deuren, maar soms dragen twee verschillende dakkapellen dezelfde code. Dakkapellen werden gebouwd rond bepaalde raamtypes¹, in typesituaties (dakkapelvormen). Vanwege de grote variabiliteit die dat opleverde is blijkbaar de discipline verwaterd om een strakke codering te handhaven. Dat begon na een zekere tijd, wanneer de combinaties als maar ingewikkelder werden. Voor de deuren, dakkapellen en luiken werd de codering van J.J. Eggericx slechts overgenomen in de beperkte mate waarin deze codering samenhangend is gebleven. De meest codes zijn dus nieuw.

Om de reconstructie van de dakkapellen te vergemakkelijken zijn in deze catalogus bij de verschillende dakkapellen de modelcodes van de betrokken ramen vermeld, die oorspronkelijk als basis dienden voor de opbouw van de dakkapellen.

1.6 Beperkingen eigen aan deze editie van de catalogus.

Deze catalogus werd opgemaakt aan de hand van vaststellingen in situ en historische documenten. Het is echter niet zeker dat alle oorspronkelijke modellen die nog bestaan of bestaan hebben, in deze catalogus voorkomen. Bij het raadplegen van deze catalogus moet men met de volgende beperkingen rekening houden:

- Voor elk model met hetzelfde uitzicht, zijn verschillende wijzen van opengaan mogelijk. Aan een gesloten raam kan men vaak niet zien hoe het opengaat en of het opengaat. Voor vaste vleugels werden meestal dezelfde profielen gebruikt als voor opengaande vleugels. Alle mogelijke verschillende combinaties van opengaan voor dezelfde vleugels, zijn niet opgenomen in deze catalogus, omdat deze combinaties niet werden gevonden in de bestaande toestand. De details in het A3-boek laten echter wel toe om andere combinaties samen te stellen.
- § Niet alle modellen van deuren, luiken, dakkapellen, garagedeuren, ..., beschikken over verwijzingen naar details, omdat deze details nog niet zijn gesynthetiseerd tot een "nominaal" of conventioneel detail, dat "een goed en kwalitatief gemiddelde is van alle gelijkaardige details". Dat neemt niet weg dat bv. de verbeteringen die reeds voor enkele deuren zijn voorgesteld in de A3-map met details, ook geschikt zijn voor ALLE andere types van voordeuren.

¹ De gevelmuren zijn ook rond de ramen opgetrokken.

1.7**De kleurenvermeldingen.**

De kleurenonderzoeken die op verschillende ramen en deuren werden uitgevoerd, met als doel de oorspronkelijke gele en groene kleur te bepalen, hebben niet altijd dezelfde conclusies opgeleverd. Geel heeft een sterke neiging om te verbleken onder invloed van het licht. Geel wordt bleker, en groen wordt blauwer.

De NCS-kleurencodes die in deze catalogus staan vermeld als richtlijn bij de restauratie, houden daar rekening mee, en zijn zeer waarschijnlijk de oorspronkelijke kleuren, zoals ze er aanvankelijk hebben uitgezien.

LE LOGIS - FLOREAL

LES CHASSIS
MAISONS "VERTES"
(LE LOGIS)

*DE RAMEN
"GROENE" HUIZEN
(LE LOGIS)*

P01-02



t: 02 410 84 39
f: 02 410 34 31
e: arsis@arsis.be

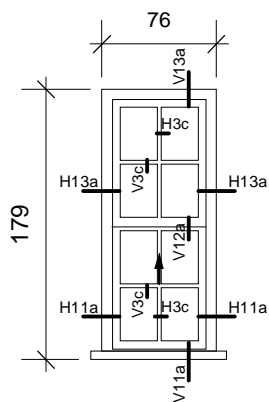

A1

detail ref.doc.

H11a	D.23.01
H13a	D.23.03
V11a	D.23.05
V12a	D.23.06
V13a	D.23.07
H3c	D.21.03
V3c	D.21.03

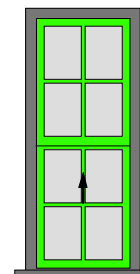

A1

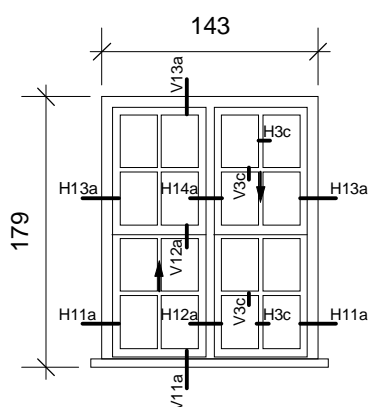

A2a

detail ref.doc.

H11a	D.23.01
H12a	D.23.02
H13a	D.23.03
H14a	D.23.04
V11a	D.23.05
V12a	D.23.06
V13a	D.23.07
H3c	D.21.03
V3c	D.21.03

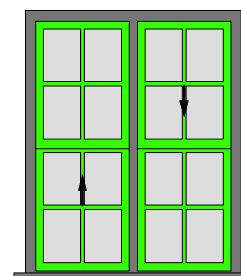

A2a

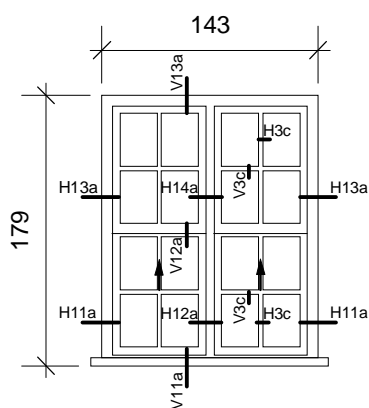

A2b

detail ref.doc.

H11a	D.23.01
H12a	D.23.02
H13a	D.23.03
H14a	D.23.04
V11a	D.23.05
V12a	D.23.06
V13a	D.23.07
H3c	D.21.03
V3c	D.21.03

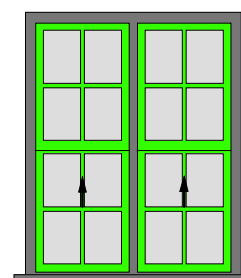

A2b

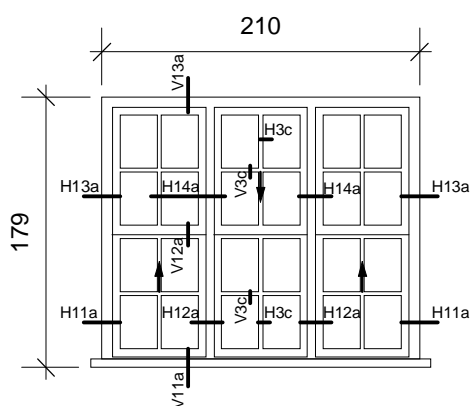

A3a

detail ref.doc.

H11a	D.23.01
H12a	D.23.02
H13a	D.23.03
H14a	D.23.04
V11a	D.23.05
V12a	D.23.06
V13a	D.23.07
H3c	D.21.03
V3c	D.21.03

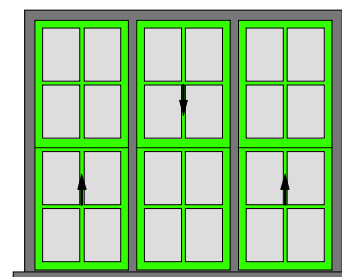

A3a

■ Noir - zwart
■ Verre - Glas

■ NCS 4060-G2OY: vert - groen

Dimension réelle du jour vitré: 24,5 x 35 cm
netto glasopeningen: 24,5 x 35 cm



t: 02 410 84 39
f: 02 410 34 31
e: arsis@arsis.be

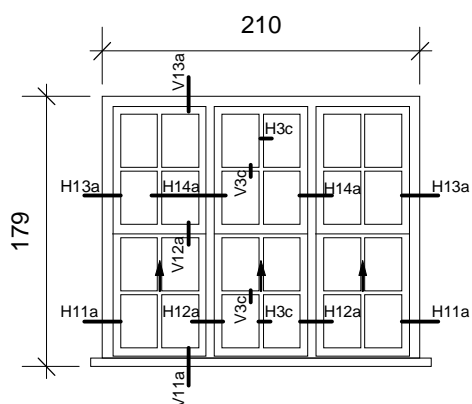

A3b

detail ref.doc.

H11a	D.23.01
H12a	D.23.02
H13a	D.23.03
H14a	D.23.04
V11a	D.23.05
V12a	D.23.06
V13a	D.23.07
H3c	D.21.03
V3c	D.21.03

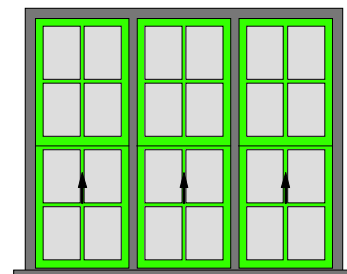

A3b

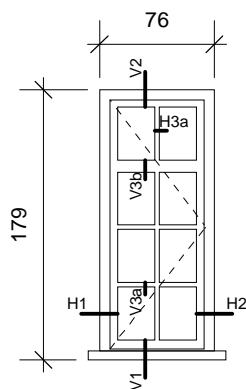

B1

detail ref.doc.

H1	D.24.01
H2	D.24.02
H3a	D.21.01
V1	D.24.07
V2	D.24.08
V3a	D.21.01
V3b	D.21.02

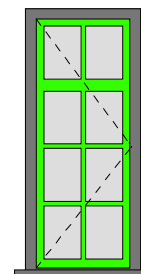

B1

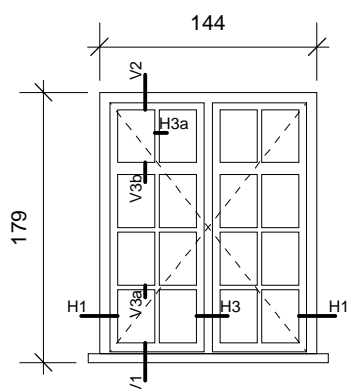

B2a

detail ref.doc.

H1	D.24.01
H3	D.24.03
H3a	D.21.01
V1	D.24.07
V2	D.24.08
V3b	D.21.02
V3a	D.21.01

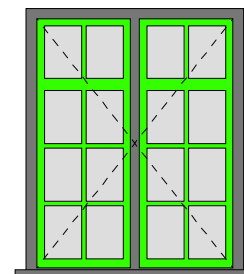

B2a

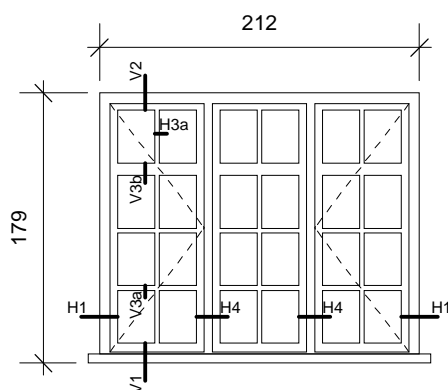

B3a

detail ref.doc.

H1	D.24.01
H3a	D.21.01
H4	D.24.05
V1	D.24.07
V2	D.24.07
V3a	D.21.01
V3b	D.21.02

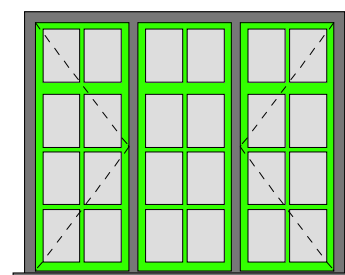

B3a

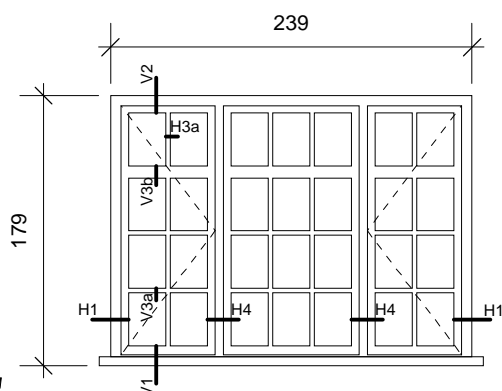

B3bis

detail ref.doc.

H1	D.24.01
H3a	D.21.01
H4	D.24.05
V1	D.24.07
V2	D.24.07
V3a	D.21.01
V3b	D.21.02

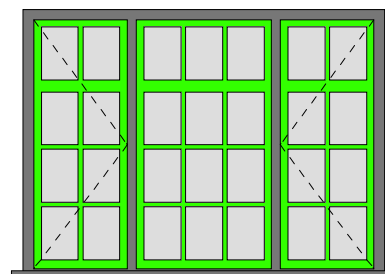

B3bis

C1

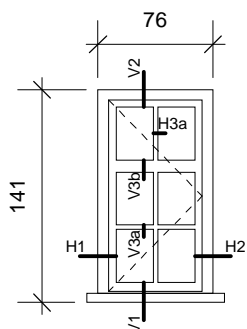

detail ref.doc.

H1	D.24.01
H2	D.24.02
H3a	D.21.01
V1	D.24.07
V2	D.24.08
V3a	D.21.01
V3b	D.21.02

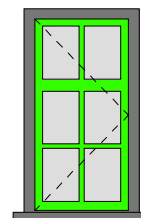

C1

C2a

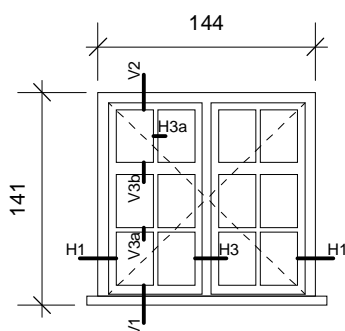

detail ref.doc.

H1	D.24.01
H3	D.24.03
H3a	D.21.01
V1	D.24.07
V2	D.24.08
V3b	D.21.02
V3a	D.21.01

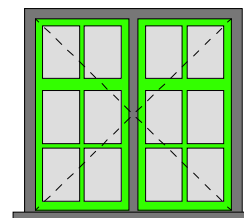

C2a

C2b

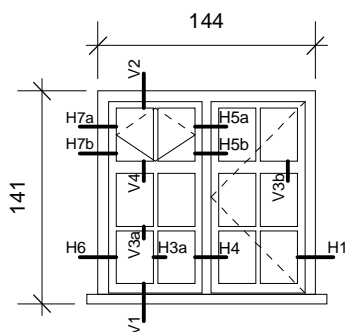

detail ref.doc.

H1	D.24.01
H3a	D.21.01
H4	D.24.05
H5a	D.25.01
H5b	D.25.02
H6	D.22.01
H7a	D.25.03
H7b	D.25.04
V1	D.24.07
V2	D.24.08
V3a	D.21.01
V3b	D.21.02
V4	D.25.05

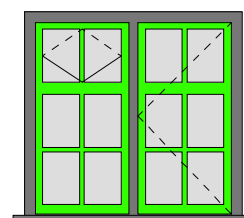

C2b

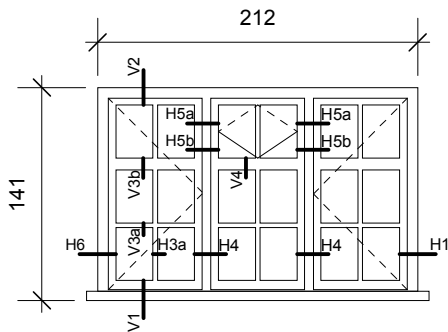

C3a

detail ref.doc.

H1	D.24.01
H3a	D.21.01
H4	D.24.05
H5a	D.25.01
H5b	D.25.02
V1	D.24.07
V2	D.24.08
V3a	D.21.01
V3b	D.21.02
V4	D.25.05

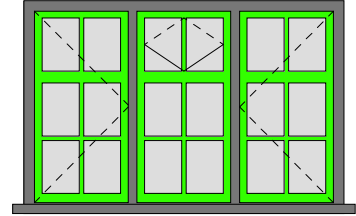

C3a

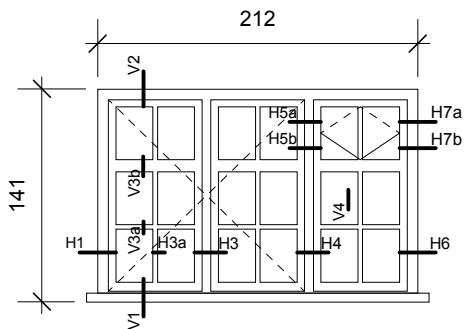

C3b

detail ref.doc.

H1	D.24.01
H3	D.24.03
H3a	D.21.01
H4	D.24.05
H5a	D.25.01
H5b	D.25.02
H6	D.22.01
H7a	D.25.03
H7b	D.25.04
V1	D.24.07
V2	D.24.08
V3a	D.21.01
V3b	D.21.02
V4	D.25.05

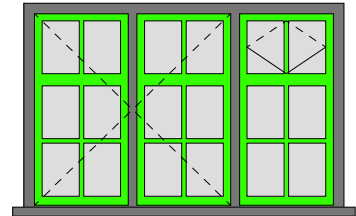

C3b



t: 02 410 84 39
f: 02 410 34 31
e: arsis@arsis.be

■ Noir - zwart
■ Verre - Glas

■ NCS 4060-G20Y: vert - groen

Dimension réelle du jour vitré: 24,5 x 35 cm
netto glasopeningen: 24,5 x 35 cm

D

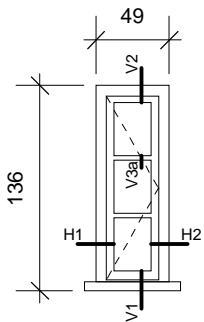

detail ref.doc.

H1	D.24.01
H2	D.24.02
V1	D.24.07
V2	D.24.08
V3a	D.21.01

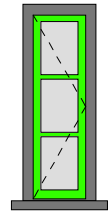

D

D1

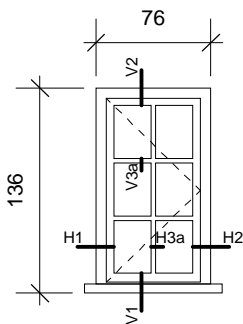

detail ref.doc.

H1	D.24.01
H2	D.24.02
H3a	D.21.01
V1	D.24.07
V2	D.24.08
V3a	D.21.01

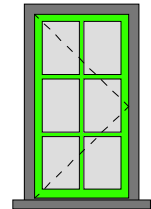

D1

D2

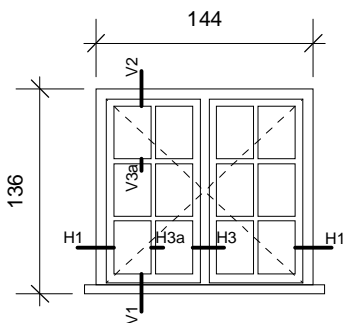

detail ref.doc.

H1	D.24.01
H3	D.24.03
H3a	D.21.01
V1	D.24.07
V2	D.24.08
V3a	D.21.01

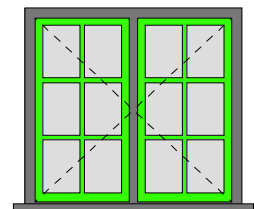

D2

D3a

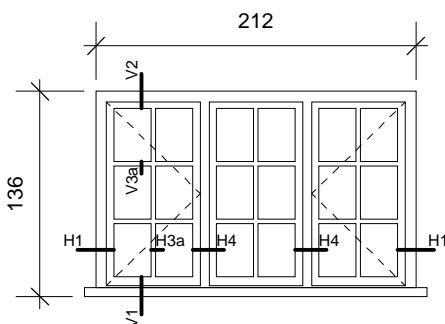

detail ref.doc.

H1	D.24.01
H4	D.24.05
H3a	D.21.01
V1	D.24.07
V2	D.24.08
V3a	D.21.01

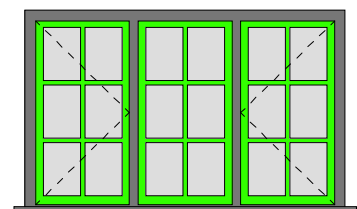

D3a

D3b

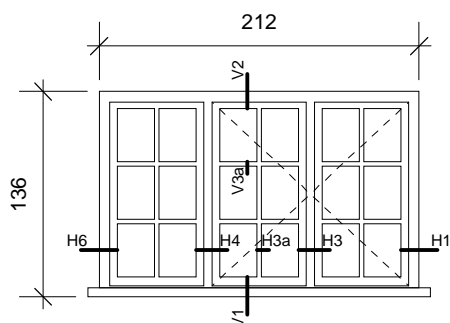

detail ref.doc.

H1	D.24.01
H3	D.24.03
H3a	D.21.01
H4	D.24.05
H6	D.22.01
V1	D.24.07
V2	D.24.08
V3a	D.21.01

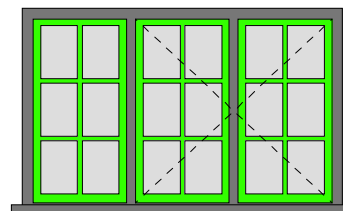

D3b

E

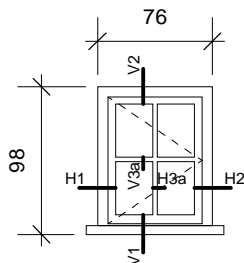

detail ref.doc.

H1	D.24.01
H2	D.24.02
H3a	D.21.01
V1	D.24.07
V2	D.24.08
V3a	D.21.01

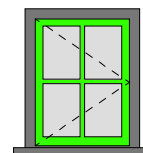

E

E1

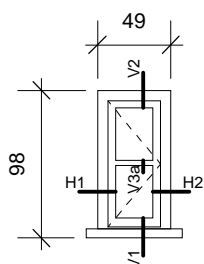

detail ref.doc.

H1	D.24.01
H2	D.24.02
V1	D.24.07
V2	D.24.08
V3a	D.21.01

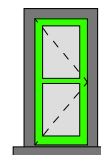

E1

E2

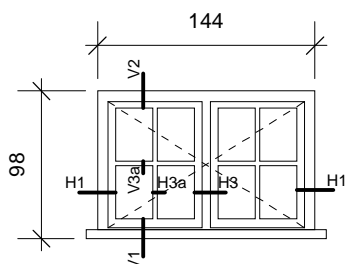

detail ref.doc.

H1	D.24.01
H3	D.24.03
H3a	D.21.01
V1	D.24.07
V2	D.24.08
V3a	D.21.01

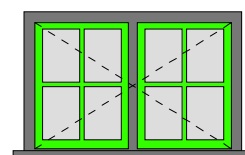

E2

E3

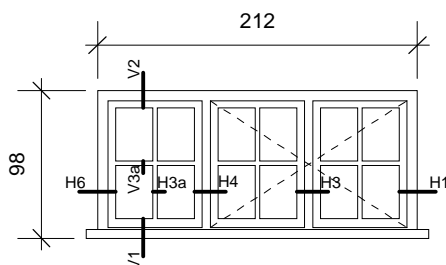

detail ref.doc.

H1	D.24.01
H3	D.24.03
H3a	D.21.01
H4	D.24.05
H6	D.22.01
V1	D.24.07
V2	D.24.08
V3a	D.21.01

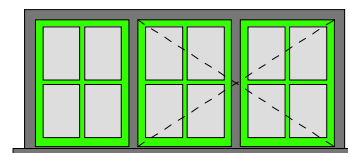

E3

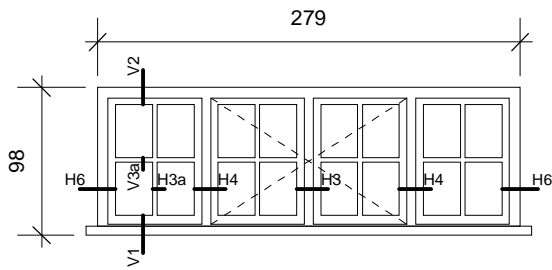

E4

detail	ref.doc.
H3	D.24.03
H3a	D.21.01
H4	D.24.05
H6	D.22.01
V1	D.24.07
V2	D.24.08
V3a	D.21.01

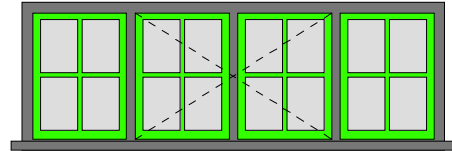

E4

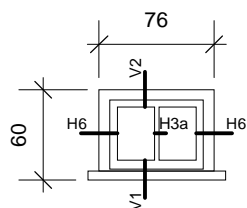

Fa

detail ref.doc.

H3a	D.21.01
H6	D.22.01
V1	D.24.07
V2	D.24.08

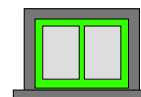

Fa

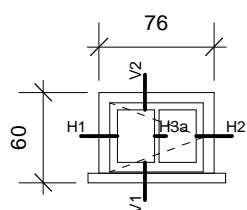

Fb

detail ref.doc.

H1	D.24.01
H2	D.24.02
H3a	D.21.01
V1	D.24.07
V2	D.24.08

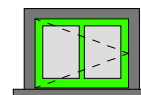

Fb

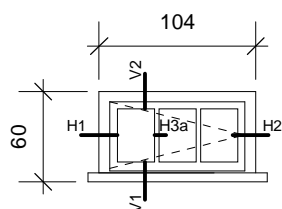

Fc

detail ref.doc.

H1	D.24.01
H2	D.24.02
H3a	D.21.01
V1	D.24.07
V2	D.24.08

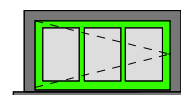

Fc

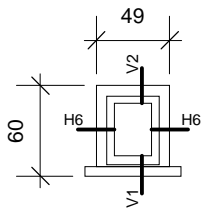

F1a

detail ref.doc.

H6 D.22.01
V1 D.24.07
V2 D.24.08

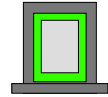

F1a

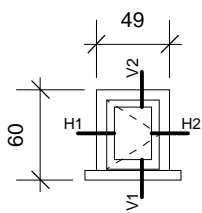

F1b

detail ref.doc.

H1 D.24.01
H2 D.24.02
V1 D.24.07
V2 D.24.08

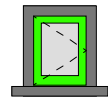

F1b

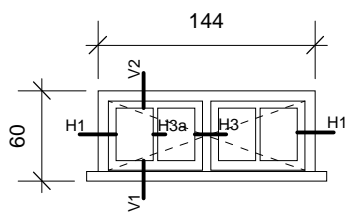

F2

detail ref.doc.

H1 D.24.01
H3 D.24.03
H3a D.21.01
V1 D.24.07
V2 D.24.08

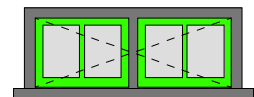

F2

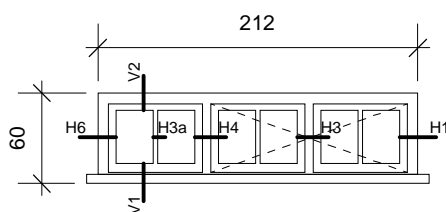

F3

detail ref.doc.

H1 D.24.01
H3 D.24.03
H3a D.21.01
H4 D.24.05
H6 D.22.01
V1 D.24.07
V2 D.24.08

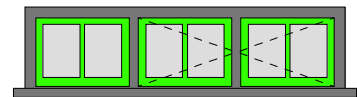

F3

F4

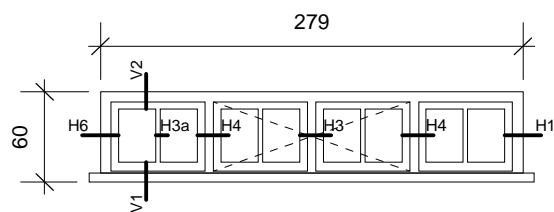

detail ref.doc.

H1	D.24.01
H3	D.24.03
H4	D.24.05
H3a	D.21.01
H6	D.22.01
V1	D.24.07
V2	D.24.08

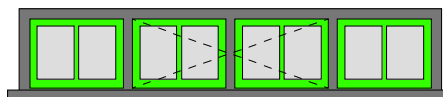

F4

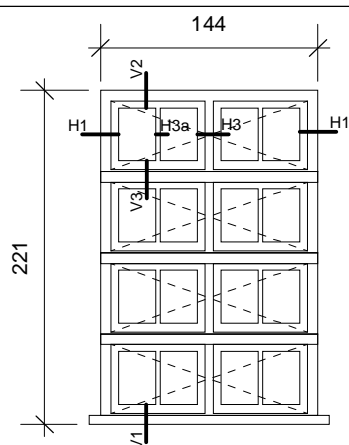

4F2

detail ref.doc.

H1	D.24.01
H3	D.24.03
H3a	D.21.01
V1	D.24.07
V2	D.24.08
V3	D.24.09

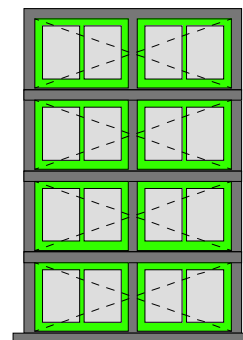

4F2

G

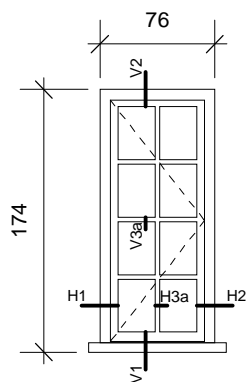

detail ref.doc.

H1	D.24.01
H2	D.24.02
H3a	D.21.01
V1	D.24.07
V2	D.24.08
V3a	D.21.01

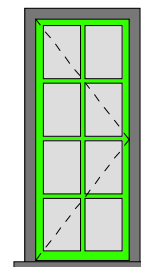

G

LE LOGIS - FLOREAL

LES CHASSIS
MAISONS "JAUNES"
(FLOREAL)

*DE RAMEN
"GELE" HUIZEN
(FLOREAL)*

P01-03



t: 02 410 84 39
f: 02 410 34 31
e: arsis@arsis.be

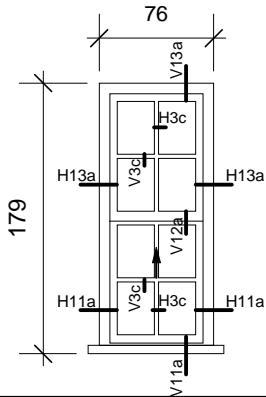

A1

detail ref.doc.

H11a	D.23.01
H13a	D.23.03
V11a	D.23.05
V12a	D.23.06
V13a	D.23.07
H3c	D.21.03
V3c	D.21.03

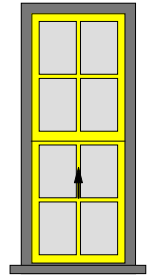

A1

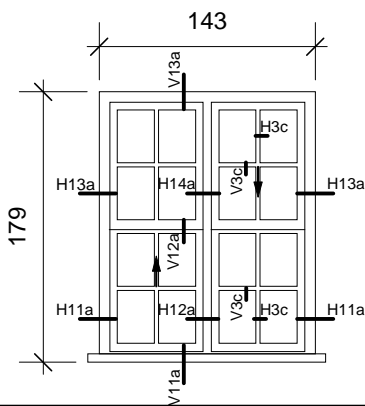

A2a

detail ref.doc.

H11a	D.23.01
H12a	D.23.02
H13a	D.23.03
H14a	D.23.04
V11a	D.23.05
V12a	D.23.06
V13a	D.23.07
H3c	D.21.03
V3c	D.21.03

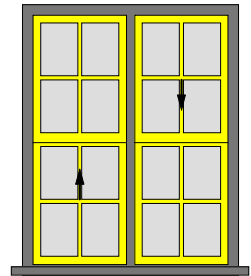

A2a

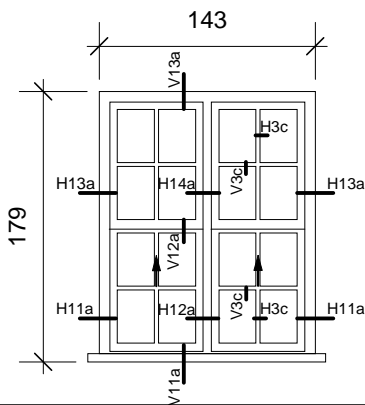

A2b

detail ref.doc.

H11a	D.23.01
H12a	D.23.02
H13a	D.23.03
H14a	D.23.04
V11a	D.23.05
V12a	D.23.06
V13a	D.23.07
H3c	D.21.03
V3c	D.21.03

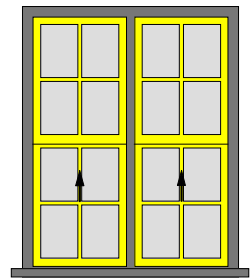

A2b

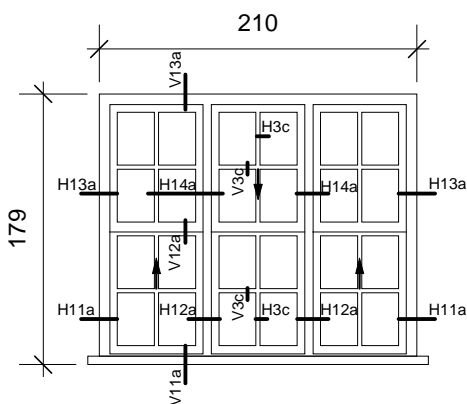

A3a

detail ref.doc.

H11a	D.23.01
H12a	D.23.02
H13a	D.23.03
H14a	D.23.04
V11a	D.23.05
V12a	D.23.06
V13a	D.23.07
H3c	D.21.03
V3c	D.21.03

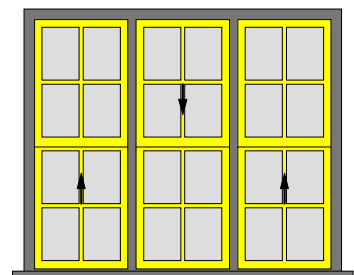

A3a

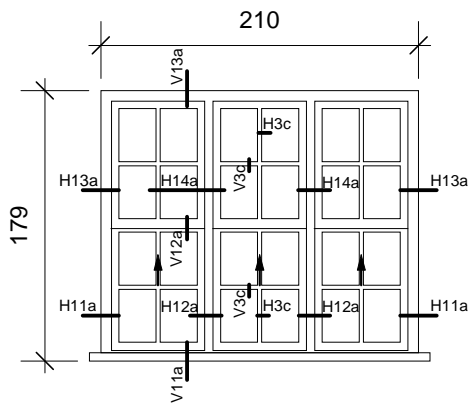

A3b

detail ref.doc.

H11a	D.23.01
H12a	D.23.02
H13a	D.23.03
H14a	D.23.04
V11a	D.23.05
V12a	D.23.06
V13a	D.23.07
H3c	D.21.03
V3c	D.21.03

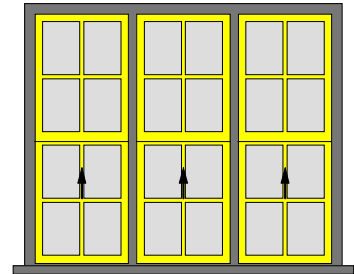

A3b



t: 02 410 84 39
f: 02 410 34 31
e: arsis@arsis.be

■ Noir - zwart
■ Verre - Glas

■ NCS 0070-G90Y: jaune - geel

Dimension réelle du jour vitré: 24,5 x 35 cm
netto glasopeningen: 24,5 x 35 cm

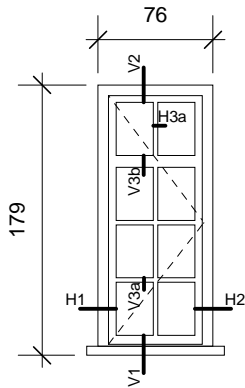

B1

detail ref.doc.

H1	D.24.01
H2	D.24.02
H3a	D.21.01
V1	D.24.07
V2	D.24.08
V3a	D.21.01
V3b	D.21.02

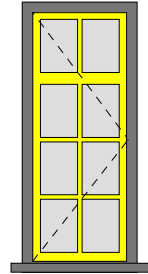

B1

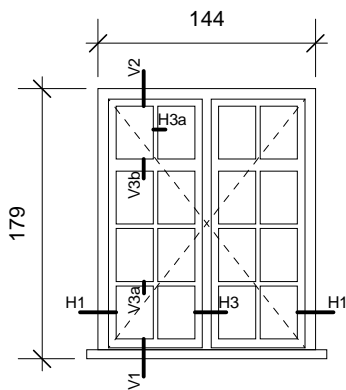

B2a

detail ref.doc.

H1	D.24.01
H3	D.24.03
H3a	D.21.01
V1	D.24.07
V2	D.24.08
V3b	D.21.02
V3a	D.21.01

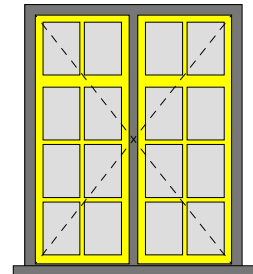

B2a

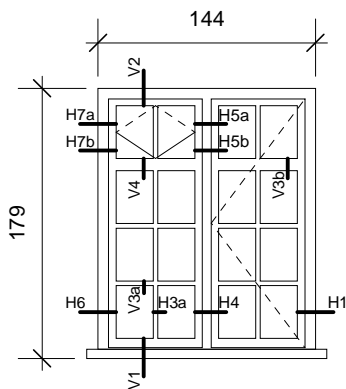

B2b

detail ref.doc.

H1	D.24.01
H3a	D.21.01
H4	D.24.05
H5a	D.25.01
H5b	D.25.02
H6	D.22.01
H7a	D.25.03
H7b	D.25.04
V1	D.24.07
V2	D.24.08
V3a	D.21.01
V3b	D.21.02
V4	D.25.05

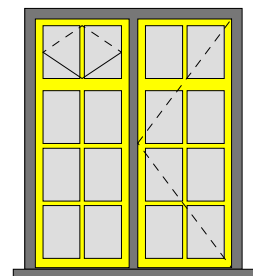

B2b

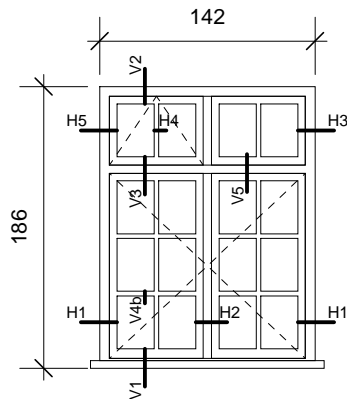

B2c

detail ref.doc.

H1	D.24.01
H2	D.24.03
H3	D.22.01
H4	D.21.01
H5	D.26.03
V1	D.24.07
V2	D.24.08
V3	D.26.01
V4b	D.21.01
V5	D.22.02

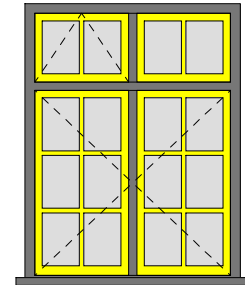

B2c

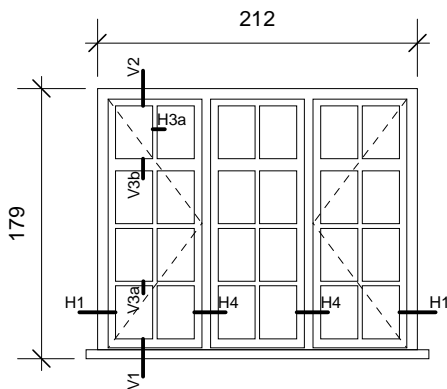

B3a

detail ref.doc.

H1	D.24.01
H3a	D.21.01
H4	D.24.05
V1	D.24.07
V2	D.24.07
V3a	D.21.01
V3b	D.21.02

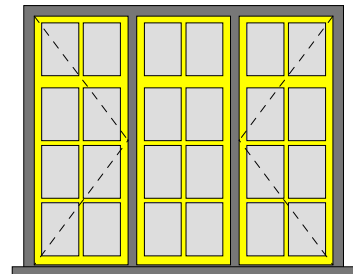

B3a

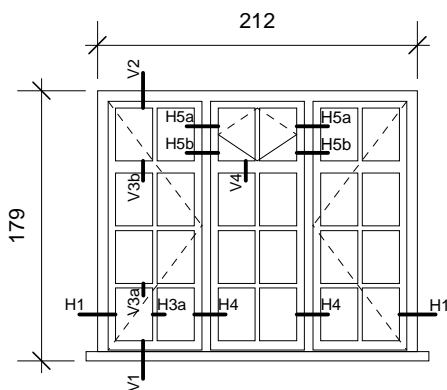

B3b

detail ref.doc.

H1	D.24.01
H3a	D.21.01
H4	D.24.05
H5a	D.25.01
H5b	D.25.02
V1	D.24.07
V2	D.24.08
V3a	D.21.01
V3b	D.21.02
V4	D.25.05

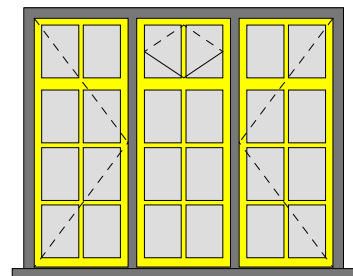

B3b

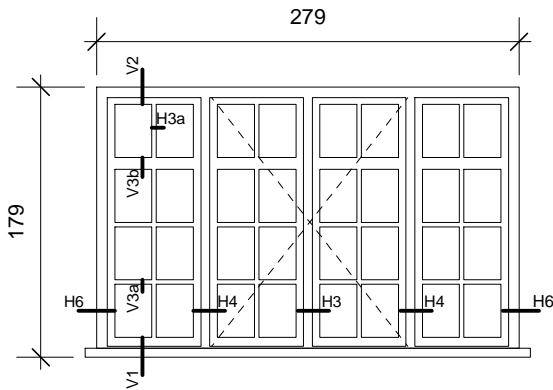

B4

detail ref.doc.

H3	D.24.03
H3a	D.21.01
H4	D.24.05
H6	D.22.01
V1	D.24.07
V2	D.24.07
V3a	D.21.01
V3b	D.21.02

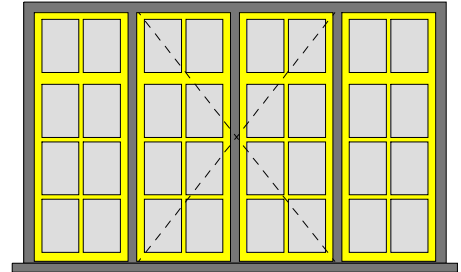

B4

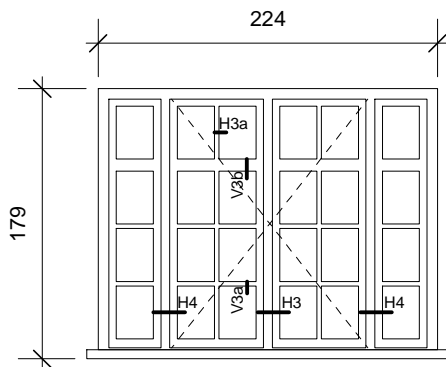

B4bis

detail ref.doc.

H3	D.24.03
H3a	D.21.01
H4	D.24.05
V3a	D.21.01
V3b	D.21.02

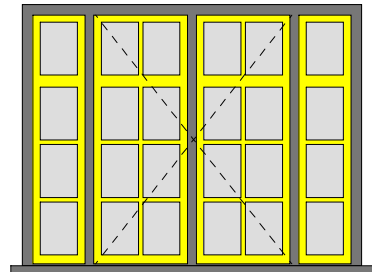

B4bis

C1

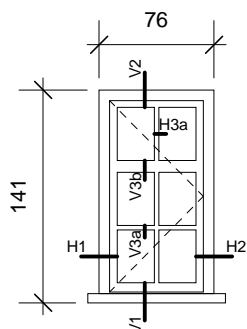

detail ref.doc.

H1	D.24.01
H2	D.24.02
H3a	D.21.01
V1	D.24.07
V2	D.24.08
V3a	D.21.01
V3b	D.21.02

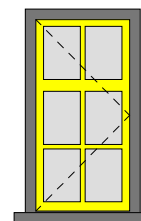

C1

C2a

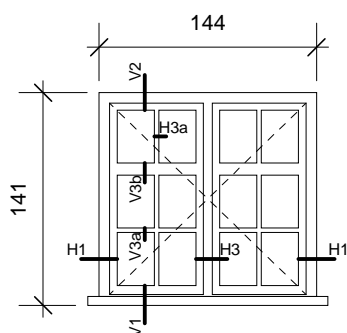

detail ref.doc.

H1	D.24.01
H3	D.24.03
H3a	D.21.01
V1	D.24.07
V2	D.24.08
V3b	D.21.02
V3a	D.21.01

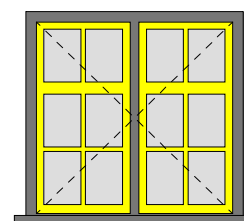

C2a

C2b

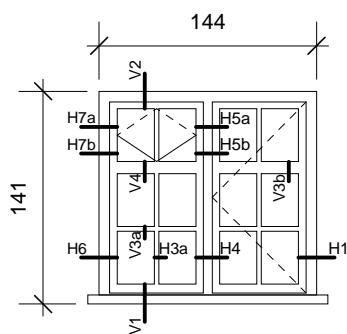

detail ref.doc.

H1	D.24.01
H3a	D.21.01
H4	D.24.05
H5a	D.25.01
H5b	D.25.02
H6	D.22.01
H7a	D.25.03
H7b	D.25.04
V1	D.24.07
V2	D.24.08
V3a	D.21.01
V3b	D.21.02
V4	D.25.05

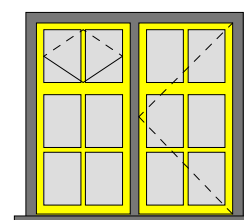

C2b

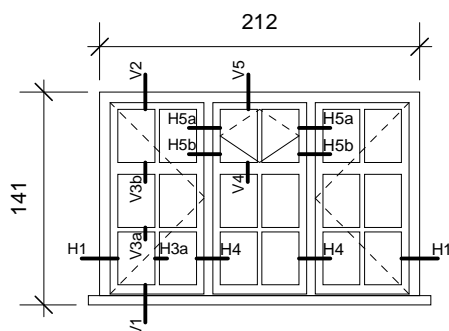

C3a

detail ref.doc.

H1	D.24.01
H3a	D.21.01
H4	D.24.05
H5a	D.25.01
H5b	D.25.02
V1	D.24.07
V2	D.24.08
V3a	D.21.01
V3b	D.21.02
V4	D.25.05
V5	D.24.08

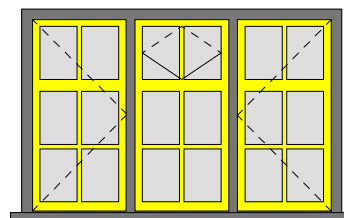

C3a

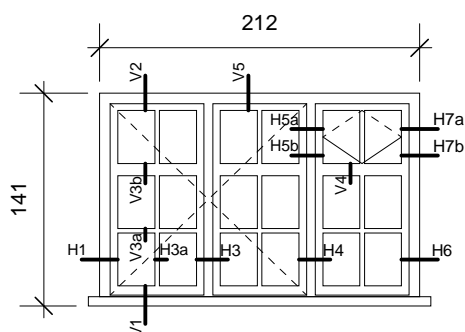

C3b

detail ref.doc.

H1	D.24.01
H3	D.24.03
H3a	D.21.01
H4	D.24.05
H5a	D.25.01
H5b	D.25.02
H6	D.22.01
H7a	D.25.03
H7b	D.25.04
V1	D.24.07
V2	D.24.08
V3a	D.21.01
V3b	D.21.02
V4	D.25.05
V5	D.24.08

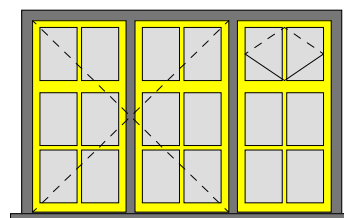

C3b

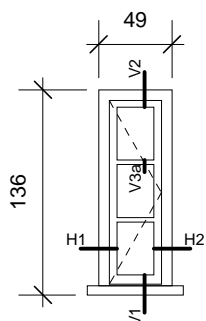

D

detail ref.doc.

H1	D.24.01
H2	D.24.02
V1	D.24.07
V2	D.24.08
V3a	D.21.01

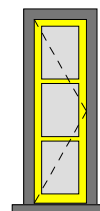

D

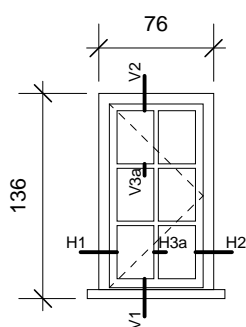

D1

detail ref.doc.

H1	D.24.01
H2	D.24.02
H3a	D.21.01
V1	D.24.07
V2	D.24.08
V3a	D.21.01

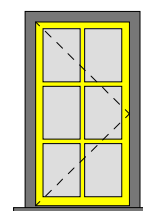

D1

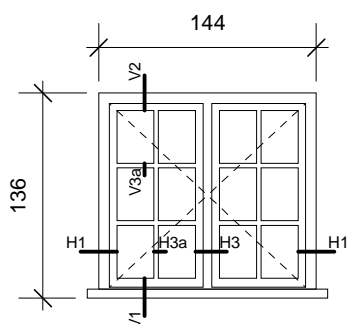

D2

detail ref.doc.

H1	D.24.01
H3	D.24.03
H3a	D.21.01
V1	D.24.07
V2	D.24.08
V3a	D.21.01

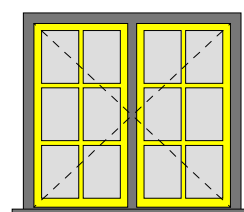

D2

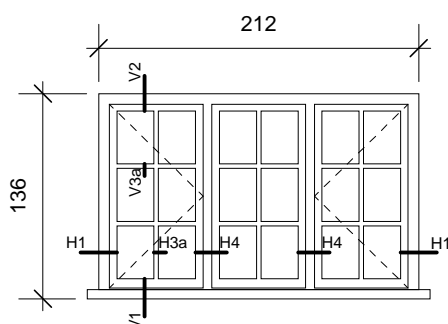

D3a

detail ref.doc.

H1	D.24.01
H4	D.24.05
H3a	D.21.01
V1	D.24.07
V2	D.24.08
V3a	D.21.01

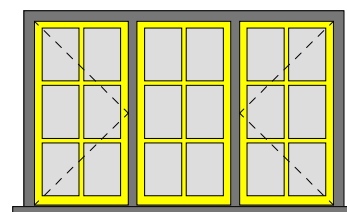

D3a

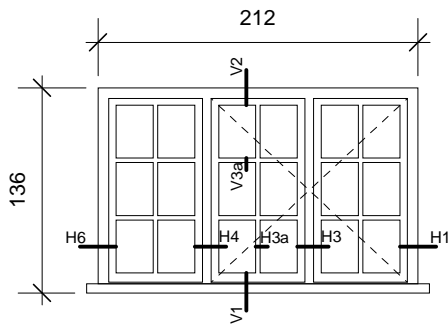

D3b

detail ref.doc.

H1	D.24.01
H3	D.24.03
H3a	D.21.01
H4	D.24.05
H6	D.22.01
V1	D.24.07
V2	D.24.08
V3a	D.21.01

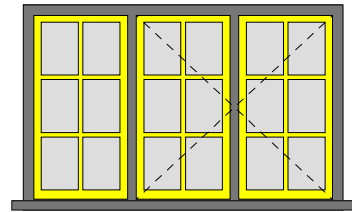

D3b

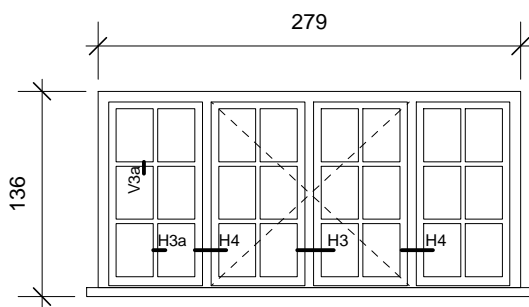

D4

detail ref.doc.

H3	D.24.03
H3a	D.21.01
H4	D.24.05
V3a	D.21.01

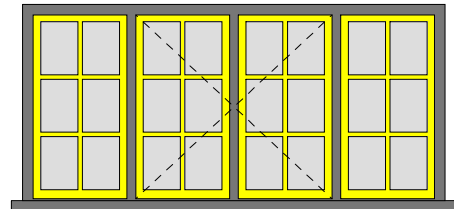

D4

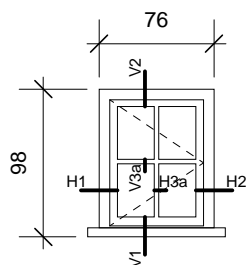

E

detail ref.doc.

H1	D.24.01
H2	D.24.02
H3a	D.21.01
V1	D.24.07
V2	D.24.08
V3a	D.21.01

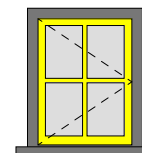

E

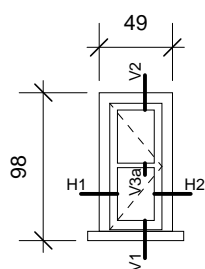

E1

detail ref.doc.

H1	D.24.01
H2	D.24.02
V1	D.24.07
V2	D.24.08
V3a	D.21.01

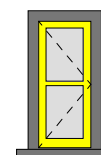

E1

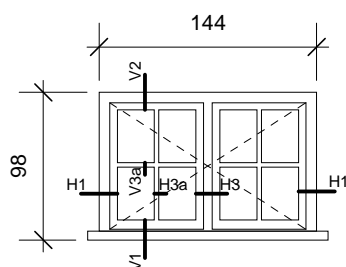

E2

detail ref.doc.

H1	D.24.01
H3	D.24.03
H3a	D.21.01
V1	D.24.07
V2	D.24.08
V3a	D.21.01

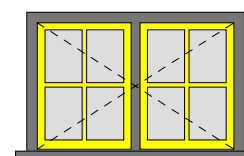

E2

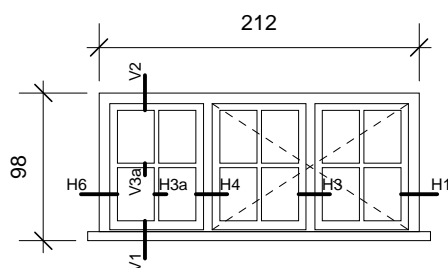

E3

detail ref.doc.

H1	D.24.01
H3	D.24.03
H3a	D.21.01
H4	D.24.05
H6	D.22.01
V1	D.24.07
V2	D.24.08
V3a	D.21.01

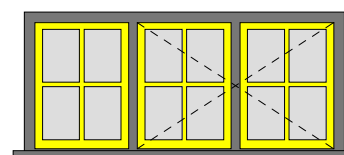

E3

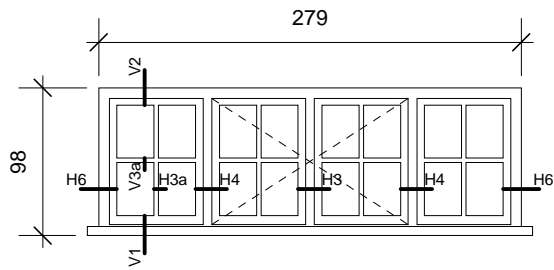

E4

detail ref.doc.

H3	D.24.03
H3a	D.21.01
H4	D.24.05
H6	D.22.01
V1	D.24.07
V2	D.24.08
V3a	D.21.01

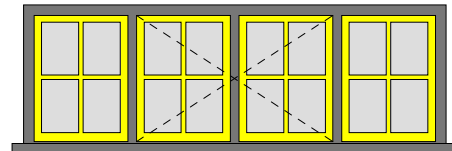

E4



t: 02 410 84 39
f: 02 410 34 31
e: arsis@arsis.be

■ Noir - zwart
■ Verre - Glas

■ NCS 0070-G90Y: jaune - geel

Dimension réelle du jour vitré: 24,5 x 35 cm
netto glasopeningen: 24,5 x 35 cm

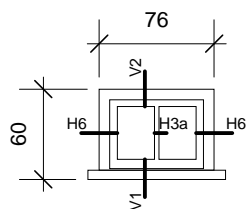

Fa

detail ref.doc.

H3a	D.21.01
H6	D.22.01
V1	D.24.07
V2	D.24.08

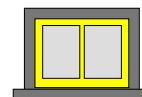

Fa

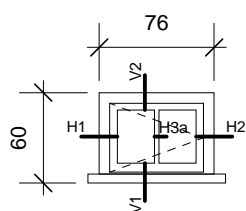

Fb

detail ref.doc.

H1	D.24.01
H2	D.24.02
H3a	D.21.01
V1	D.24.07
V2	D.24.08

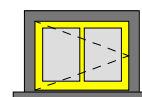

Fb

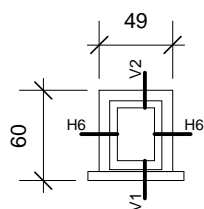

F1a

detail ref.doc.

H6	D.22.01
V1	D.24.07
V2	D.24.08

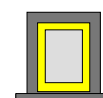

F1a

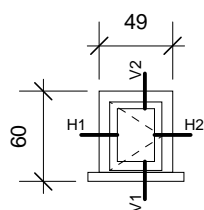

F1b

detail ref.doc.

H1	D.24.01
H2	D.24.02
V1	D.24.07
V2	D.24.08

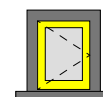

F1b

F2

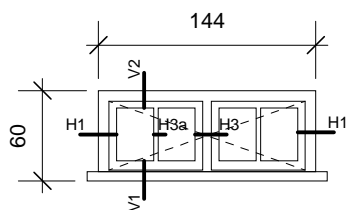

detail ref.doc.

H1	D.24.01
H3	D.24.03
H3a	D.21.01
V1	D.24.07
V2	D.24.08

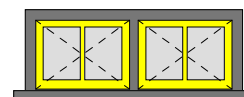

F2

F3

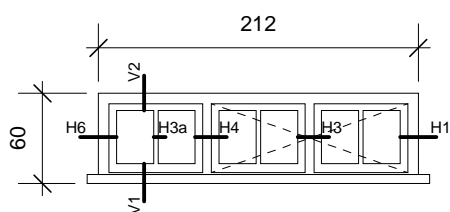

detail ref.doc.

H1	D.24.01
H3	D.24.03
H3a	D.21.01
H4	D.24.05
H6	D.22.01
V1	D.24.07
V2	D.24.08

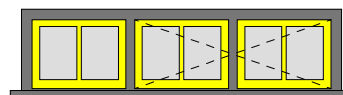

F3

F4

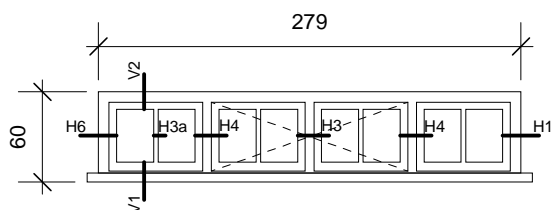

detail ref.doc.

H1	D.24.01
H3	D.24.03
H4	D.24.05
H3a	D.21.01
H6	D.22.01
V1	D.24.07
V2	D.24.08

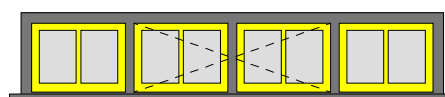

F4

Fc

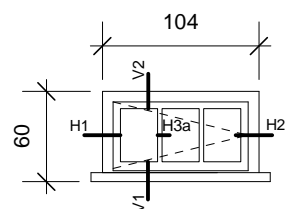

detail ref.doc.

H1	D.24.01
H2	D.24.02
H3a	D.21.01
V1	D.24.07
V2	D.24.08

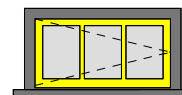

Fc

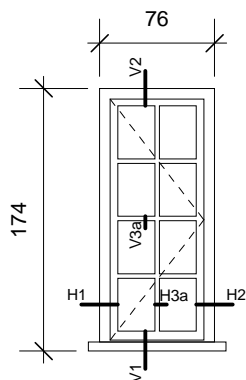

G

detail ref.doc.

H1	D.24.01
H2	D.24.02
H3a	D.21.01
V1	D.24.07
V2	D.24.08
V3a	D.21.01

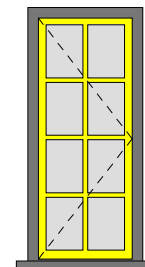

G

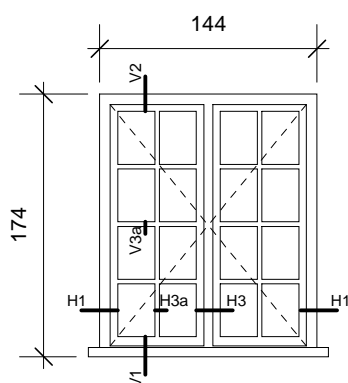

G2

detail ref.doc.

H1	D.24.01
H3	D.24.03
H3a	D.21.01
V1	D.24.07
V2	D.24.08
V3a	D.21.01

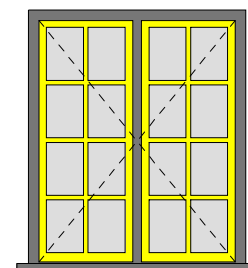

G2

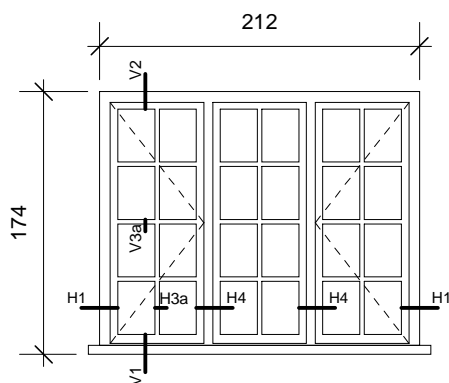

G3a

detail ref.doc.

H1	D.24.01
H4	D.24.05
H3a	D.21.01
V1	D.24.07
V2	D.24.08
V3a	D.21.01

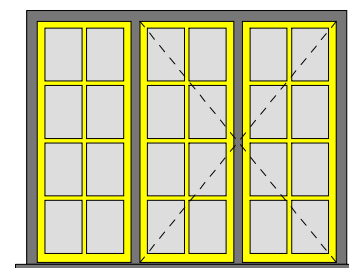

G3

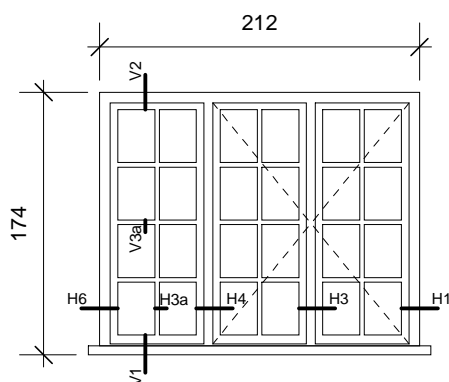

G3b

detail ref.doc.

H1	D.24.01
H3	D.24.03
H3a	D.21.01
H4	D.24.05
H6	D.22.01
V1	D.24.07
V2	D.24.08
V3a	D.21.01

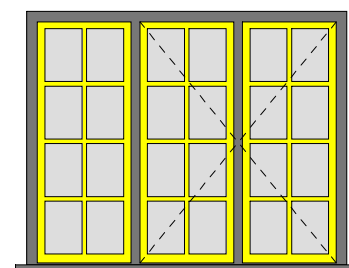

G3

M

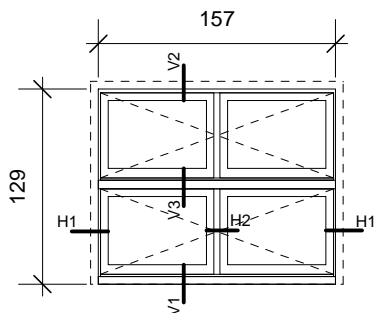

detail ref.doc.

H1	D.24.01
H2	D.24.03
V1	D.24.07
V2	D.24.08
V3	D.24.09

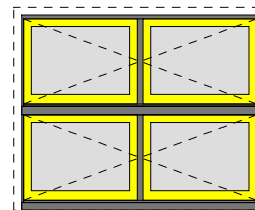

M

N2

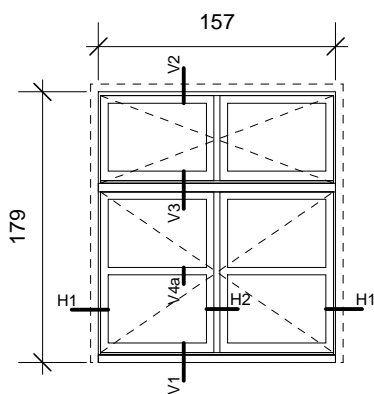

detail ref.doc.

H1	D.24.01
H2	D.24.03
V1	D.24.07
V2	D.24.08
V3	D.24.09
V4a	D.21.04

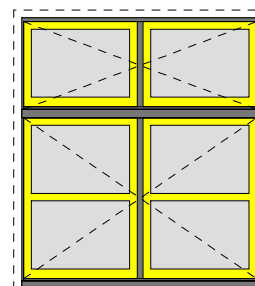

N

N1

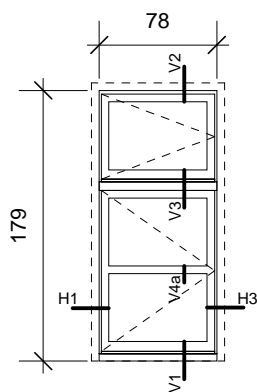

detail ref.doc.

H1	D.24.01
H3	D.24.02
V1	D.24.07
V2	D.24.08
V3	D.24.09
V4a	D.21.04

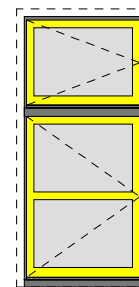

N1

O

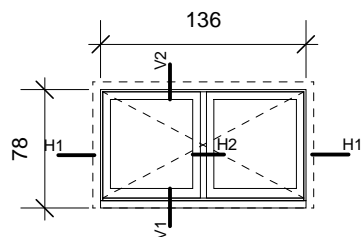

detail ref.doc.

H1	D.24.01
H2	D.24.03
V1	D.24.07
V2	D.24.08

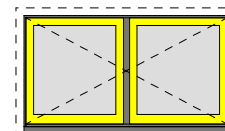

O

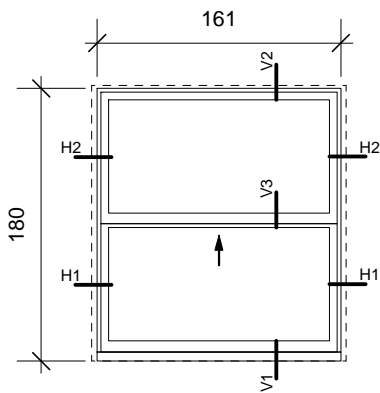

P

detail ref.doc.

H1	D.23.11
H2	D.23.12
V1	D.23.13
V2	D.23.14
V3	D.23.15

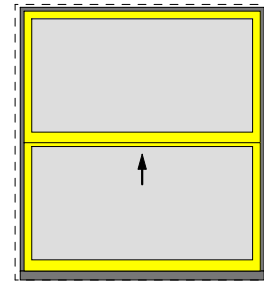

P

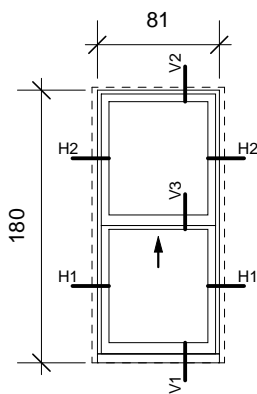

Q

detail ref.doc.

H1	D.23.11
H2	D.23.12
V1	D.23.13
V2	D.23.14
V3	D.23.15

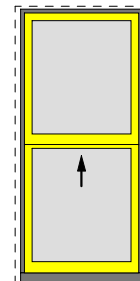

Q

LE LOGIS - FLOREAL

LES CHASSIS
MAISONS "BLANCHES"
(LE LOGIS)

*DE RAMEN
"WITTE" HUIZEN
(LE LOGIS)*

P01-04



t: 02 410 84 39
f: 02 410 34 31
e: arsis@arsis.be

Vensters type Fenêtres

p. P01-04/1

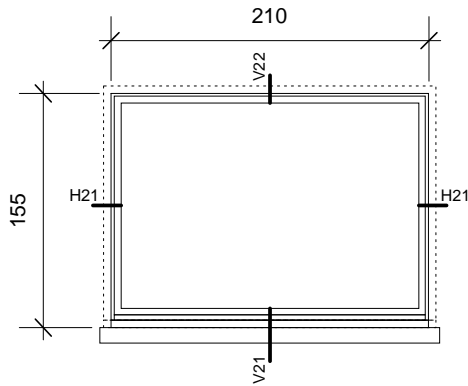

I

detail ref.doc.

H21	D.24.11
V21	D.24.15
V22	D.24.16



I

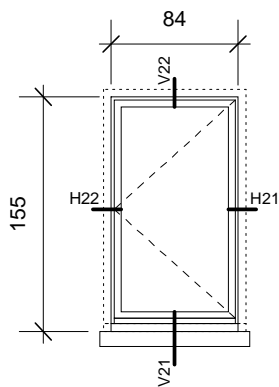

I1

detail ref.doc.

H21	D.24.11
H22	D.24.12
V21	D.24.15
V22	D.24.16

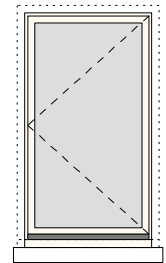

I1

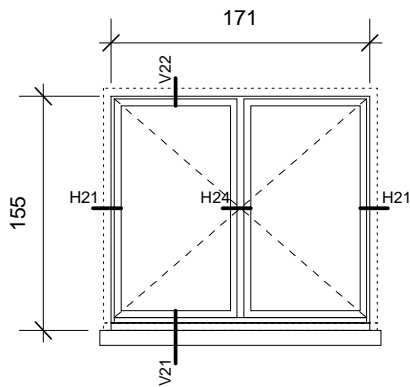

I2

detail ref.doc.

H21	D.24.11
H24	D.24.14
V21	D.24.15
V22	D.24.16

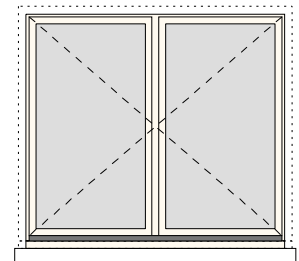

I2

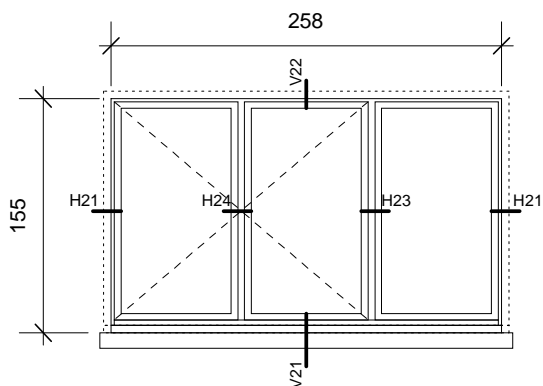

I3

detail ref.doc.

H21	D.24.11
H23	D.24.13
H24	D.24.14
V21	D.24.15
V22	D.24.16

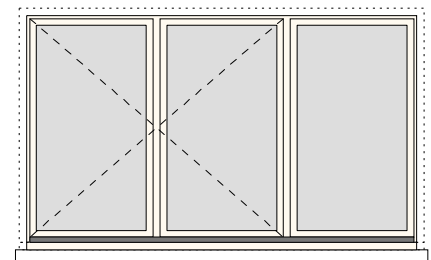

I3

K1

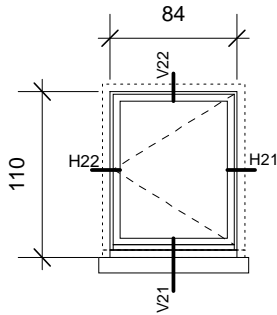

detail ref.doc.

H21	D.24.11
H22	D.24.12
V21	D.24.15
V22	D.24.16

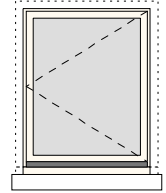

K1

K2

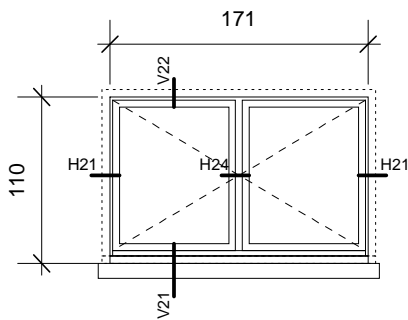

detail ref.doc.

H21	D.24.11
H24	D.24.14
V21	D.24.15
V22	D.24.16

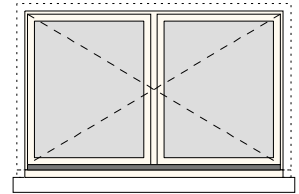

K2

K3

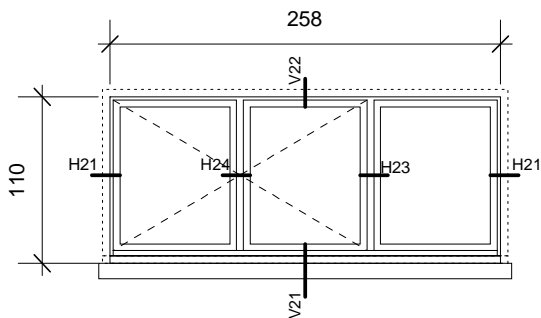

detail ref.doc.

H21	D.24.11
H23	D.24.13
H24	D.24.14
V21	D.24.15
V22	D.24.16

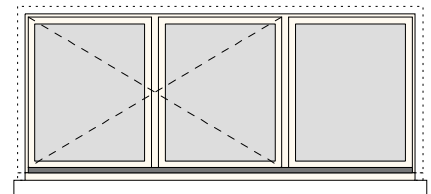

K3

L

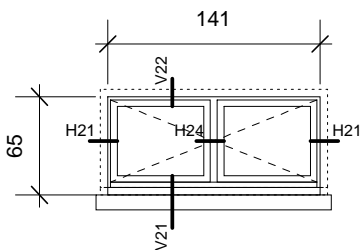

detail ref.doc.

H21	D.24.11
H24	D.24.14
V21	D.24.15
V22	D.24.16

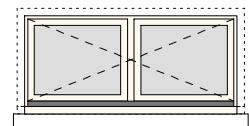

L

J

detail ref.doc.

H21	D.24.11
V21	D.24.15
V22	D.24.16

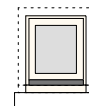
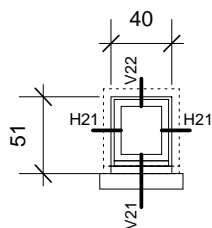

J

Ja

detail ref.doc.

H21	D.24.11
H22	D.24.12
V21	D.24.15
V22	D.24.16

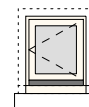
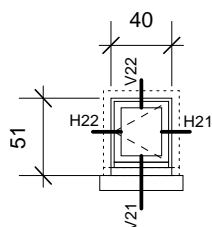

Ja

J(+40)

detail ref.doc.

H21	D.24.21
V21	D.24.25
V22	D.24.26

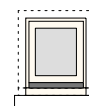
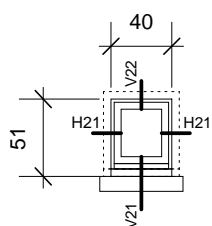

J(+40)

Ja(+40)

detail ref.doc.

H21	D.24.21
H22	D.24.22
V21	D.24.25
V22	D.24.26

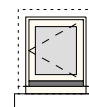
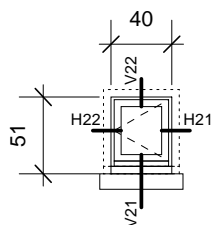

Ja(+40)

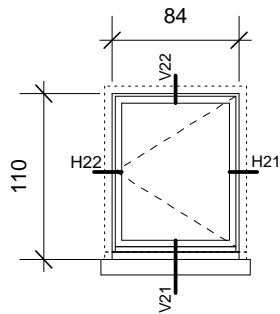

K1(+40)

detail ref.doc.

H21	D.24.21
H22	D.24.22
V21	D.24.25
V22	D.24.26

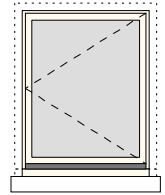

K1(+40)

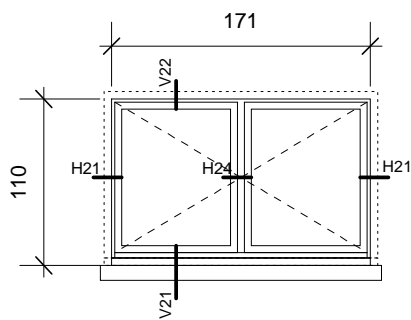

K2(+40)

detail ref.doc.

H21	D.24.21
H24	D.24.24
V21	D.24.25
V22	D.24.26

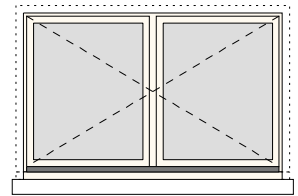

K2(+40)

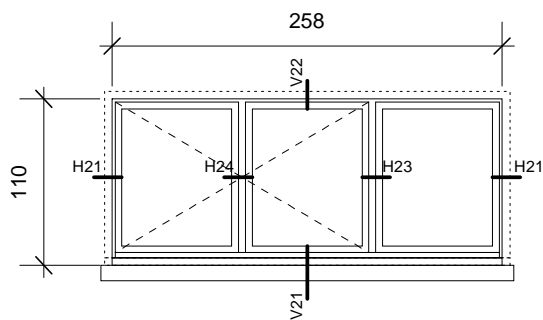

K3(+40)

detail ref.doc.

H21	D.24.21
H23	D.24.23
H24	D.24.24
V21	D.24.25
V22	D.24.26

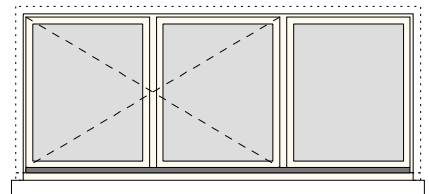

K3(+40)

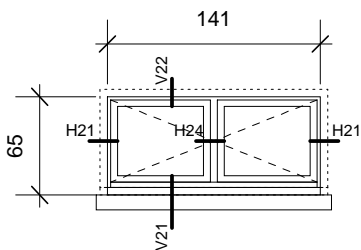

L(+40)

detail ref.doc.

H21	D.24.21
H24	D.24.24
V21	D.24.25
V22	D.24.26

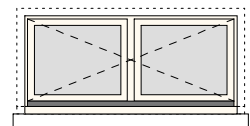

L(+40)

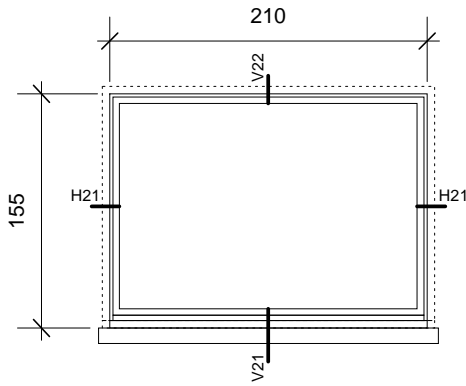

I(+40)

detail ref.doc.

H21	D.24.21
V21	D.24.25
V22	D.24.26



I(+40)

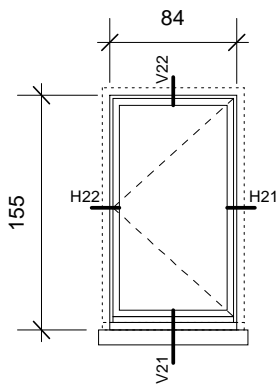

I1(+40)

detail ref.doc.

H21	D.24.21
H22	D.24.22
V21	D.24.25
V22	D.24.26

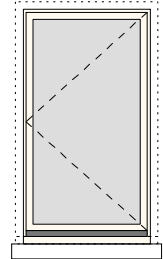

I1(+40)

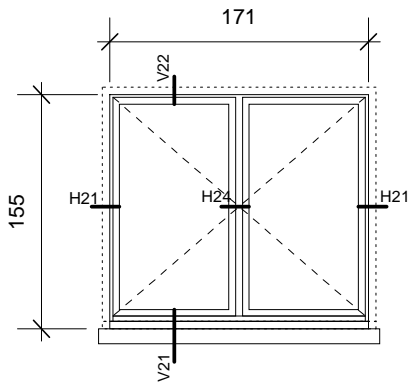

I2(+40)

detail ref.doc.

H21	D.24.21
H24	D.24.24
V21	D.24.25
V22	D.24.26

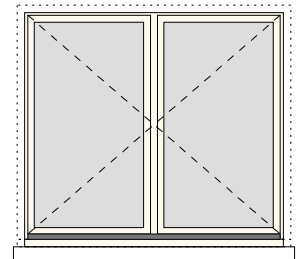

I2(+40)

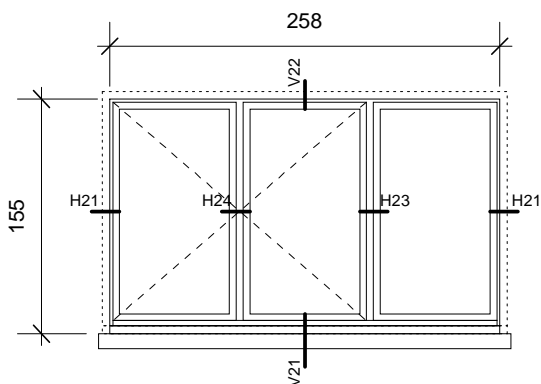

I3(+40)

detail ref.doc.

H21	D.24.21
H23	D.24.23
H24	D.24.24
V21	D.24.25
V22	D.24.26

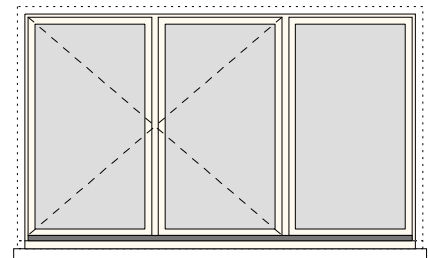

I3(+40)

LE LOGIS - FLOREAL

LES LUCARNES
MAISONS "VERTES"
(LE LOGIS)

*DE DAKKAPELLEN
"GROENE" HUIZEN
(LE LOGIS)*

P01-05



t: 02 410 84 39
f: 02 410 34 31
e: arsis@arsis.be

A

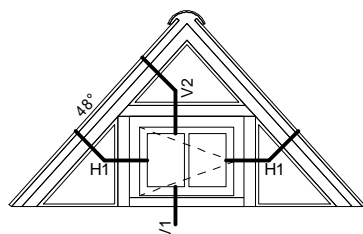

raam	Fb
fenêtre	
detail	ref.doc.
aanzicht	C.41.01
H1	C.41.21/1
V1	C.41.11/1
V2	C.41.12/1

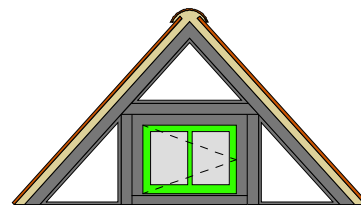

A

Abis

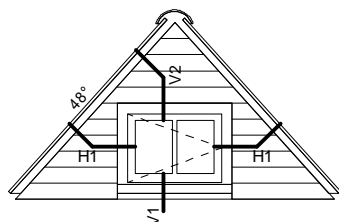

raam	Fb
fenêtre	
detail	ref.doc.
H1	C.42.21/3
V1	C.42.11/3
V2	C.42.12/3

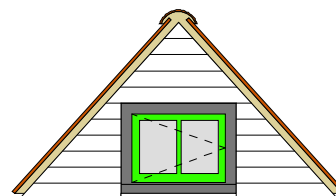

Abis

B

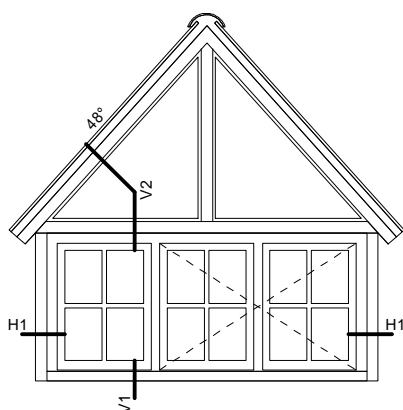

raam	E3
fenêtre	
detail	ref.doc.
H1	C.41.22/2
V1	C.41.11/2
V2	C.41.12/2

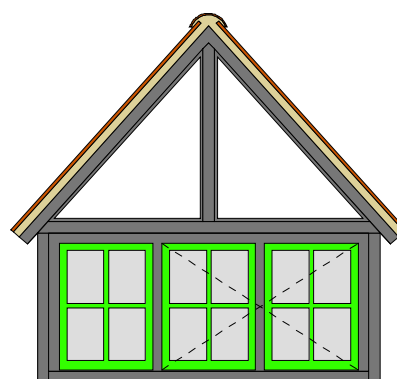

B

Bbis

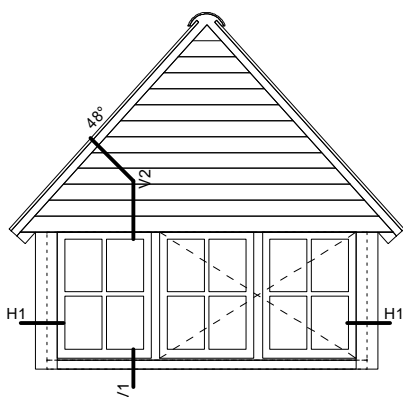

raam	E3
fenêtre	
detail	ref.doc.
H1	C.42.22/2
V1	C.42.11/2
V2	C.42.12/2

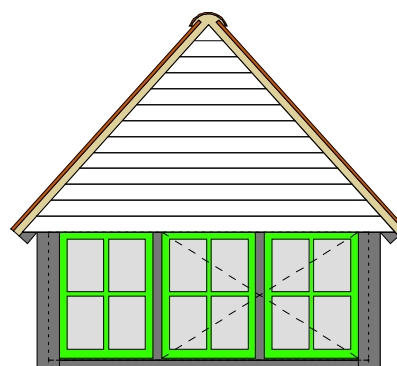

Bbis

Ca

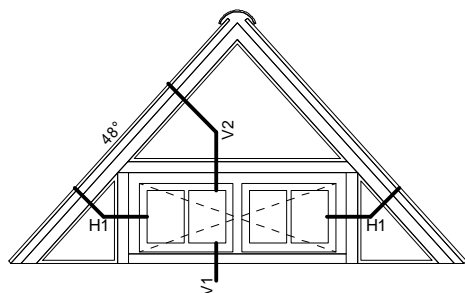

raam	F2
fenêtre	
detail	ref.doc.
aanzicht	C.41.01
H1	C.41.21/1
V1	C.41.11/1
V2	C.41.12/1

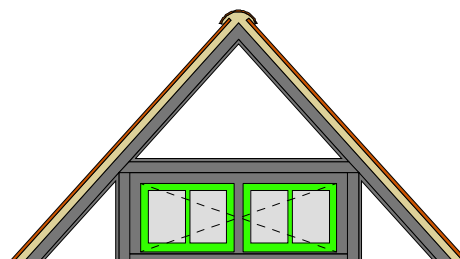

Ca

Cb

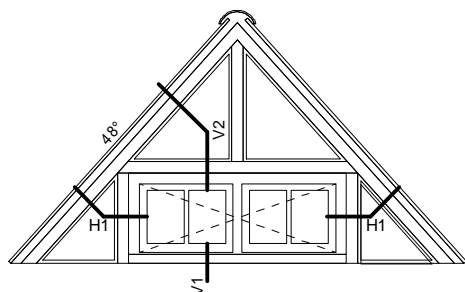

raam	F2
fenêtre	
detail	ref.doc.
aanzicht	C.41.01
H1	C.41.21/1
V1	C.41.11/1
V2	C.41.12/1

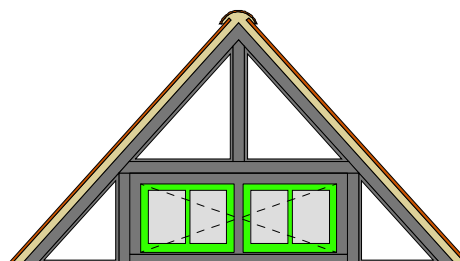

Cb

Cbis

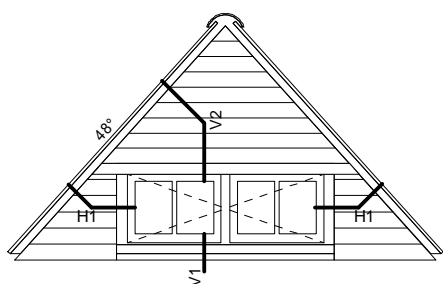

raam	F2
fenêtre	
detail	ref.doc.
H1	C.42.21/1
V1	C.42.11/1
V2	C.42.12/1

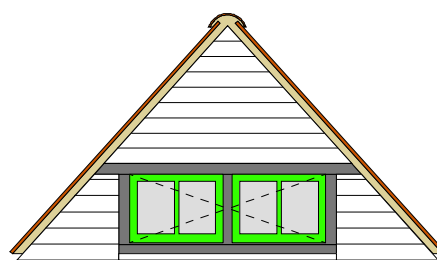

Cbis

D

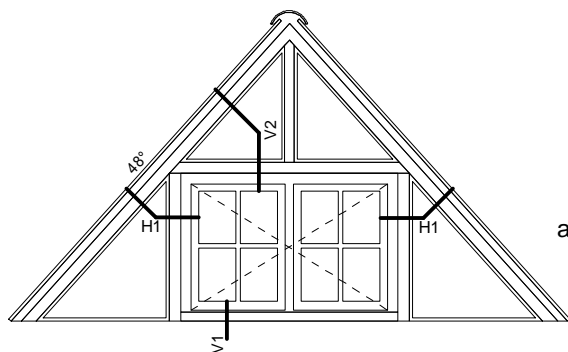

raam	E2
fenêtre	
detail	ref.doc.
aanzicht	C.41.01
H1	C.41.21/1
V1	C.41.11/1
V2	C.41.12/1

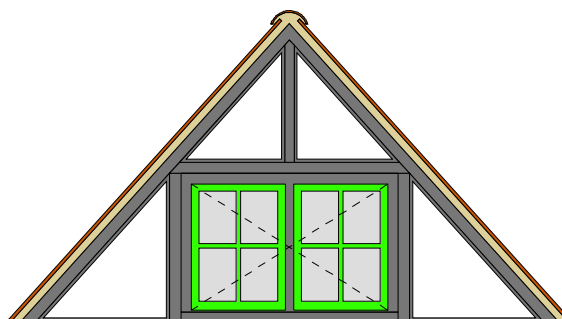

D

Dbis

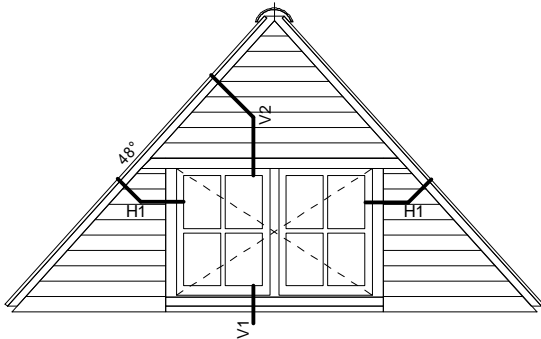

raam E2
fenêtre

detail ref.doc.

H1 C.42.21/1
V1 C.42.11/1
V2 C.42.12/1

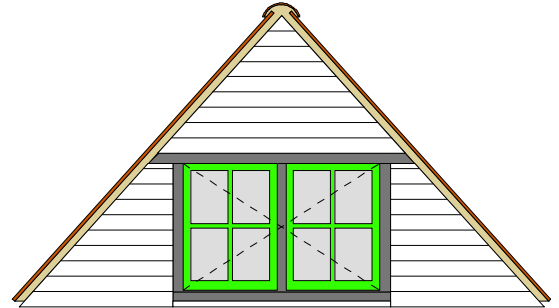

Dbis

E

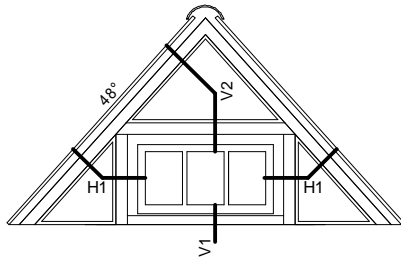

raam Fc
fenêtre

detail ref.doc.

H1 C.41.21/1
V1 C.41.11/1
V2 C.41.12/1

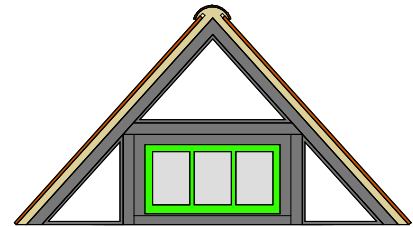

E

Ebis

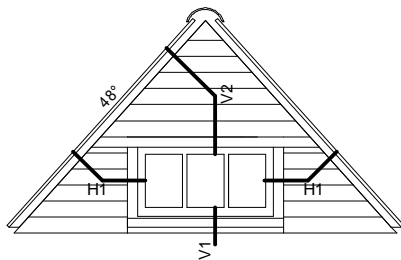

raam Fc
fenêtre

detail ref.doc.

H1 C.42.21/1
V1 C.42.11/1
V2 C.42.12/1

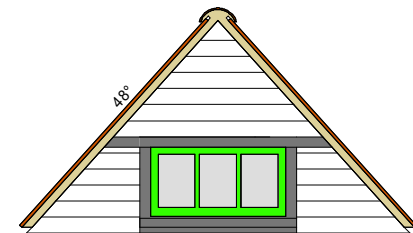

E

Ea

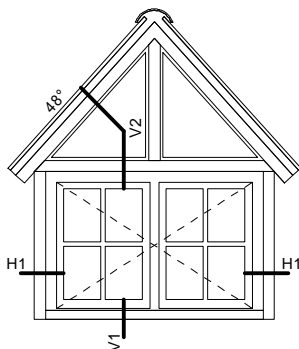

raam E2
fenêtre

detail ref.doc.

H1 C.41.22/2
V1 C.41.11/2
V2 C.41.12/2

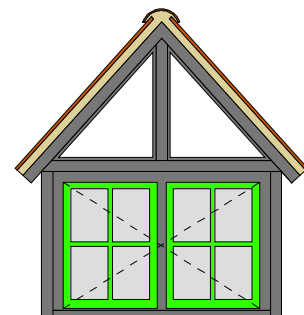

Ea

Eb

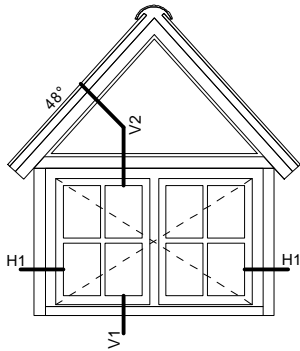

raam fenêtre E2

detail ref.doc.

H1 C.41.22/2
V1 C.41.11/2
V2 C.41.12/2

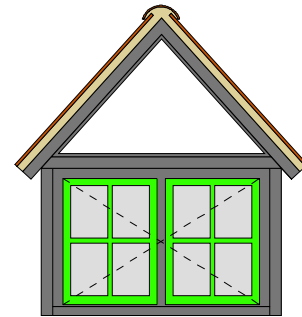

Eb

F

raam fenêtre A3b

detail ref.doc.

H 0

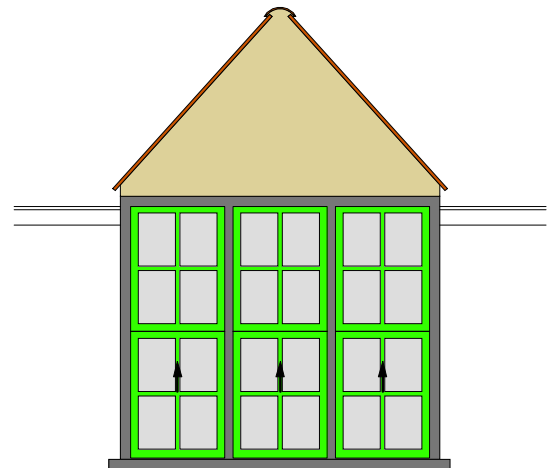

LE LOGIS - FLOREAL

Dakkapel type Lucarne

p. P01-05/5

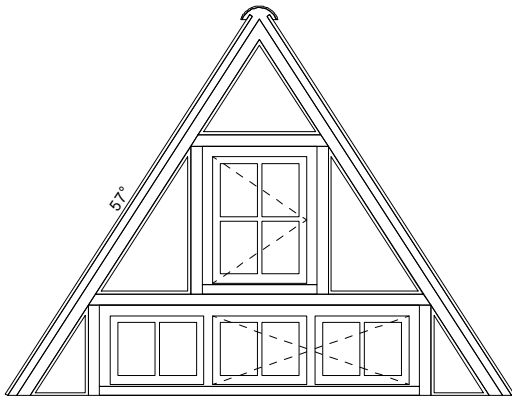

L

raam fenêtre E + F3

detail ref.doc.

H 0

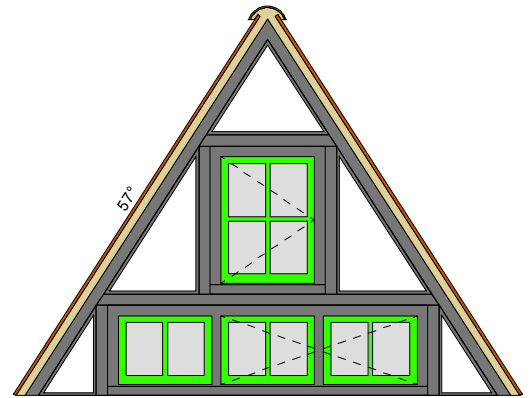

L

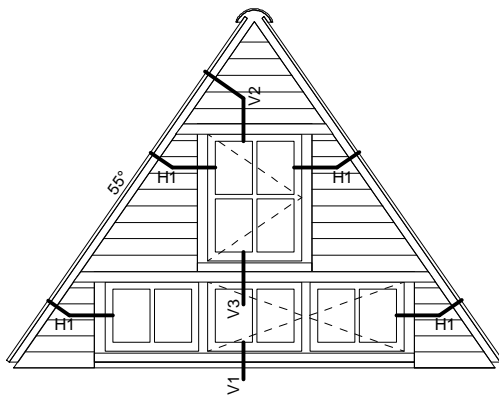

Lbis

raam fenêtre E + F3

detail ref.doc.

H1 C.42.21/1

V1 C.42.11/1

V2 C.42.12/1

V3 C.42.13/1



Lbis

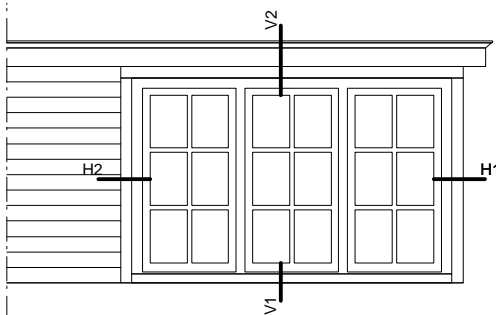

N

raam fenêtre D3

detail ref.doc.

H1 C.44.21/2

H2 C.44.22/2

V1 C.44.11/2

V2 C.44.12/2

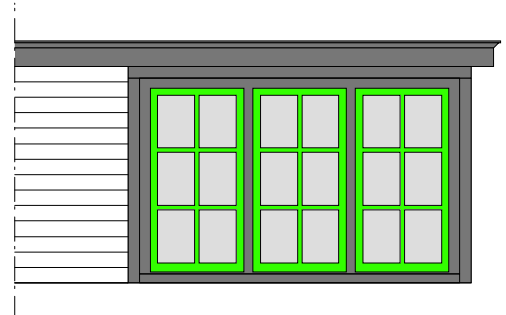

N



t: 02 410 84 39
f: 02 410 34 31
e: arsis@arsis.be

■ Noir - zwart
■ Blanc - Wit
■ Verre - Glas
éch./sch.: 1/50

■ Tuiles - pannen
■ Mortier - mortel
■ NCS 4060-G2OY: vert - groen

LE LOGIS - FLOREAL

LES LUCARNES
MAISONS "JAUNES"
(FLOREAL)

*DE DAKKAPELLEN
"GELE" HUIZEN
(FLOREAL)*

P01-06



t: 02 410 84 39
f: 02 410 34 31
e: arsis@arsis.be

A

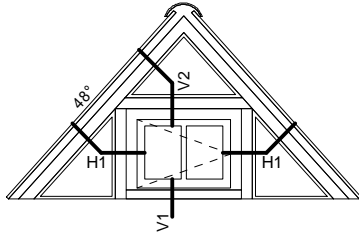

raam fenêtre Fb

detail ref.doc.

aanzicht C.41.01
H1 C.41.21/1
V1 C.41.11/1
V2 C.41.12/1

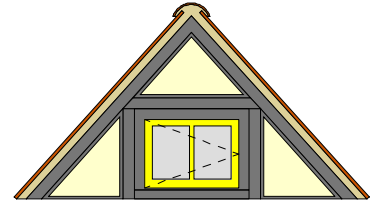

A

B

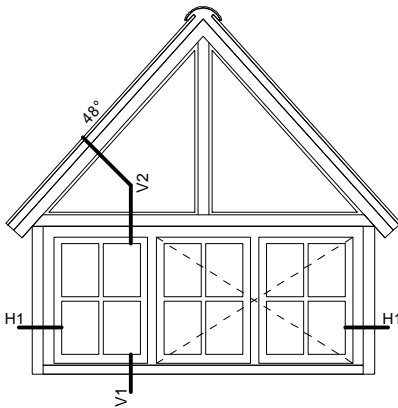

raam fenêtre E3

detail ref.doc.

H1 C.41.22/2
V1 C.41.11/2
V2 C.41.12/2

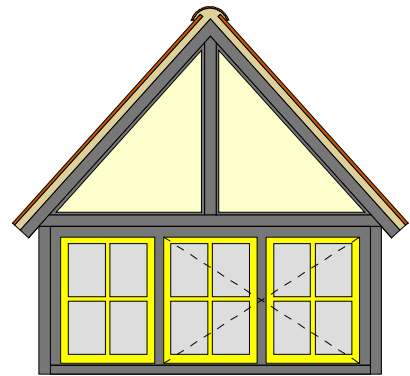

B

Ca

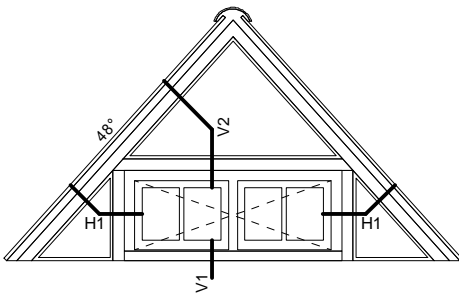

raam fenêtre F2

detail ref.doc.

aanzicht C.41.01
H1 C.41.21/1
V1 C.41.11/1
V2 C.41.12/1

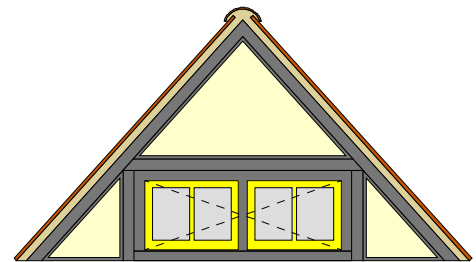

Ca

E

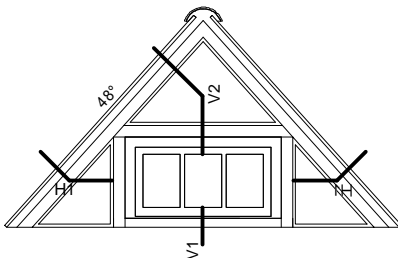

raam fenêtre Fc

detail ref.doc.

H1 C.41.21/1
V1 C.41.11/1
V2 C.41.12/1

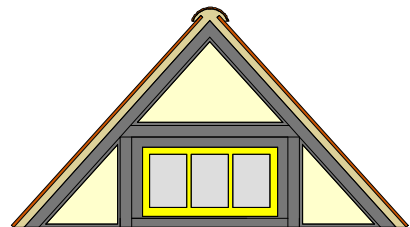

E

Ebis

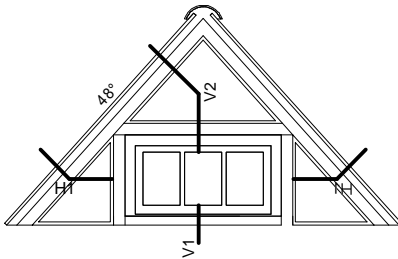

raam fenêtre Fc

detail ref.doc.

H1 C.41.21/1
V1 C.41.11/1
V2 C.41.12/1

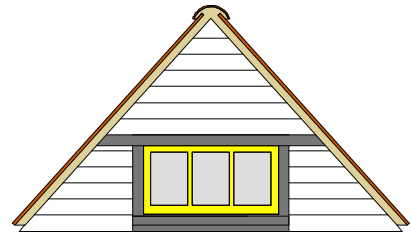

Ebis

Ea

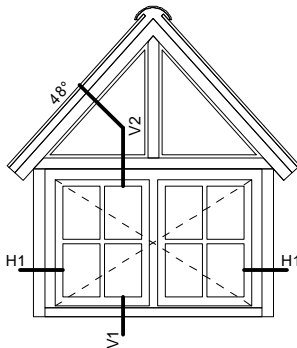

raam fenêtre E2

detail ref.doc.

H1 C.41.22/2
V1 C.41.11/2
V2 C.41.12/2

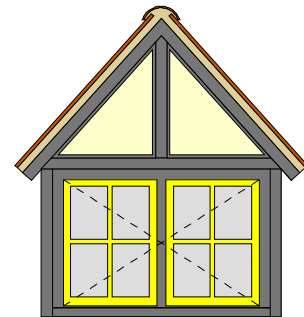

Ea

Pa

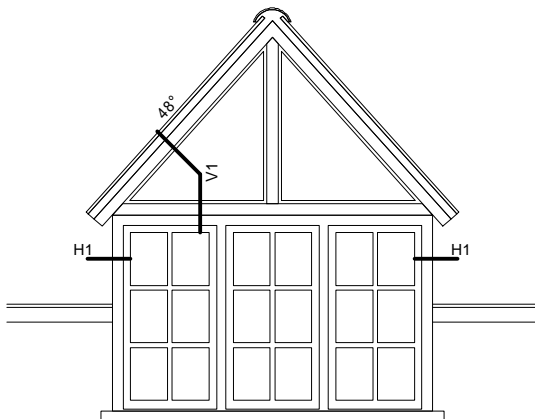

raam fenêtre D3

detail ref.doc.

H1 C.41.23/3
V1 C.41.12/3

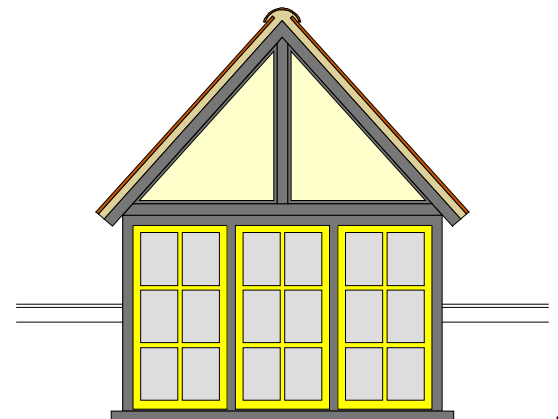

Pa

Pb

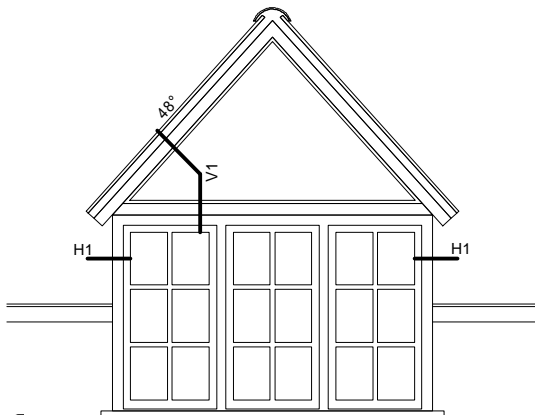

raam fenêtre D3

detail ref.doc.

H1 C.41.23/3
V1 C.41.12/3

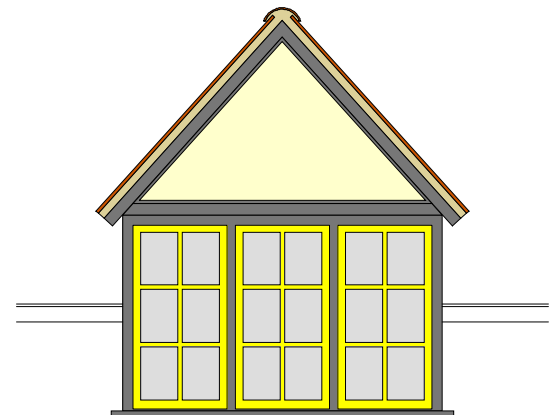

Pb

Qa

raam E3
fenêtre

detail ref.doc.

H1 C.41.23/3
V1 C.41.12/3

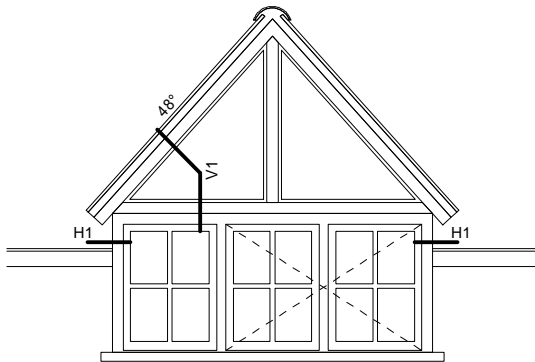

Qa

Qb

raam E3
fenêtre

detail ref.doc.

H1 C.41.23/3
V1 C.41.12/3

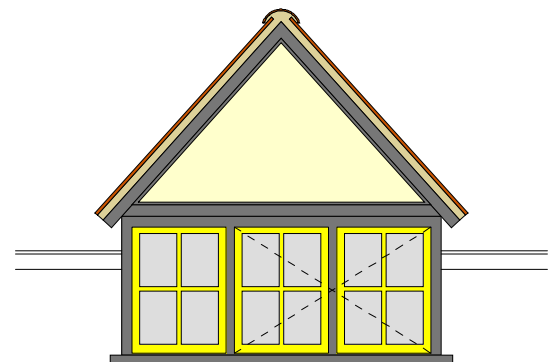
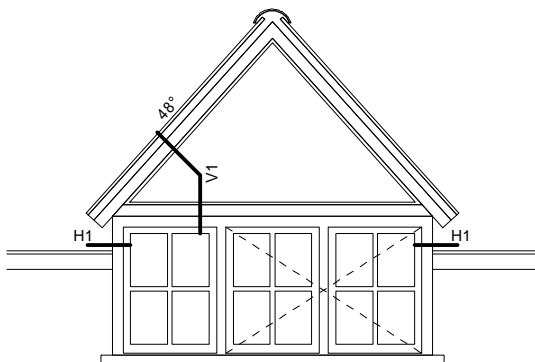

Qb

R

raam F1
fenêtre

detail ref.doc.

aanzicht C.41.01
H1 C.41.21/1
V1 C.41.11/1
V2 C.41.12/1

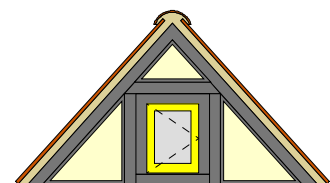
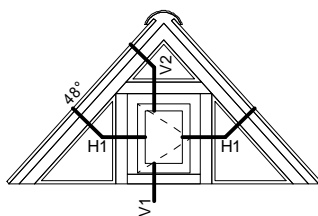

R

Sa

raam O
fenêtre

detail ref.doc.

H1 C.44.21/1
H2 C.44.22/1
V1 C.44.11/1
V2 C.44.12/1

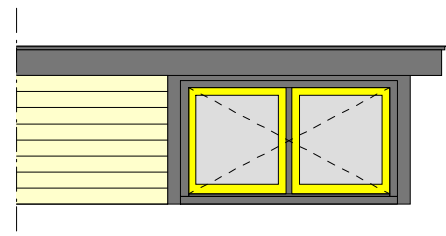
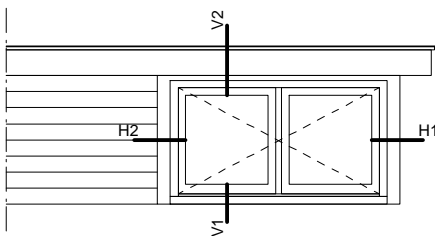

Sa

Sb

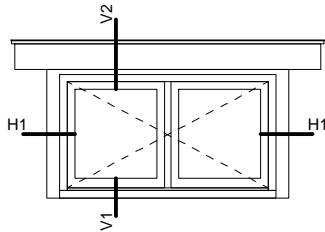

raam
fenêtre ○

detail ref.doc.

H1 C.44.21/1
V1 C.44.11/1
V2 C.44.12/1

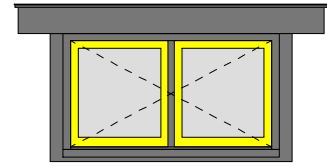

Sb

FrA

raam
fenêtre D2

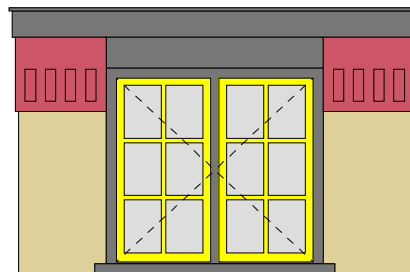
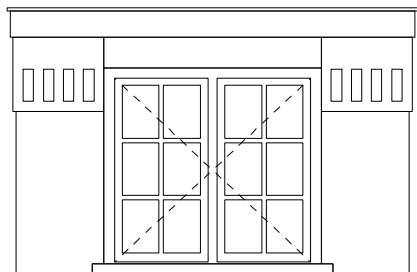

FrA

FrB

raam
fenêtre D3

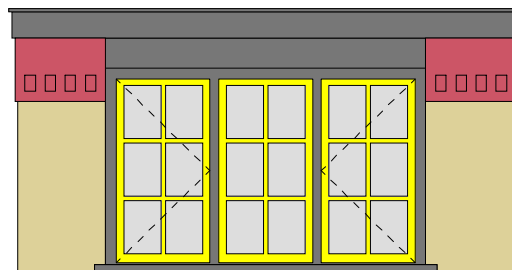
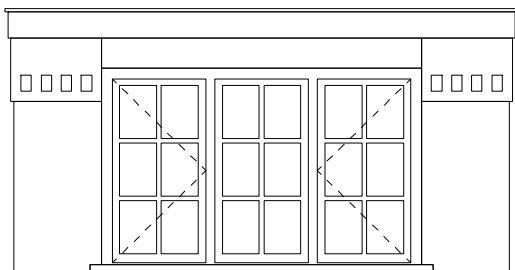

FrB

FrC

raam
fenêtre D2x2

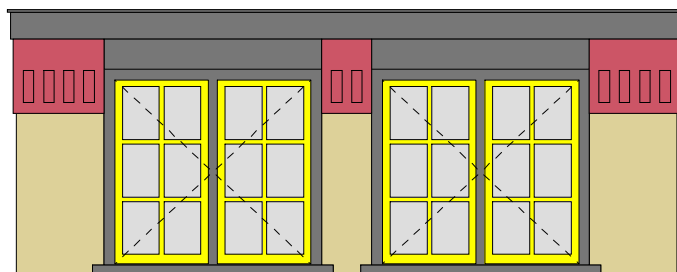
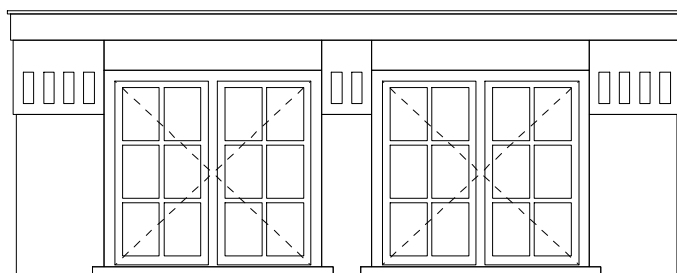

FrC



t: 02 410 84 39
f: 02 410 34 31
e: arsis@arsis.be

■ Noir - zwart
■ Verre - Glas
■ Brique - Baksteen
éch./sch.: 1/50

■ NCS 0070-G90Y: jaune - geel
■ NCS 0030-G70Y: jaune clair - bleek geel
■ Mortier - mortel

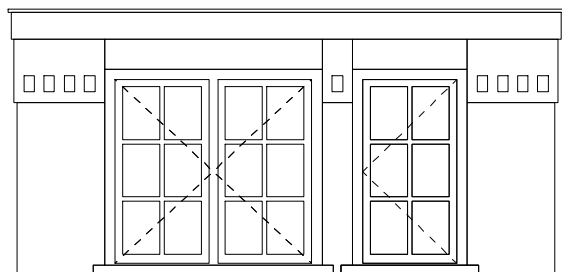

FrD

raam
fenêtre D2+D1

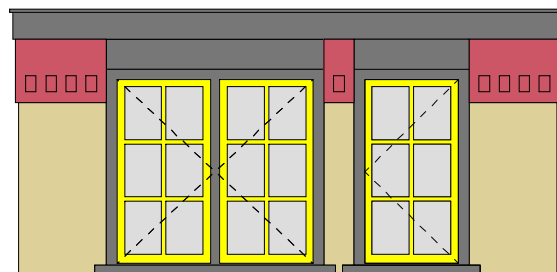

FrD

FrEa

raam
fenêtre F

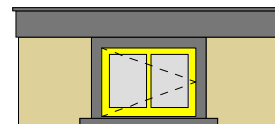
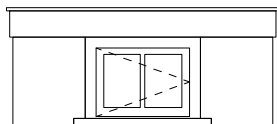

FrEa

FrEb

raam
fenêtre F

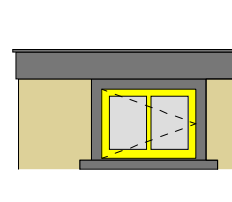
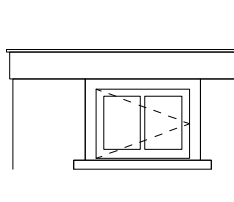

FrEb

FrF

raam
fenêtre F2

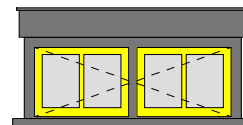
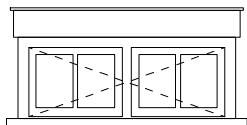

FrF

FrG

raam
fenêtre E3

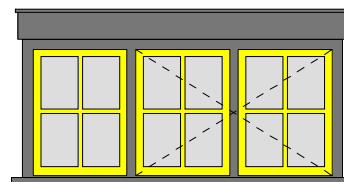
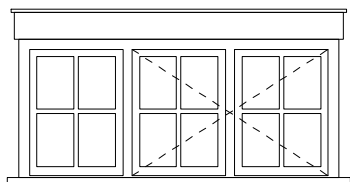

FrG

MoA

raam
fenêtre D2

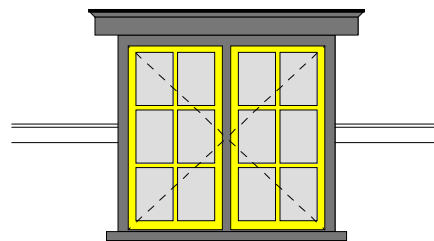
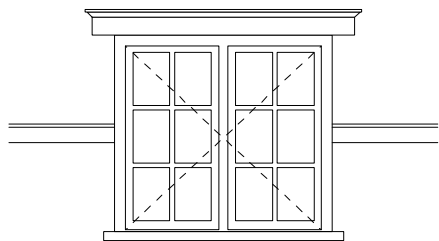

MoA

MoB

raam
fenêtre C2

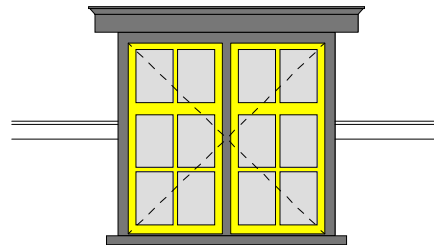
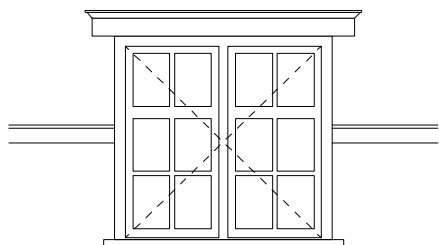

MoB

MoC

raam
fenêtre D3

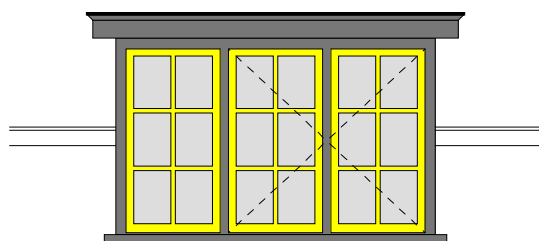
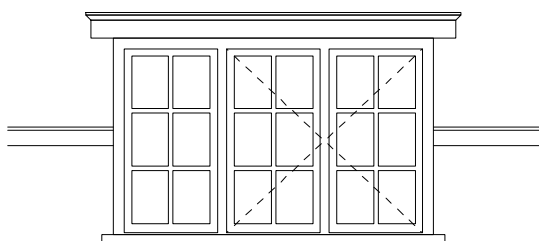

MoC

MoD

raam
fenêtre D4

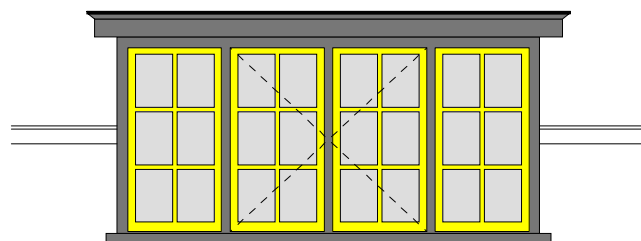
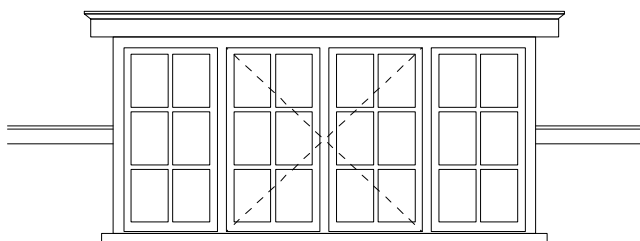

MoD

MoE

raam D3x2
fenêtre

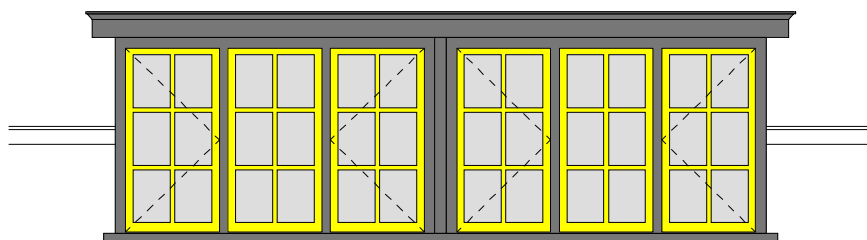
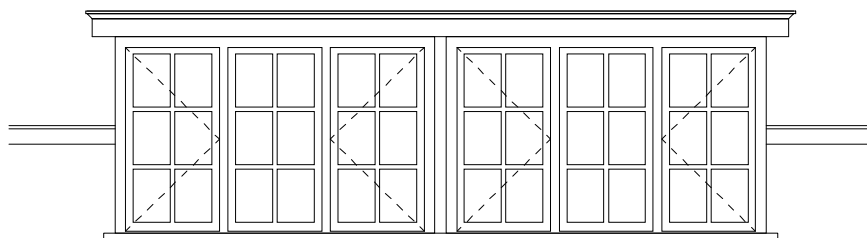

MoE

MoF

raam C3x2
fenêtre

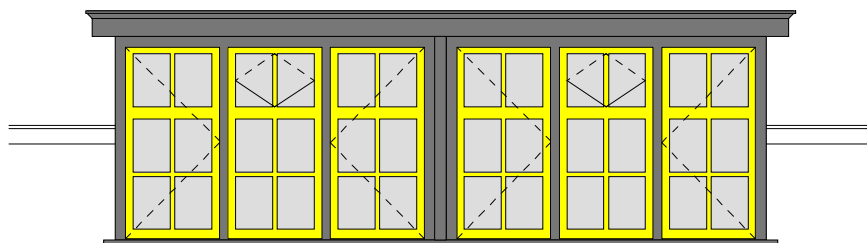
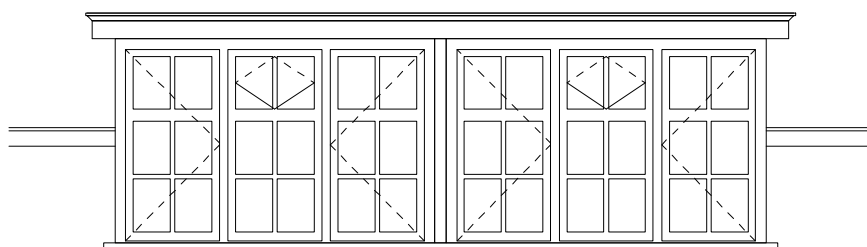

MoF

MoG

raam
fenêtre D2x2

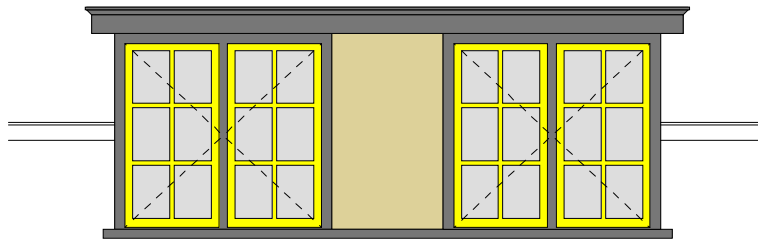
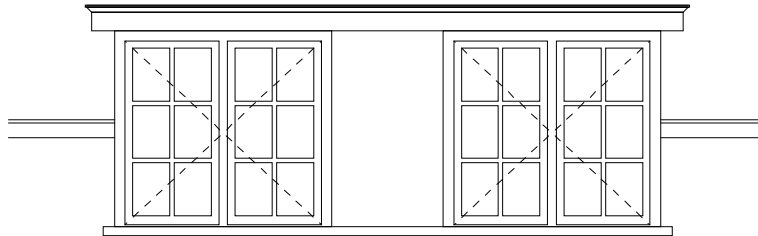

MoG

MoH

raam
fenêtre D2x2

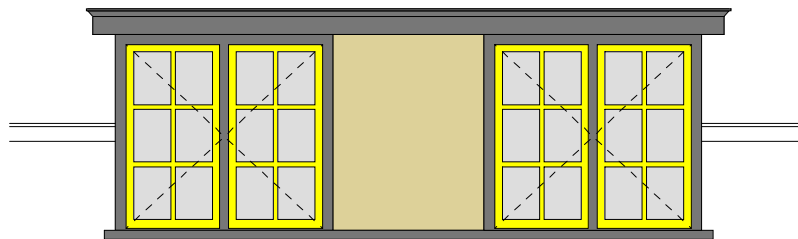
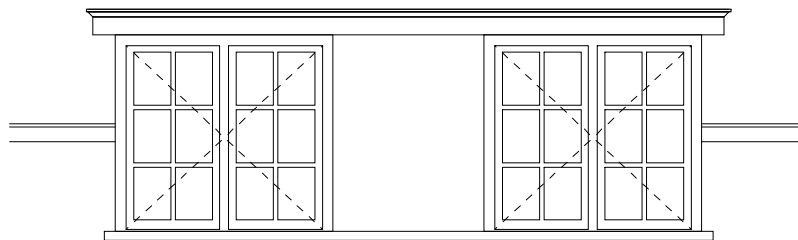

MoH



MoJ

raam
fenêtre D3x2

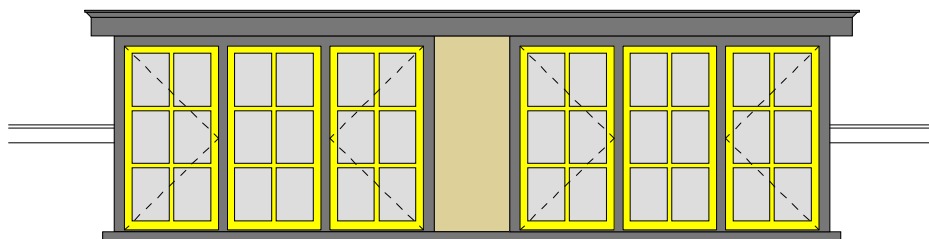
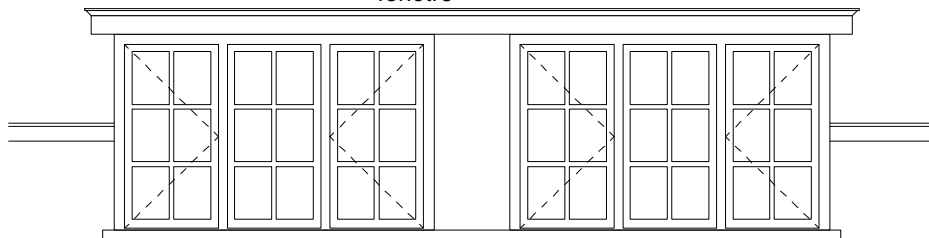

MoJ

MoK

raam
fenêtre D2

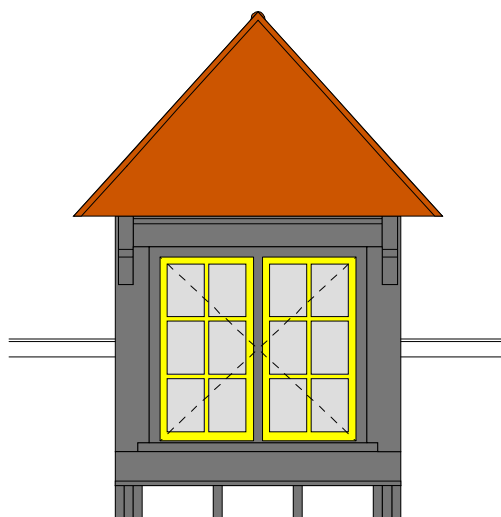
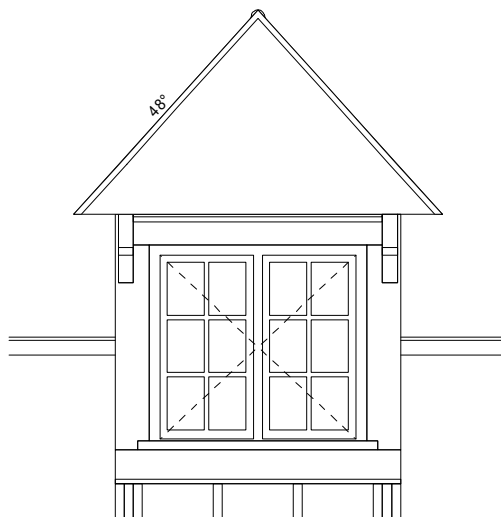

MoL

raam
fenêtre D2x2

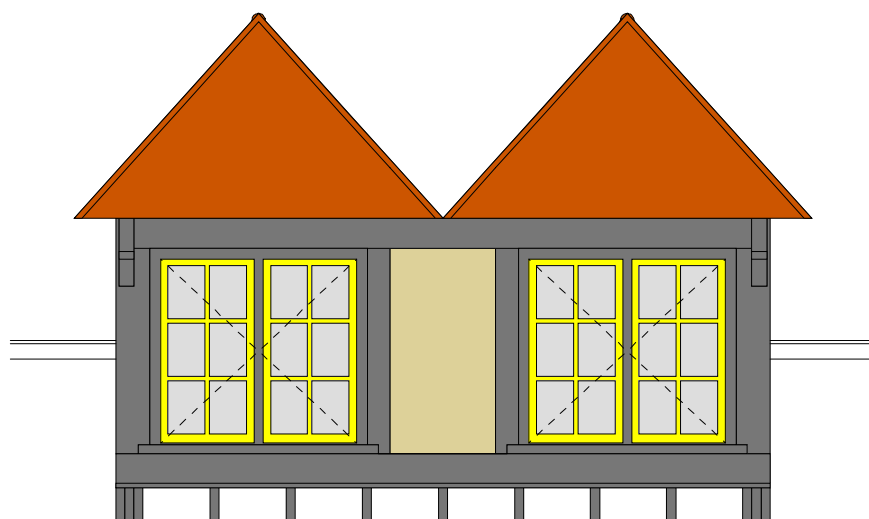

MoM

raam
fenêtre niet standaard

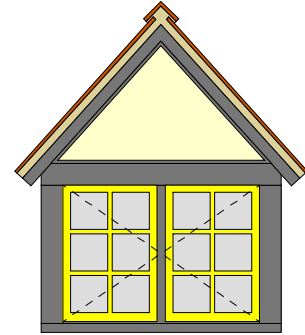
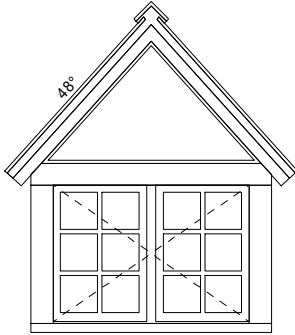

MoM

MoN

raam
fenêtre niet standaard

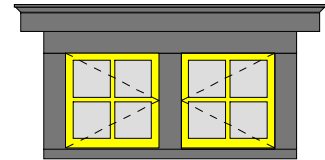
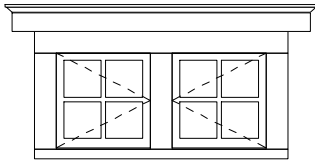

MoN



t: 02 410 84 39
f: 02 410 34 31
e: arsis@arsis.be

■ Noir - zwart
■ Verre - Glas
■ Tuiles - pannen
éch./sch.: 1/50

■ NCS 0070-G90Y: jaune - geel
■ NCS 0030-G70Y: jaune clair - bleek geel
■ Mortier - mortel

LE LOGIS - FLOREAL

LES LUCARNES
MAISONS "BLANCHES"
(LE LOGIS)

DE DAKKAPELLEN
"WITTE" HUIZEN
(LE LOGIS)

P01-07



t: 02 410 84 39
f: 02 410 34 31
e: arsis@arsis.be

Dakkapel

type

Lucarne

p. P01-07/1

H1

raam fenêtre K3

detail ref.doc.

H1 C.43.21
V1 C.43.11
V2 C.43.12

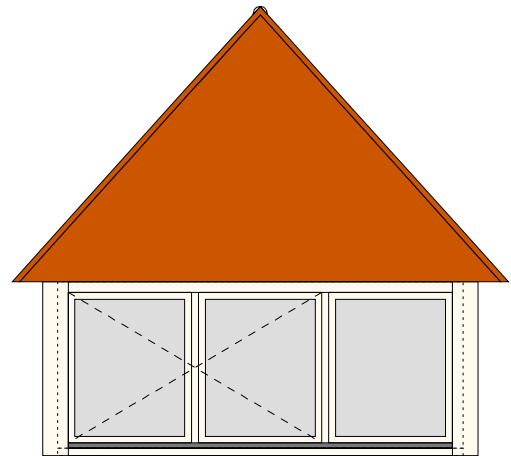
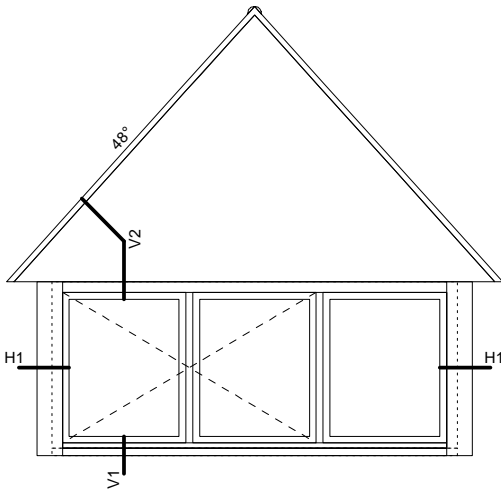

H2

H2

raam fenêtre K2

detail ref.doc.

H1 C.43.21
V1 C.43.11
V2 C.43.12

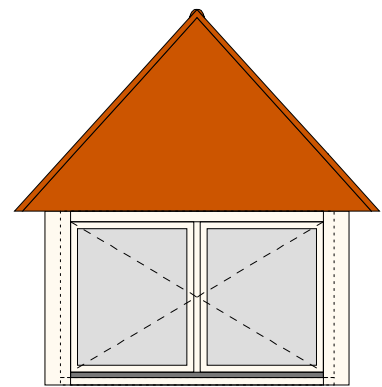
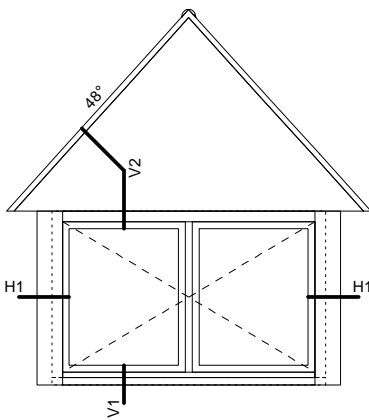

H1

I

raam fenêtre L

detail ref.doc.

H1 C.43.21
V1 C.43.11
V2 C.42.14

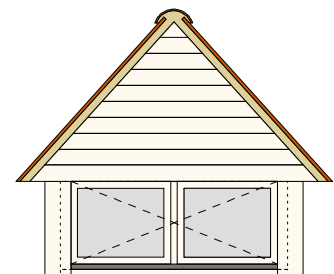
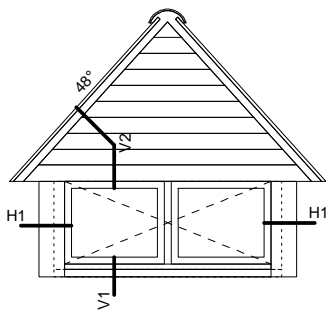

LE LOGIS - FLOREAL

LES VOLETS BATTANTS

DE KLAPLUIKEN

P01-08



t: 02 410 84 39
f: 02 410 34 31
e: arsis@arsis.be

D2

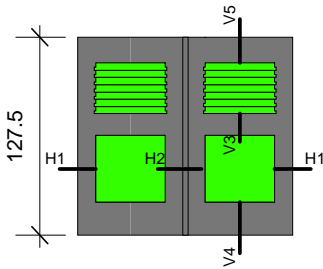

detail	ref.doc.
H1	D.41.01
H2	D.41.02
V3	D.41.04
V4	D.41.04
V5	D.41.04
gén.- alg.	D.41.05

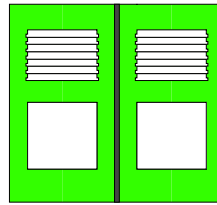

D2

E2

detail	ref.doc.
H1	D.41.01
H2	D.41.02
V1	D.41.04
V2	D.41.04
V3	D.41.04
V4	D.41.04
gén.- alg.	D.41.05

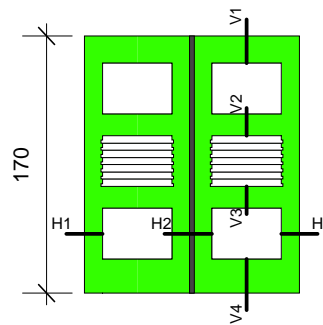

E2

E3

detail	ref.doc.
H1	D.41.01
H2	D.41.02
H3	D.41.03
V1	D.41.04
V2	D.41.04
V3	D.41.04
V4	D.41.04
gén.- alg.	D.41.05

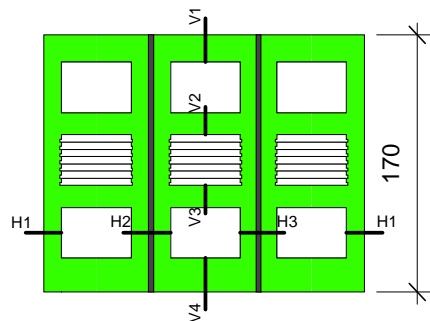

E3

F3

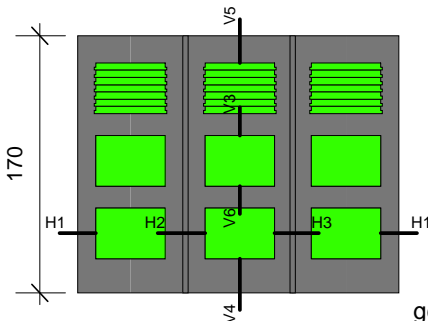

detail	ref.doc.
H1	D.41.01
H2	D.41.02
H3	D.41.03
V3	D.41.04
V4	D.41.04
V5	D.41.04
V6	D.41.04
gén.- alg.	D.41.05

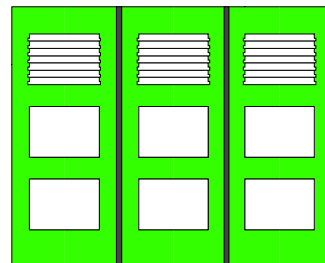

F3

G2

detail ref.doc.

H1	D.41.01
H2	D.41.02
V1	D.41.04
V4	D.41.04
V6	D.41.04
gén.- alg.	D.41.05

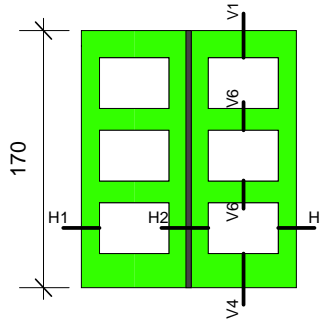

G2

G3

detail ref.doc.

H1	D.41.01
H2	D.41.02
H3	D.41.03
V1	D.41.04
V4	D.41.04
V6	D.41.04
gén.- alg.	D.41.05

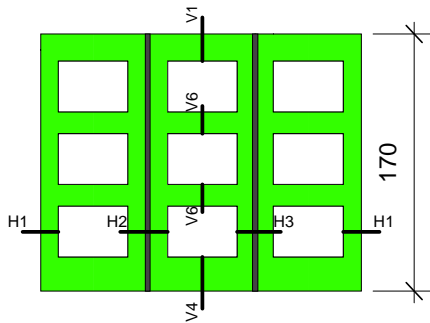

G3

H2

detail ref.doc.

H1	D.41.01
H2	D.41.02
V3	D.41.04
V4	D.41.04
V5	D.41.04
gén.- alg.	D.41.05

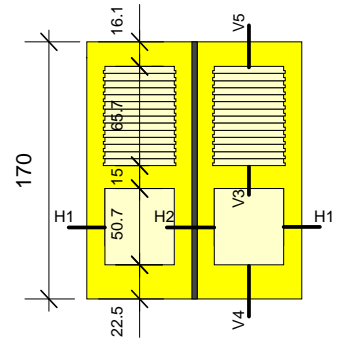

H2

H3

detail ref.doc.

H1	D.41.01
H2	D.41.02
H3	D.41.03
V3	D.41.04
V4	D.41.04
V5	D.41.04
gén.- alg.	D.41.05

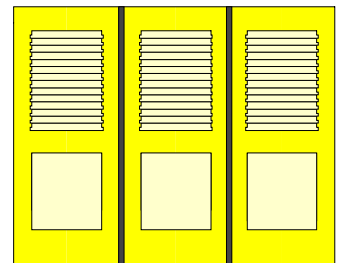
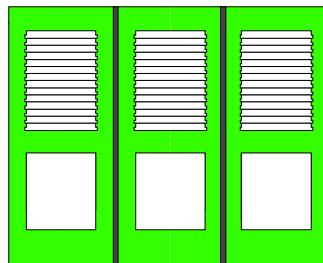
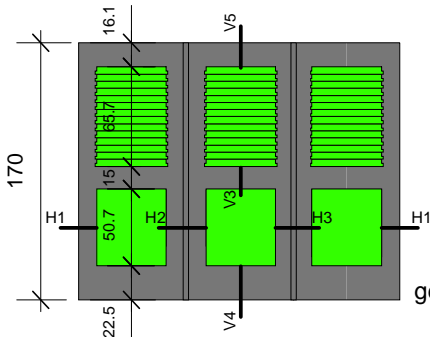

H3

I2

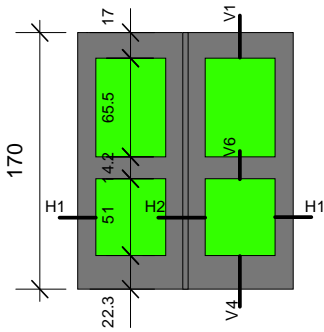

detail	ref.doc.
H1	D.41.01
H2	D.41.02
V1	D.41.04
V4	D.41.04
V6	D.41.04
gén.- alg.	D.41.05

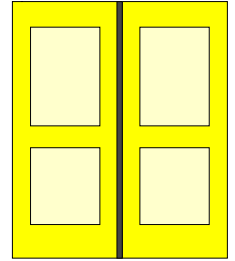
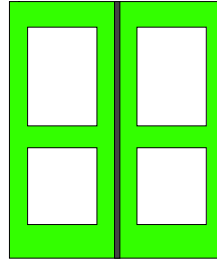

I2

I3

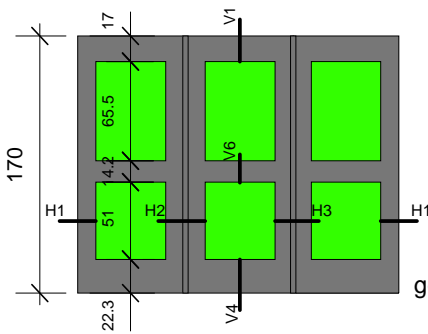

detail	ref.doc.
H1	D.41.01
H2	D.41.02
H3	D.41.03
V1	D.41.04
V4	D.41.04
V6	D.41.04
gén.- alg.	D.41.05

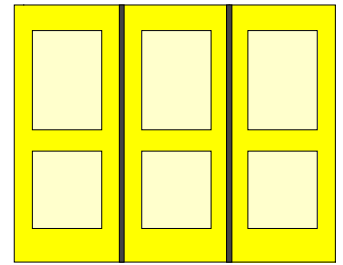
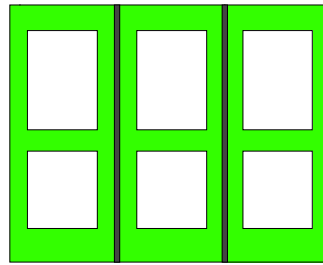

I3

J2

detail	ref.doc.
V5	D.41.04
V7	D.41.04
gén.- alg.	D.41.05

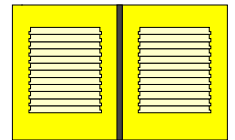
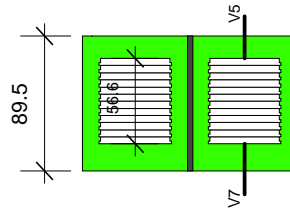

J2

K1

detail	ref.doc.
H1	D.41.01
V1	D.41.04
V4	D.41.04
gén.- alg.	D.41.05

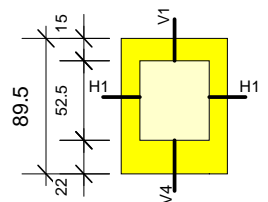

K1

K2

detail ref.doc.

H1	D.41.01
H2	D.41.02
V1	D.41.04
V4	D.41.04
gén.- alg.	D.41.05

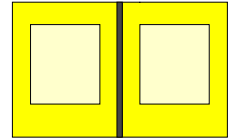
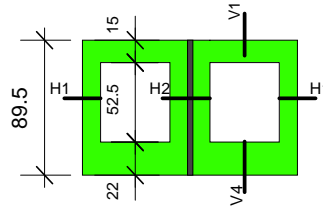

K2

K3

detail ref.doc.

H1	D.41.01
H2	D.41.02
H3	D.41.03
V1	D.41.04
V4	D.41.04
gén.- alg.	D.41.05

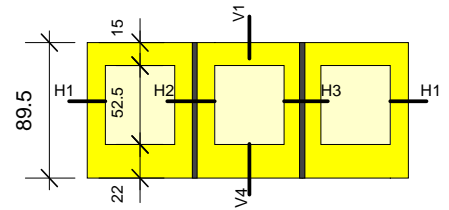

K3

L2

detail ref.doc.

H1	D.41.01
H2	D.41.02
V1	D.41.04
V4	D.41.04
V6	D.41.04
gén.- alg.	D.41.05

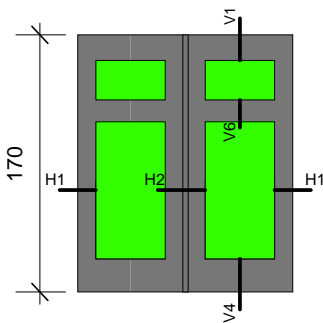

L2

L3

detail ref.doc.

H1	D.41.01
H2	D.41.02
H3	D.41.03
V1	D.41.04
V4	D.41.04
V6	D.41.04
gén.- alg.	D.41.05

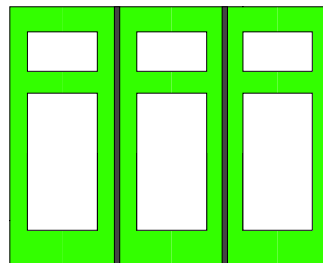
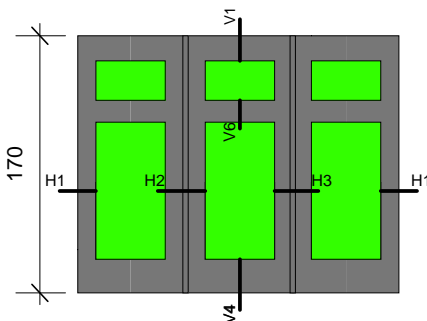

L3

LE LOGIS - FLOREAL

LES PORTES D'ENTREE

DE VOORDEUREN

P01-09



t: 02 410 84 39
f: 02 410 34 31
e: arsis@arsis.be

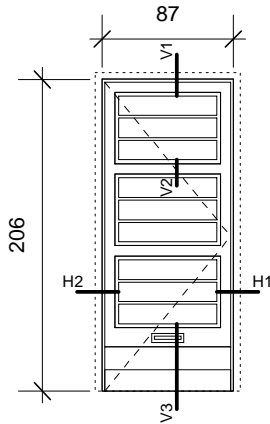

A

detail ref.doc.

vues - aanzichten	D.31.A0 & D.31.A0/1
H1	D.31.A3 & D.31.A3/1
H2	D.31.A4 & D.31.A4/1
V1	D.31.A1 & D.31.A1/1
V2	D.31.A2 & D.31.A2/1
V3	D.31.A5 & D.31.A5/1

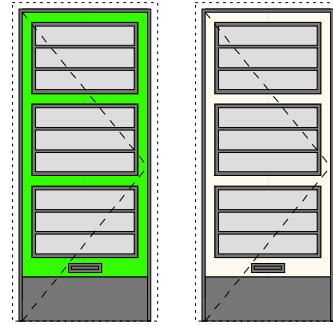

A

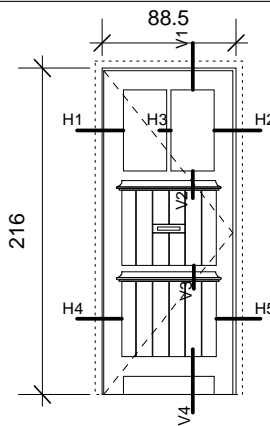

B

detail ref.doc.

H1	D.31.B5
H2	D.31.B8
H3	D.31.B7
H4	D.31.B9
H5	D.31.B10
V1	D.31.B1
V2	D.31.B2
V3	D.31.B3
V4	D.31.B4

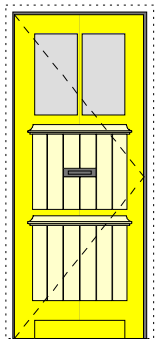
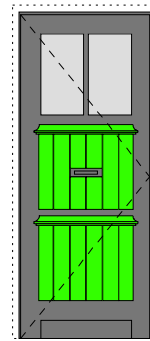

B

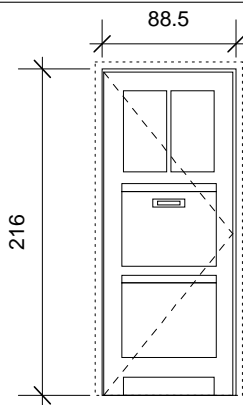

B'

detail ref.doc.

H 0

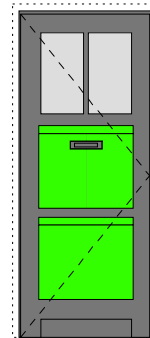

B'

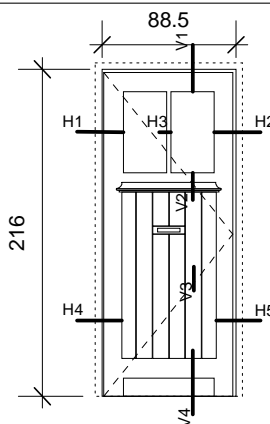

C

detail ref.doc.

H1	D.31.B5
H2	D.31.B8
H3	D.31.B7
H4	D.31.B9
H5	D.31.B10
V1	D.31.B1
V2	D.31.B2
V3	D.31.C1
V4	D.31.B4

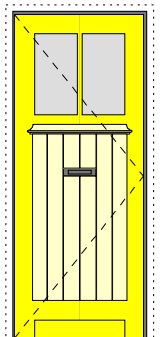
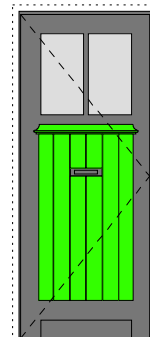

C

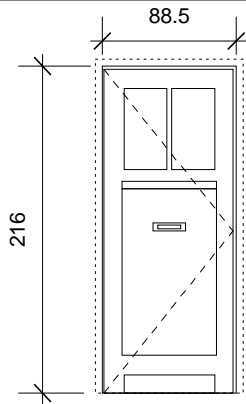

C'
 detail ref.doc.
 H 0

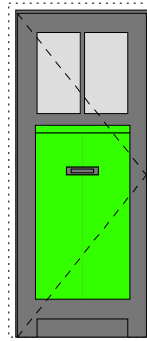

C'

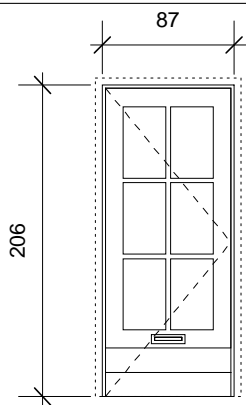

D
 detail ref.doc.
 H 0

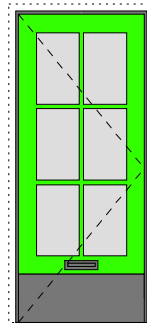

D

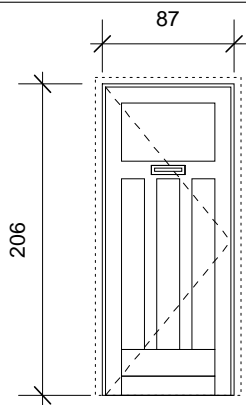

E
 detail ref.doc.
 H 0

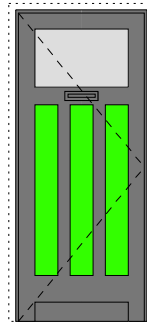

E

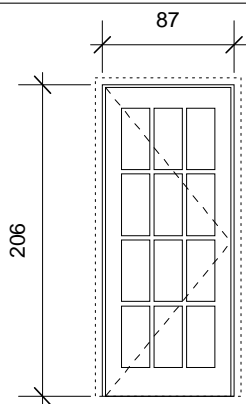

F
 detail ref.doc.
 H 0

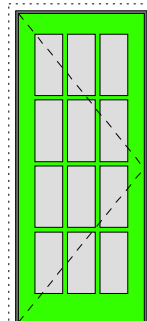

F

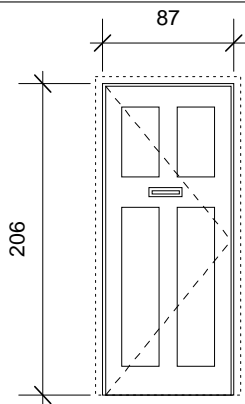

G

detail ref.doc.

H 0

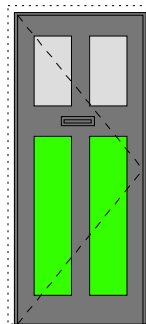

G

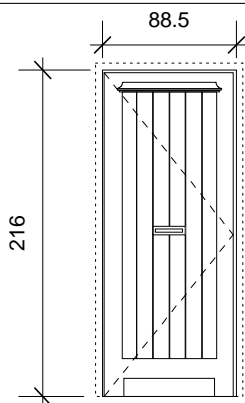

H

detail ref.doc.

H 0

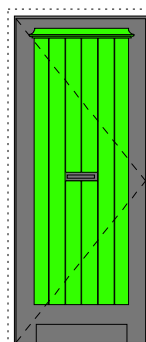

H

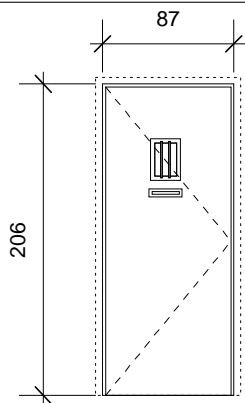

K

detail ref.doc.

H 0

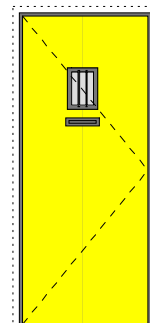
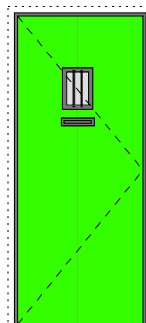

K

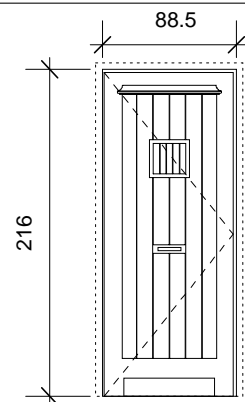

L

detail ref.doc.

H 0

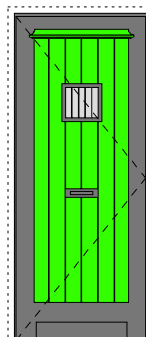

L



t: 02 410 84 39
f: 02 410 34 31
e: arsis@arsis.be

■ Noir - zwart
■ Blanc - Wit
■ Verre - Glas

■ NCS 0070-G90Y: jaune - geel
■ NCS 0030-G70Y: jaune clair - bleek geel
■ NCS 4060-G20Y: vert - groen

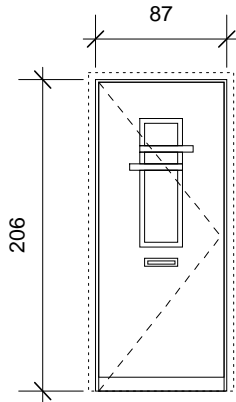

M

detail ref.doc.

H 0

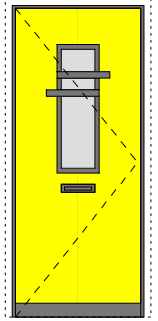

M

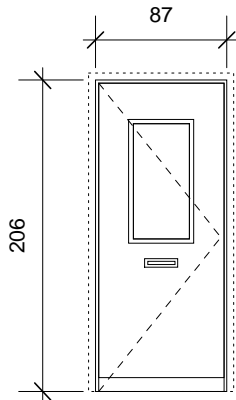

N

detail ref.doc.

H 0

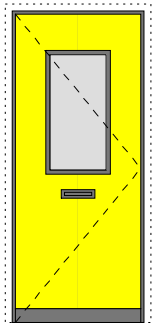
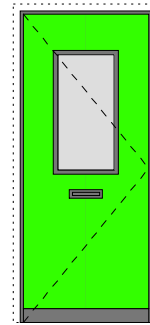

N

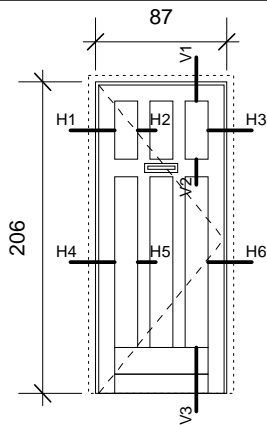

Oa

detail ref.doc.

vues - aanzichten	D.31.0a
H1	D.31.0a1
H2	D.31.0a2
H3	D.31.0a3
H4	D.31.0a4
H5	D.31.0a5
H6	D.31.0a6
V1	D.31.0a7
V2	D.31.0a8
V3	D.31.0a9

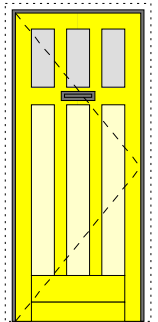

Oa

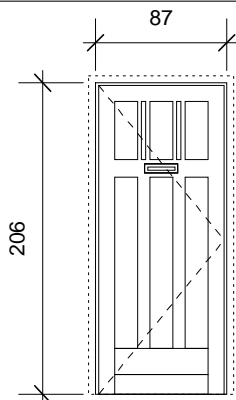

Ob

detail ref.doc.

H 0

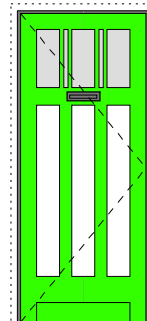

Ob



t: 02 410 84 39
f: 02 410 34 31
e: arsis@arsis.be

■ Noir - zwart
■ Blanc - Wit
■ Verre - Glas

■ NCS 0070-G90Y: jaune - geel
■ NCS 0030-G70Y: jaune clair - bleek geel
■ NCS 4060-G20Y: vert - groen

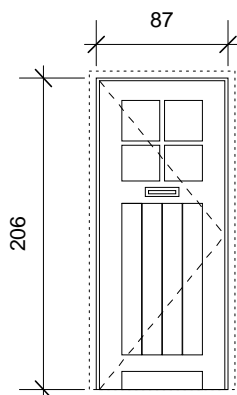

P

detail ref.doc.

H 0

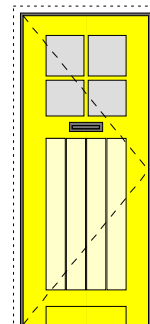
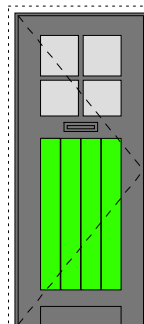

P

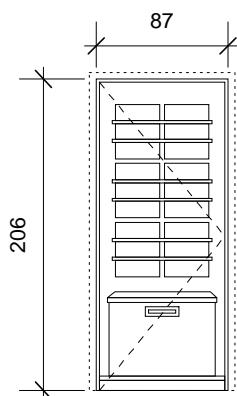

Q

detail ref.doc.

H 0

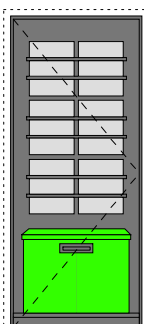

Q

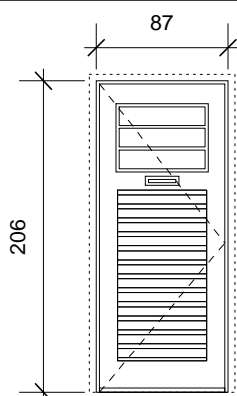

R

detail ref.doc.

H 0

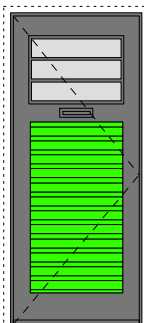

R

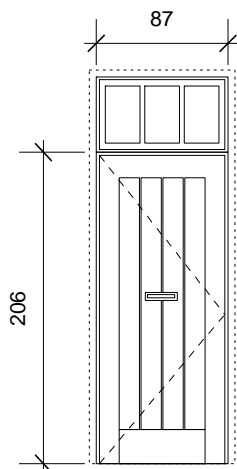

S

detail ref.doc.

H 0

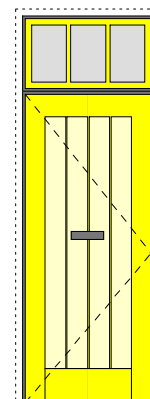

S

Deuren type Portes

p. P01-09/6

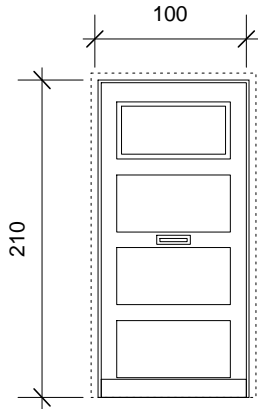

T

detail ref.doc.

H 0

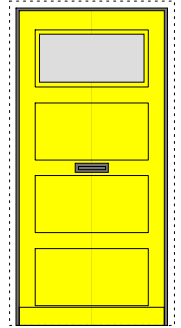

T

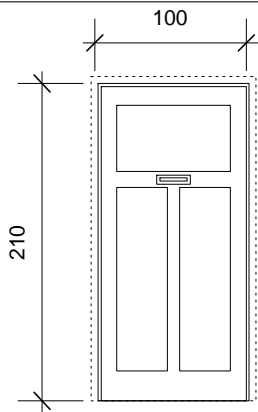

U

detail ref.doc.

H 0

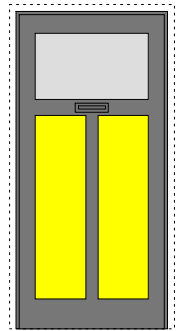

U

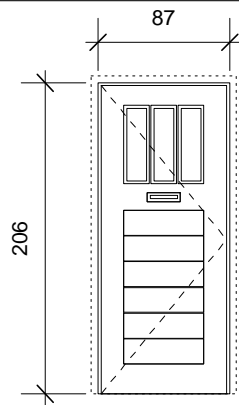

V

detail ref.doc.

H 0

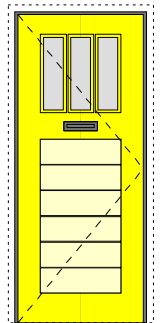

V



t: 02 410 84 39
f: 02 410 34 31
e: arsis@arsis.be

■ Noir - zwart
■ Blanc - Wit
■ Verre - Glas

■ NCS 0070-G90Y: jaune - geel
■ NCS 0030-G70Y: jaune clair - bleek geel
■ NCS 4060-G20Y: vert - groen

LE LOGIS - FLOREAL

LES PORTILLONS

DE TUINPOORTJES

P01-10



t: 02 410 84 39
f: 02 410 34 31
e: arsis@arsis.be

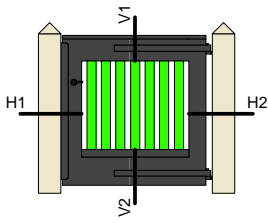

detail	ref.doc.
vues - aanzichten	D.50.00
H1	D.,50.01
H2	D.50.02
V1	D.50.03
V2	D.50.04

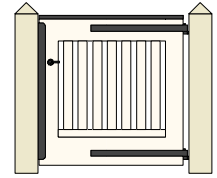
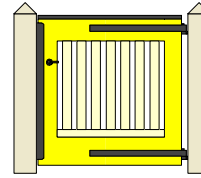

LE LOGIS - FLOREAL

LES AUVENTS

DE LUIFELS

P01-11



t: 02 410 84 39
f: 02 410 34 31
e: arsis@arsis.be

Luifels type Auvents

p. P01-11/1

L2

detail ref.doc.

vues - aanzichten D.61.00
D.63.00
V1 D.61.01
D.63.01

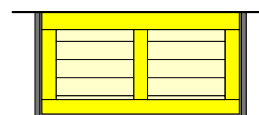
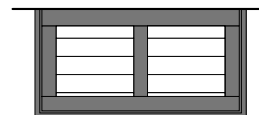
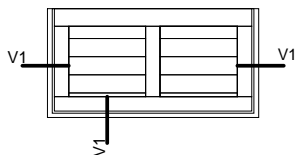

L2

L3

detail ref.doc.

vues - aanzichten D.61.00
D.62.00
D.63.00
V1 D.61.01
D.62.01
D.63.01

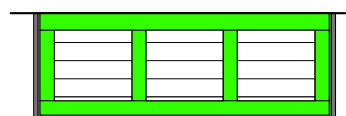
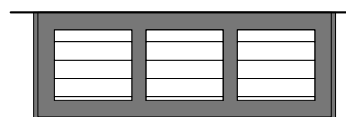
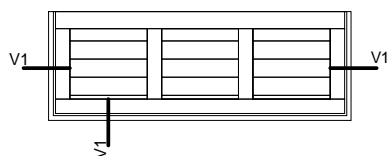

L3

L4

detail ref.doc.

vues - aanzichten D.61.00
D.62.00
D.63.00
V1 D.61.01
D.62.01
D.63.01

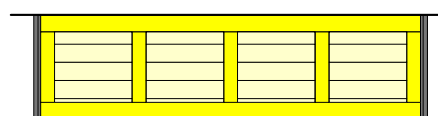
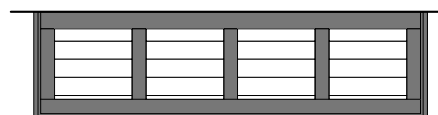
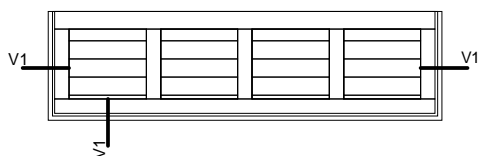

L4

L5

detail ref.doc.

vues - aanzichten D.61.00
D.62.00
D.63.00
V1 D.61.01
D.62.01
D.63.01

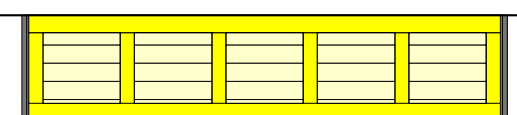
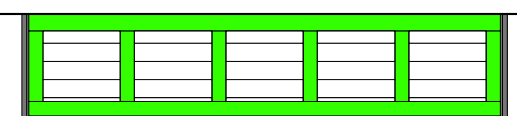
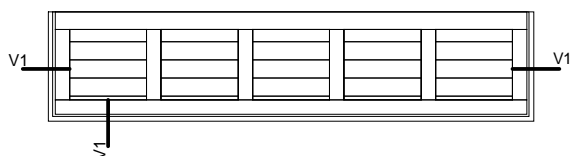

L5

L6

detail ref.doc.

vues - aanzichten

V1

D.61.00
D.62.00
D.63.00
D.61.01
D.62.01
D.63.01

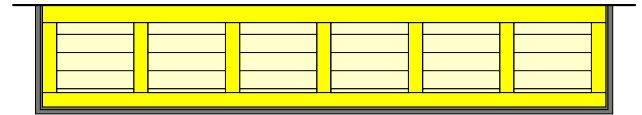
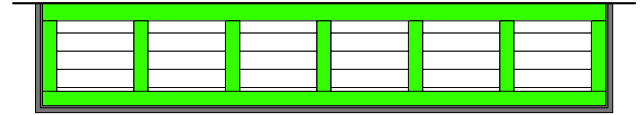
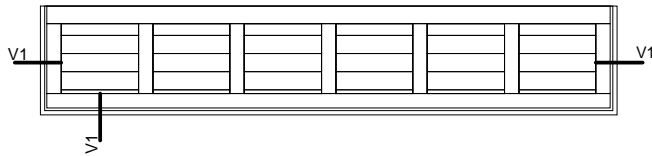

L6

LE LOGIS - FLOREAL

LES PORTES DE GARAGE

DE GARAGEPOORTEN

P01-12



t: 02 410 84 39
f: 02 410 34 31
e: arsis@arsis.be

A

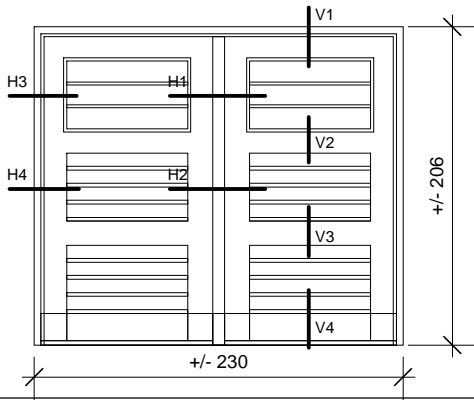

detail ref.doc.

V1	D.71.01
V2	D.71.01
V3	D.71.02
V4	D.71.02
H1	D.71.03
H2	D.71.03
H3	D.71.04
H4	D.71.05

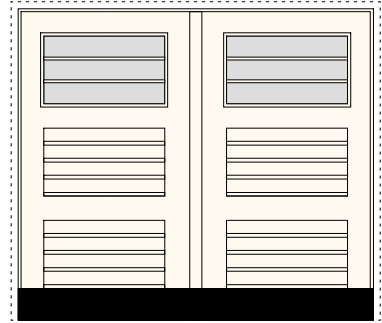

A

B

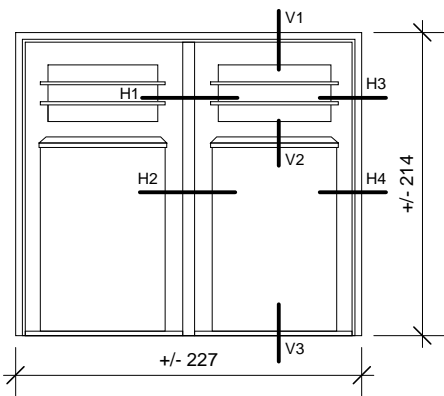

detail ref.doc.

V1	D.72.01
V2	D.72.01
V3	D.72.02
H1	D.72.03
H2	D.72.03
H3	D.72.02
H4	D.72.02

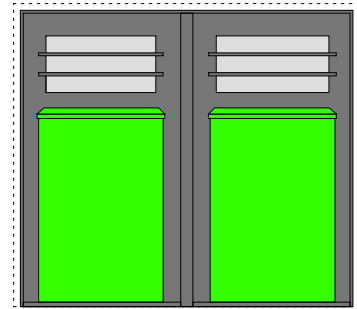

B

C

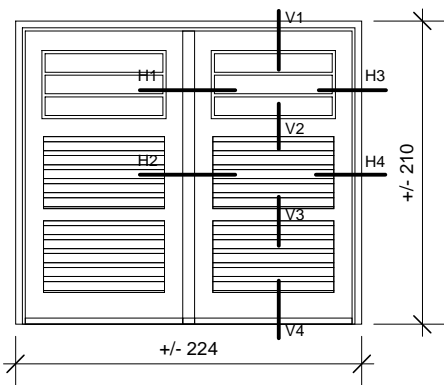

detail ref.doc.

V1	D.73.01
V2	D.73.01
V3	D.73.02
V4	D.73.02
H1	D.73.03
H2	D.73.03
H3	D.73.04
H4	D.73.04



C

D

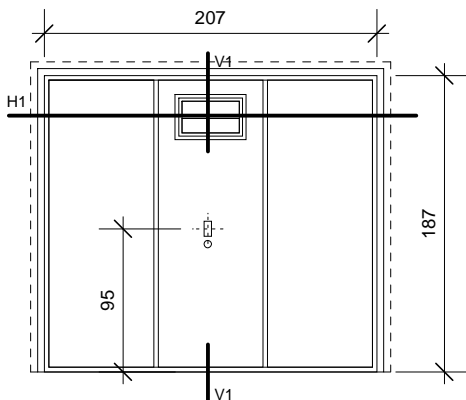

detail ref.doc.

V1	D.74.01
H1	D.74.01

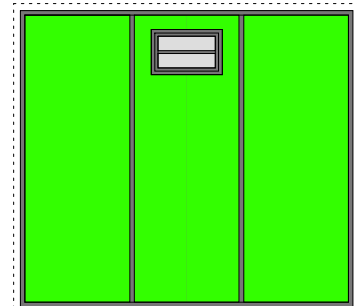

D

LE LOGIS - FLOREAL

LES CHEMINÉES

DE SCHOUWEN

P01-13



t: 02 410 84 39
f: 02 410 34 31
e: arsis@arsis.be

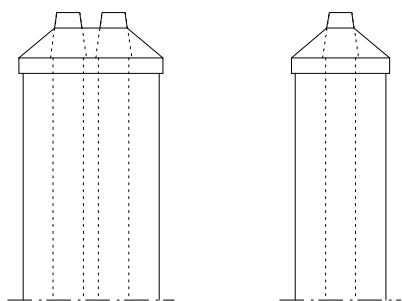

A

detail ref.doc.

H 0

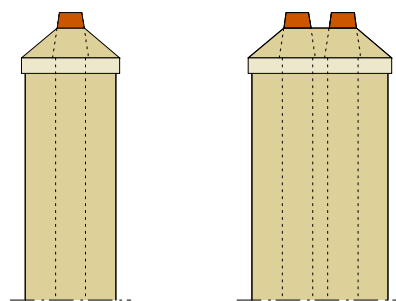

A

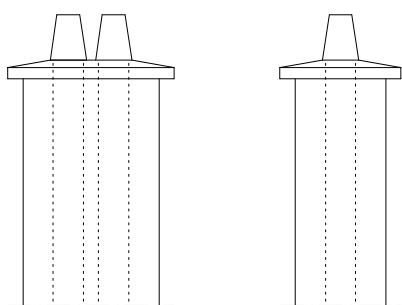

B

detail ref.doc.

H 0

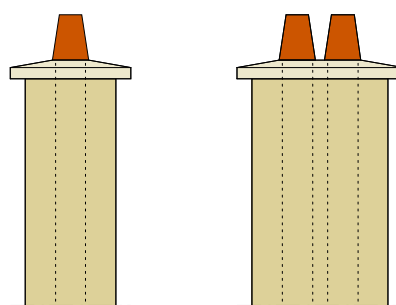

B

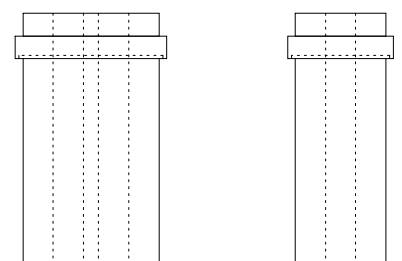

C

detail ref.doc.

H 0

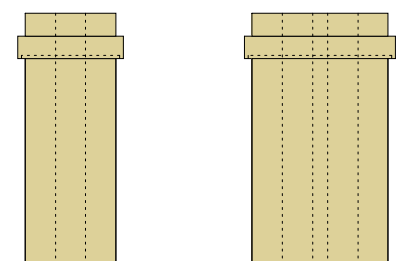

C

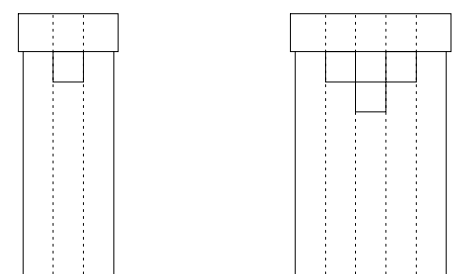

D

detail ref.doc.

H 0

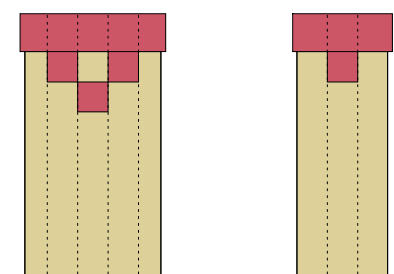

D

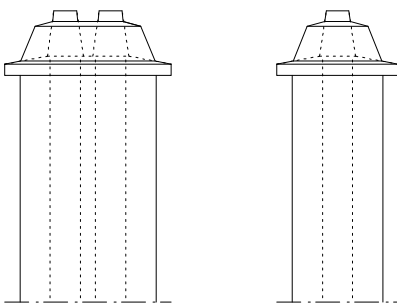

E

detail ref.doc.

H 0

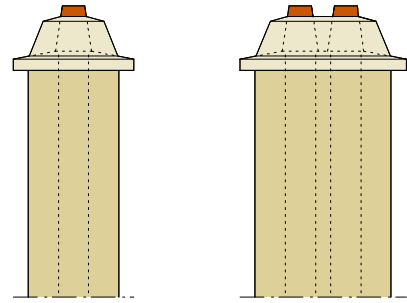

Cette cheminée du type E est un modèle très courant qui n'est pas d'origine, mais vraisemblablement une transformation du type B

Dit frequent voorkomende schouwtype E is een niet oorspronkelijk model, maar waarschijnlijk een verbouwing van het oorspronkelijke model B

E

LE LOGIS – FLOREAL

FERMETURES PORCHES TYPE 1
MAISONS VERTES (LE LOGIS)

*AFSLUITING PORTALEN TYPE 1
GROENE HUIZEN (LE LOGIS)*

P01-14



t: 02 410 84 39
f: 02 410 34 31
e: arsis@arsis.be

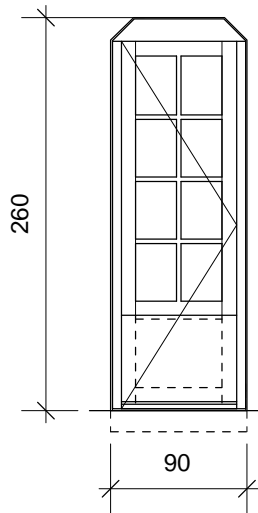

Dimension réelle du jour vitré: 27 x 38 cm
Netto glasopeningen: 27 x 38 cm

1.1

detail ref.doc.

H D.

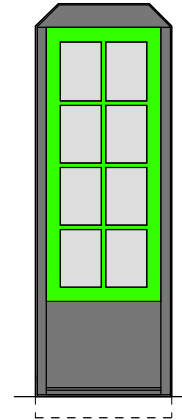

1.1

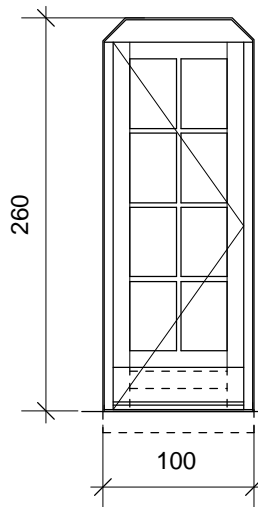

Dimension réelle du jour vitré: 31 x 46 cm
Netto glasopeningen: 31 x 46 cm

1.2

detail ref.doc.

H D.

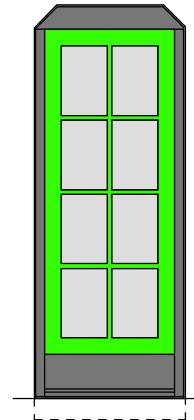

1.2

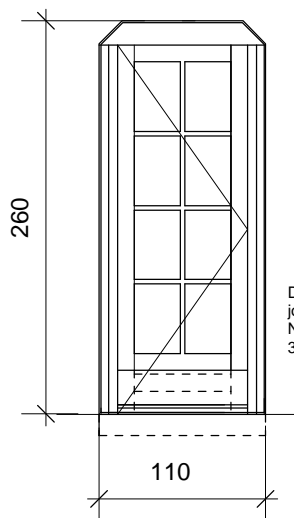

Dimension réelle du jour vitré: 31 x 46 cm
Netto glasopeningen: 31 x 46 cm

1.3

detail ref.doc.

H D.

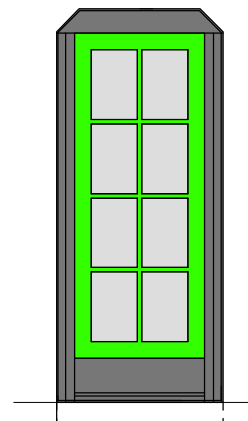

1.3



t: 02 410 84 39
f: 02 410 34 31
e: arsis@arsis.be

■ Noir - zwart
■ Verre - Glas

■ NCS 4060-G2OY: vert - groen

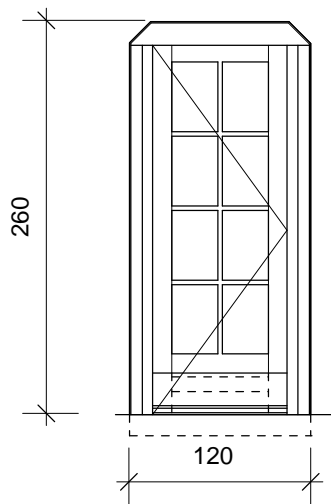

Dimension réelle du jour vitré: 31 x 46 cm
Netto glasopeningen: 31 x 46 cm

1.4

detail ref.doc.

H D.

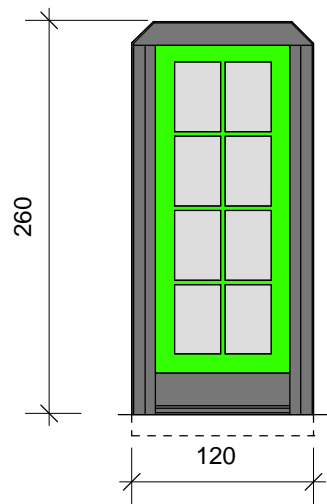

1.4

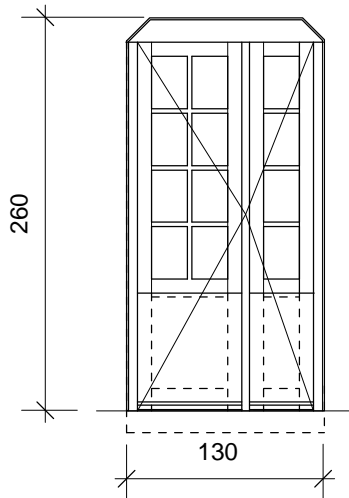

Dimension réelle du jour vitré: 24 x 35 cm
Netto glasopeningen: 24 x 35 cm

1.5

detail ref.doc.

H D.

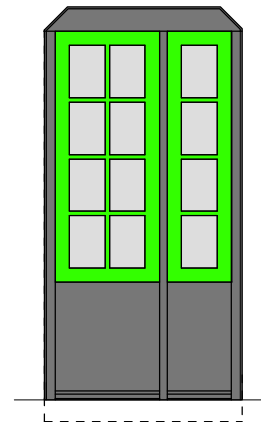

1.5

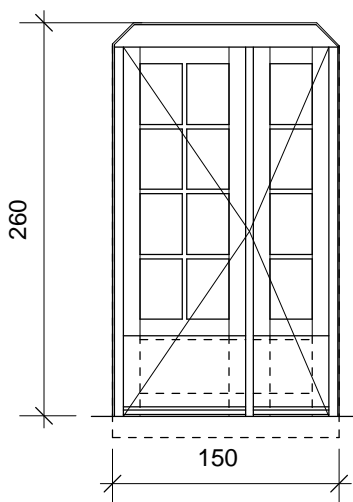

Dimension réelle du jour vitré: 28 x 40 cm
Netto glasopeningen: 28 x 40 cm

1.6

detail ref.doc.

H D.

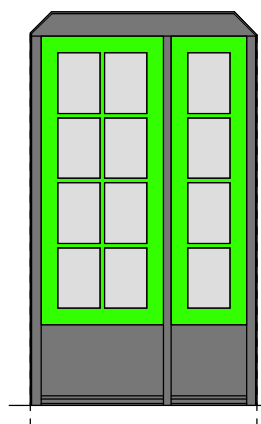

1.6

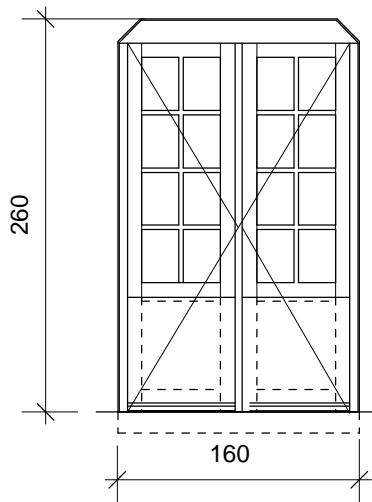

1.7

detail ref.doc.

H D.

Dimension réelle du
jour vitré: 25 x 35 cm
Netto glasopeningen:
25 x 35 cm

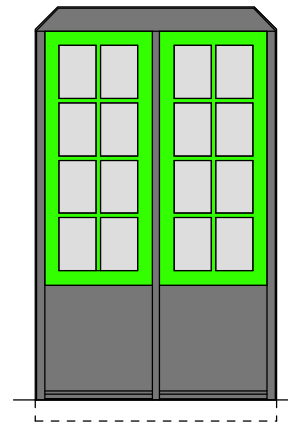

1.7

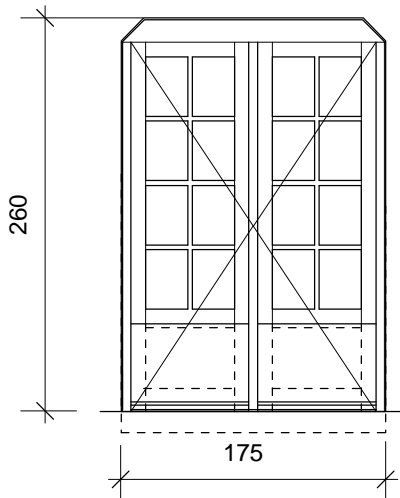

1.8

detail ref.doc.

H D.

Dimension réelle du
jour vitré: 28 x 40 cm
Netto glasopeningen:
28 x 40 cm

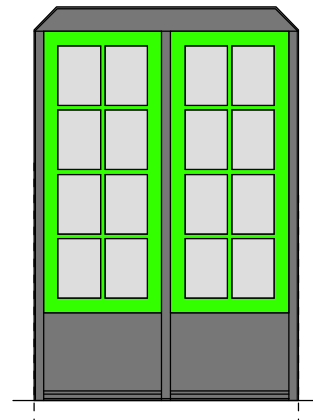

1.8

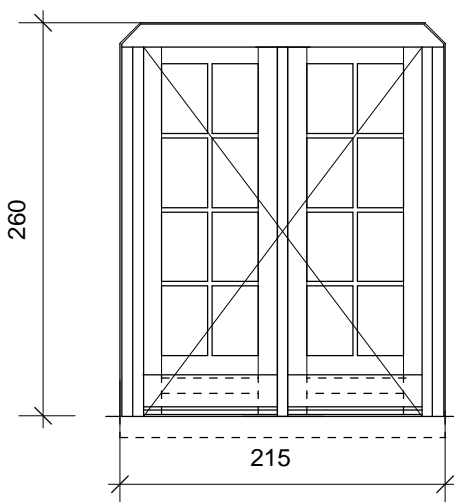

1.9

detail ref.doc.

H D.

Dimension réelle du
jour vitré: 31 x 46 cm
Netto glasopeningen:
31 x 46 cm

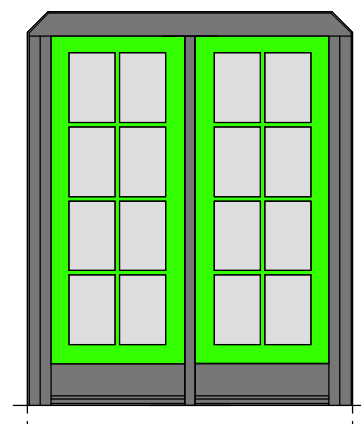

1.9

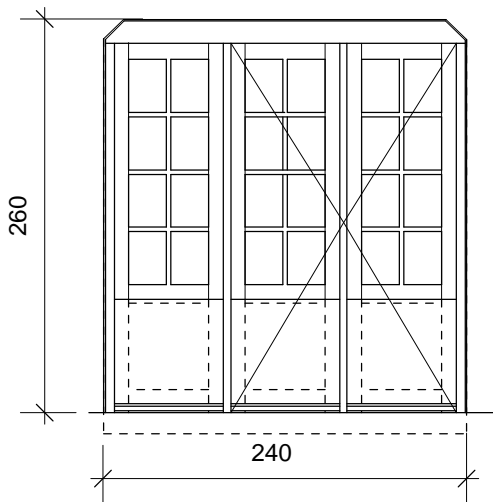

1.10

detail ref.doc.

H D.

Dimension réelle du
jour vitré: 25 x 35 cm
Netto glasopeningen:
25 x 35 cm

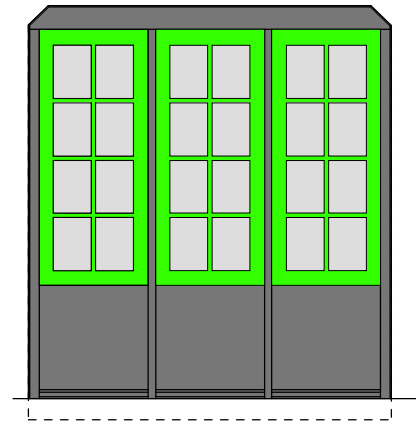

1.10

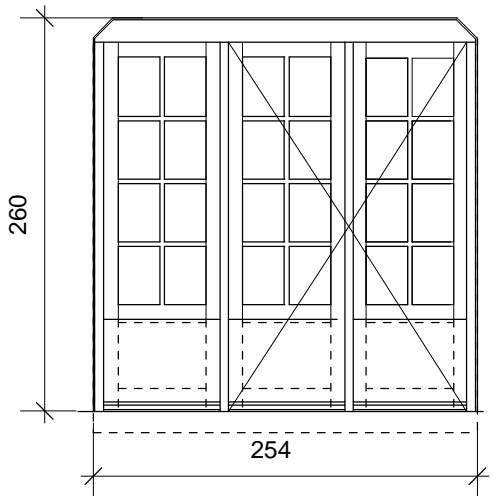

1.11

detail ref.doc.

H D.

Dimension réelle du
jour vitré: 28 x 39 cm
Netto glasopeningen:
28 x 39 cm

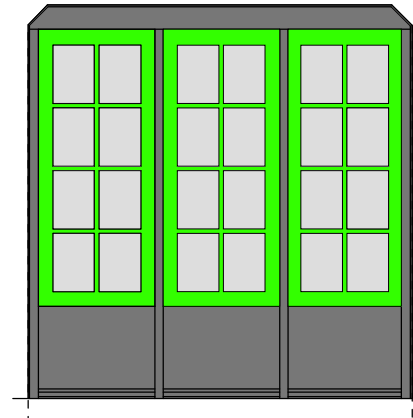

1.11

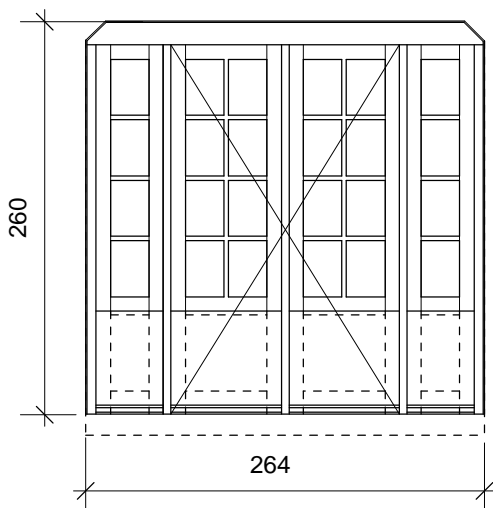

1.12

detail ref.doc.

H D.

Dimension réelle du
jour vitré: 26 x 37 cm
Netto glasopeningen:
26 x 37 cm

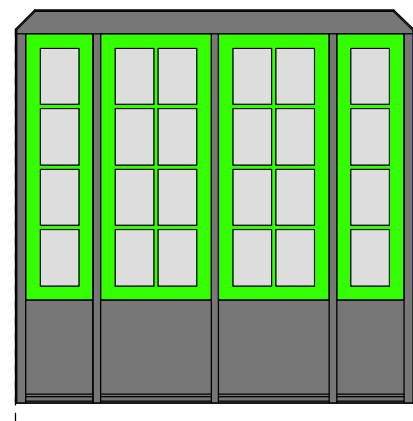

1.12

LE LOGIS - FLOREAL

FERMETURES PORCHES TYPE 1
MAISONS JAUNES (FLOREAL)

*AFSLUITING PORTALEN TYPE 1
GELE HUIZEN (FLOREAL)*

P01-15



t: 02 410 84 39
f: 02 410 34 31
e: arsis@arsis.be

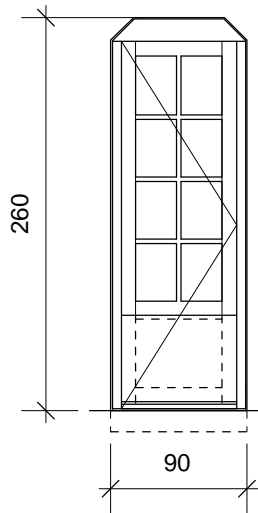

Dimension réelle du jour vitré: 27 x 38 cm
Netto glasopeningen: 27 x 38 cm

1.1

detail ref.doc.

H D.

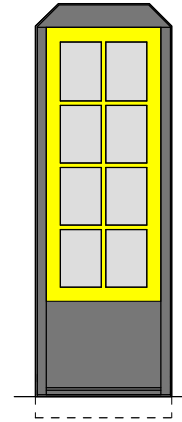

1.1

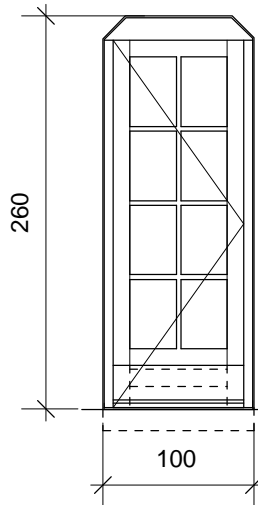

Dimension réelle du jour vitré: 31 x 46 cm
Netto glasopeningen: 31 x 46 cm

1.2

detail ref.doc.

H D.

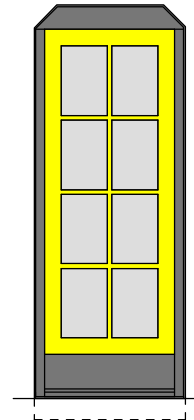

1.2

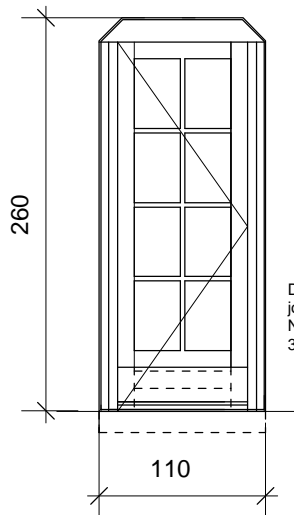

Dimension réelle du jour vitré: 31 x 46 cm
Netto glasopeningen: 31 x 46 cm

1.3

detail ref.doc.

H D.

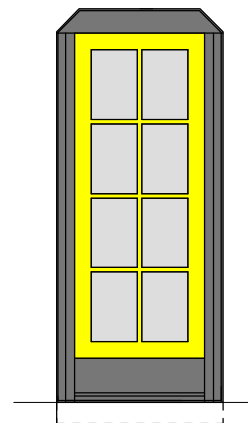

1.3

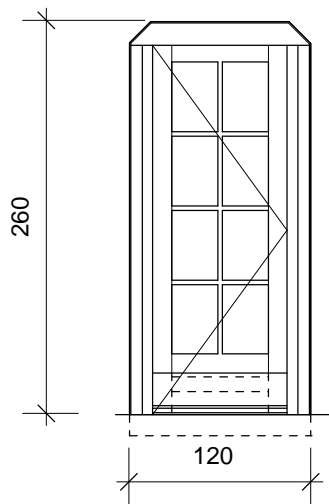

Dimension réelle du jour vitré: 31 x 46 cm
Netto glasopeningen: 31 x 46 cm

1.4

detail ref.doc.

H D.

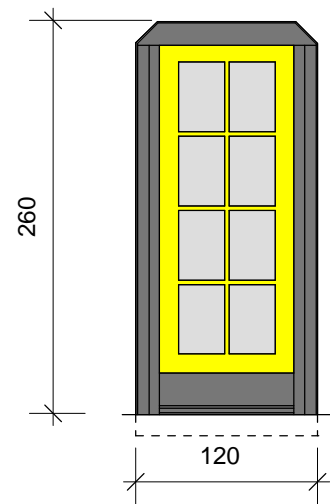

1.4

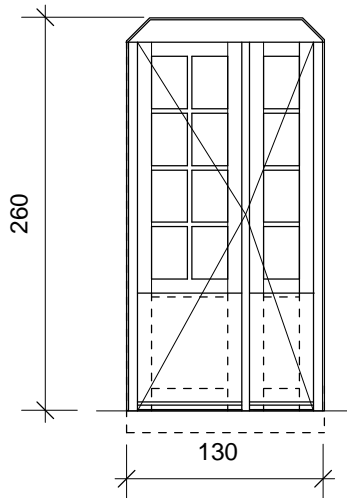

Dimension réelle du jour vitré: 24 x 35 cm
Netto glasopeningen: 24 x 35 cm

1.5

detail ref.doc.

H D.

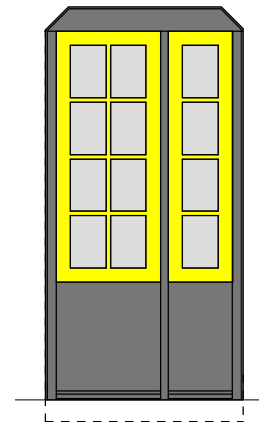

1.5

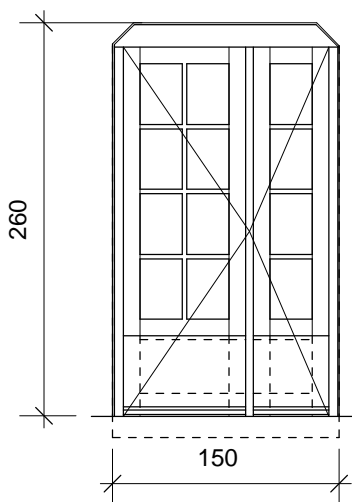

Dimension réelle du jour vitré: 28 x 40 cm
Netto glasopeningen: 28 x 40 cm

1.6

detail ref.doc.

H D.

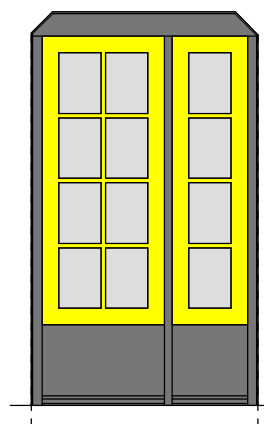

1.6

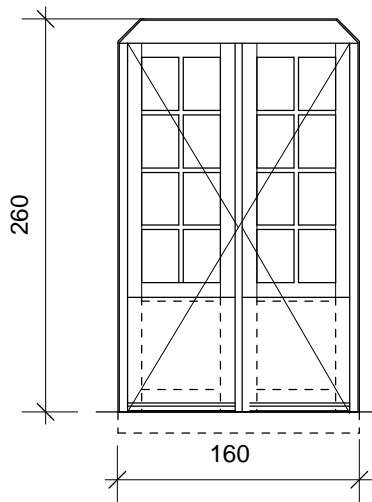

1.7

detail ref.doc.

H D.

Dimension réelle du
jour vitré: 25 x 35 cm
Netto glasopeningen:
25 x 35 cm

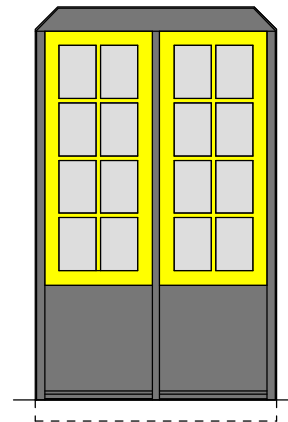

1.7

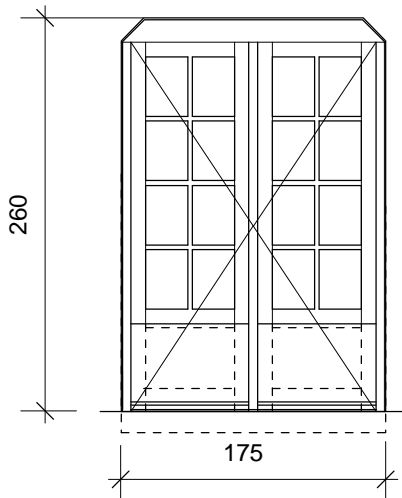

1.8

detail ref.doc.

H D.

Dimension réelle du
jour vitré: 28 x 40 cm
Netto glasopeningen:
28 x 40 cm

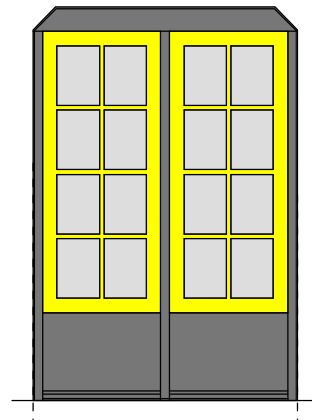

1.8

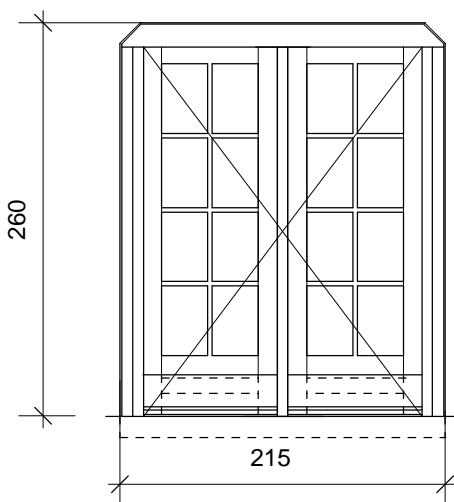

1.9

detail ref.doc.

H D.

Dimension réelle du
jour vitré: 31 x 46 cm
Netto glasopeningen:
31 x 46 cm

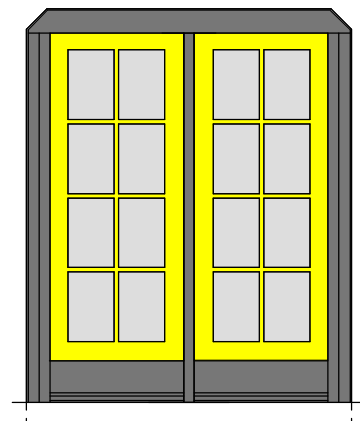

1.9

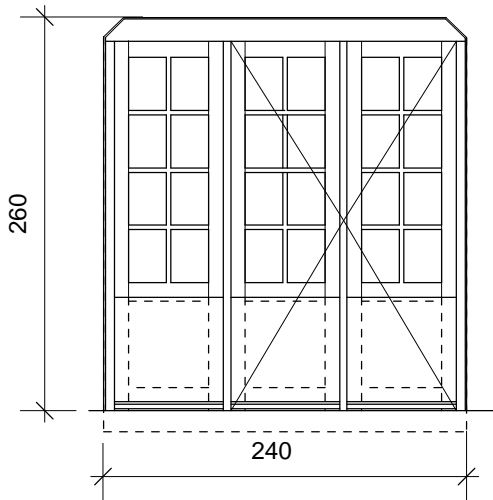

1.10

detail ref.doc.

H D.

Dimension réelle du
jour vitré: 25 x 35 cm
Netto glasopeningen:
25 x 35 cm

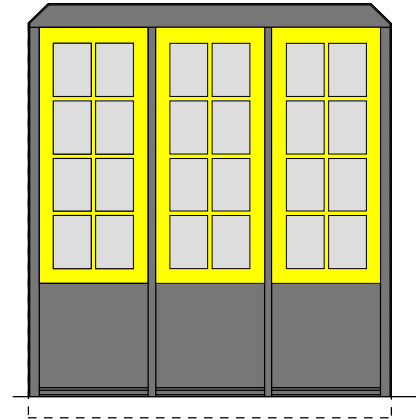

1.10

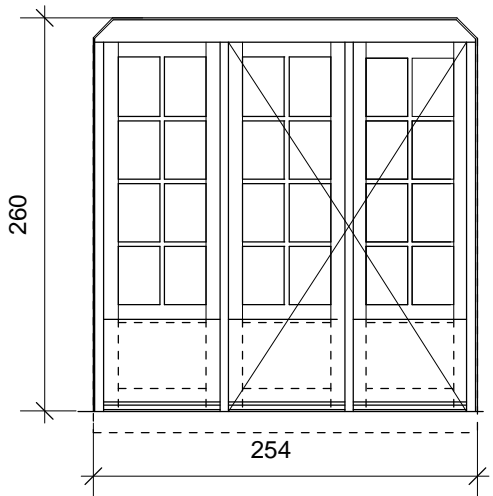

1.11

detail ref.doc.

H D.

Dimension réelle du
jour vitré: 28 x 39 cm
Netto glasopeningen:
28 x 39 cm

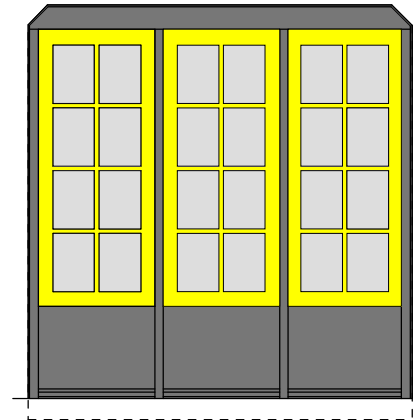

1.11

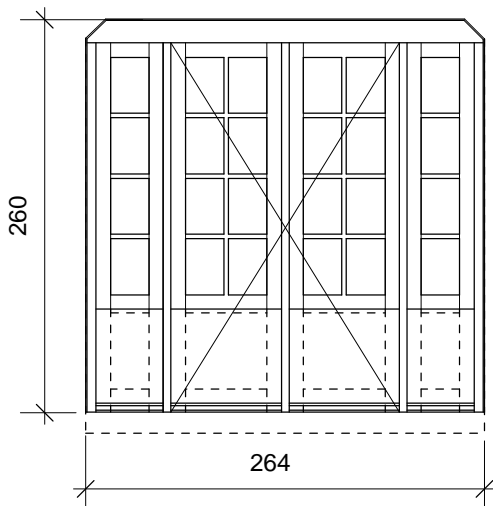

1.12

detail ref.doc.

H D.

Dimension réelle du
jour vitré: 26 x 37 cm
Netto glasopeningen:
26 x 37 cm

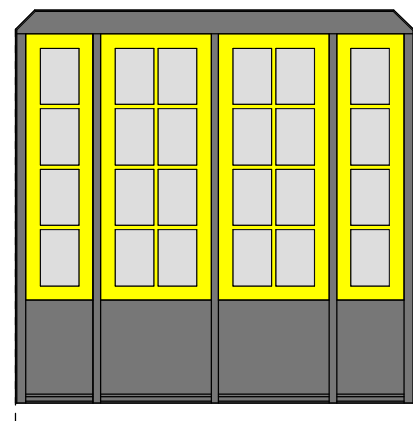

1.12

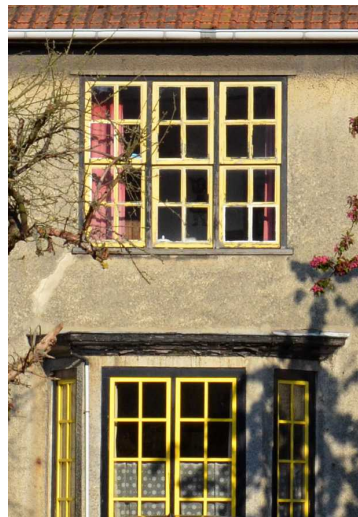
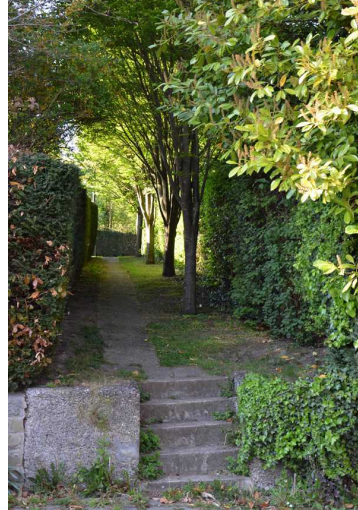

Gewestelijke Overheidsdienst Brussel
Brussel Stedelijke Ontwikkeling
Directie Monumenten en Landschappen

Opgemaakt voor GOB door
ARSIS, architectenvennootschap bvba

Verantwoordelijke uitgever
Arlette Verkruyssen, Directeur-generaal
van Brussel Stedelijke Ontwikkeling,
Brussels Hoofdstedelijk Gewest,
CCN- Vooruitgangsstraat 80, 1035 Brussel

Wettelijk Depot D/2014/6860/025